

Brett Road, E8

£500,000

A two bedroom flat within a Victorian mansion-style block in a central E8 location. Renovated throughout by its current owners this top floor property has a modern bathroom, separate kitchen, dining room and south facing aspect. It is being sold chain free.

Brett Road is located off Amhurst Road, only 500 ft from Hackney Central Station with direct access to Stratford and links to Liverpool Street Station via Hackney Downs. The many cafés, restaurants, markets and bars along Mare Street, Broadway Market and Wilton Way are on your doorstep. Hackney Downs Park and London Fields are also both within walking distance.

Features

- Two Double Bedrooms
- Top Floor
- Recently Renovated
- Mansion Block
- Close To Transport
- Chain Free

Brett Road, London, E8

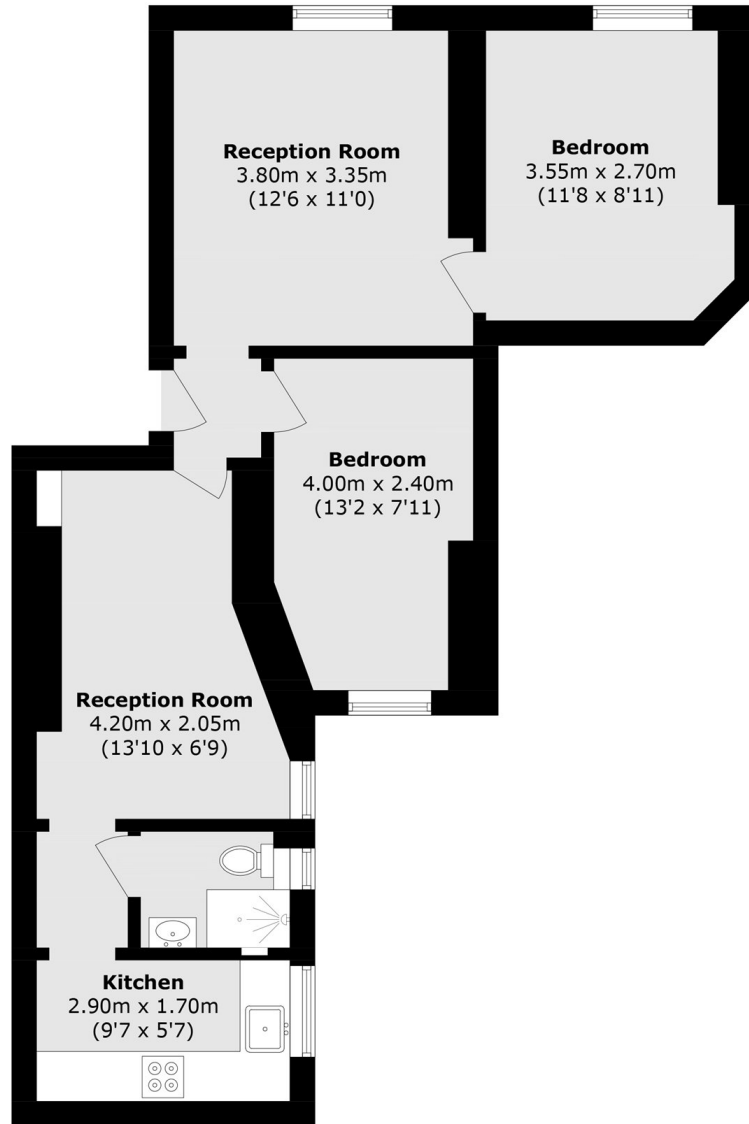

Total area (approx.): 59.0 sq. m (635.1 sq. ft)