



Shad Thames, SE1

£375,000

Situated within this charming converted Victorian Warehouse, this immaculately presented studio flat boasts a large living space, modern kitchen and bathroom, ample storage, secure allocated parking and porter facilities.

St Saviours Wharf is enviably located, with a plethora of riverside restaurants, independent cafés, and artisan delis on your doorstep, along with Tower Bridge, the City, Borough Market, Bermondsey Street, and Maltby Street Market.

Features

- Studio Apartment
- Fantastic Condition
- Warehouse Conversion
- Porter
- Share Of Freehold
- Secure Allocated Parking

Shad Thames, London, SE1

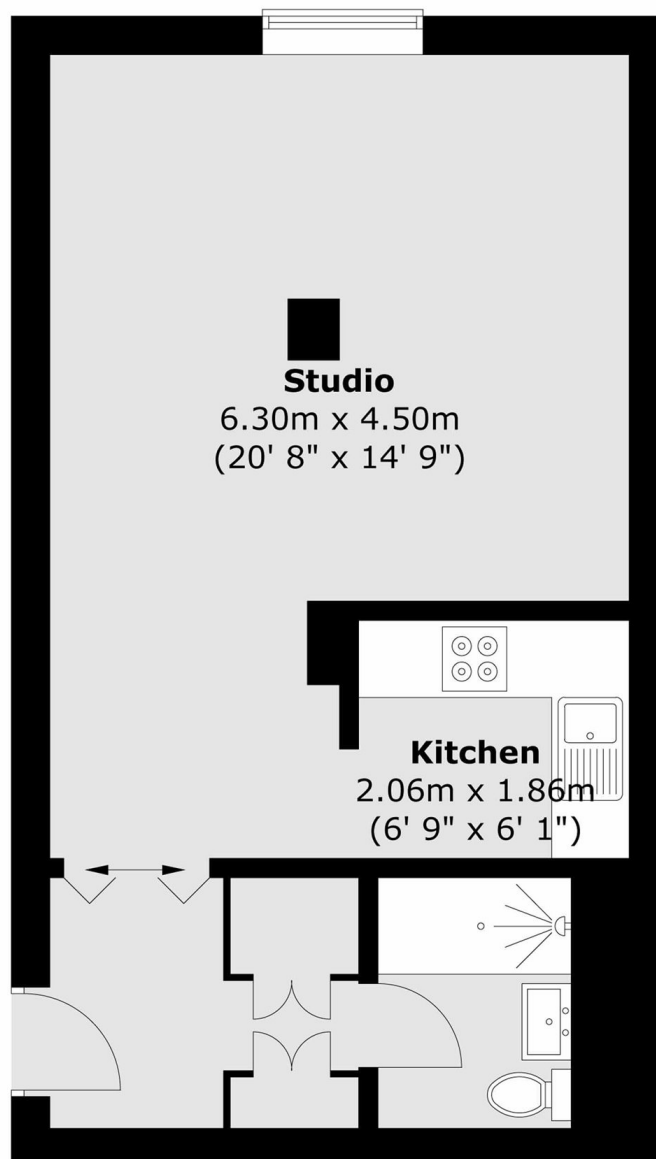

Total area (approx.) : 37.7 sq. m (406 sq. ft)