



www.chrystals.co.im

54 Birch Hill Close, Onchan, IM3 3DH
Asking Price £457,000

54 Birch Hill Close, Onchan, IM3 3DH

Asking Price £457,000

Immaculately maintained three-bedroom detached true bungalow occupying a highly sought-after corner position, this home offers comfortable single-storey living in a tranquil, well-connected setting. The property is framed by meticulously landscaped gardens that provide year-round curb appeal and a private, low-maintenance outdoor space. Inside, you'll find a practical, well-proportioned layout designed for easy living, with an attached single garage and a generous driveway ensuring convenient off-street parking. A perfect blend of ease, style, and location, this bungalow is ideal for downsizers, small families, or anyone seeking a peaceful home in a coveted corner plot.



LOCATION

Travel along Governors Road towards Onchan and left onto Avondale Road. Continue up along Hillberry Road, follow the road round and turn right, into Birch Hill Crescent, continue past Birch Hill Stores and take the next right, into Birch Hill Close, where number fifty four can be found as the first property on the left hand side, clearly identified by our For Sale board.

PORCH

5' 11" x 3' 11" (1.8m x 1.2m)

HALL

5' 11" x 8' 2" (1.8m x 2.5m)

BATHROOM

6' 7" x 9' 2" (2m x 2.8m)

BEDROOM

12' 6" x 12' 10" (3.8m x 3.9m)

BEDROOM

12' 6" x 15' 1" (3.8m x 4.6m)

BEDROOM

13' 1" x 11' 10" (4m x 3.6m)

LIVING ROOM

13' 9" x 22' 4" (4.2m x 6.8m)

DINING AREA

9' 10" x 10' 2" (3m x 3.1m)

KITCHEN

9' 6" x 16' 5" (2.9m x 5m)

UTILITY

13' 5" x 6' 7" (4.1m x 2m)

OFFICE

9' 6" x 12' 10" (2.9m x 3.9m)

SINGLE GARAGE

9' 2" x 13' 8" (2.8m x 4.2m)

OUTSIDE

Block paved driveway leading to garage. Hedge boundary with small grassed area to front. Low maintenance areas to side and rear with paving and gravelled areas.

SERVICES

Mains water, electricity and drainage. Gas central heating.

VIEWING

Viewing is strictly by appointment through CHRYSTALS. Please inform us if you are unable to keep appointments.

POSSESSION

Vacant possession on completion of purchase. The company do not hold themselves responsible for any expenses which may be incurred in visiting the same should it prove unsuitable or have been let, sold or withdrawn. DISCLAIMER - Notice is hereby given that these

particulars, although believed to be correct do not form part of an offer or a contract. Neither the Vendor nor Chrystals, nor any person in their employment, makes or has the authority to make any representation or warranty in relation to the property. The Agents whilst endeavouring to ensure complete accuracy, cannot accept liability for any error or errors in the particulars stated, and a prospective purchaser should rely upon his or her own enquiries and inspection. All Statements contained in these particulars as to this property are made without responsibility on the part of Chrystals or the vendors or lessors.







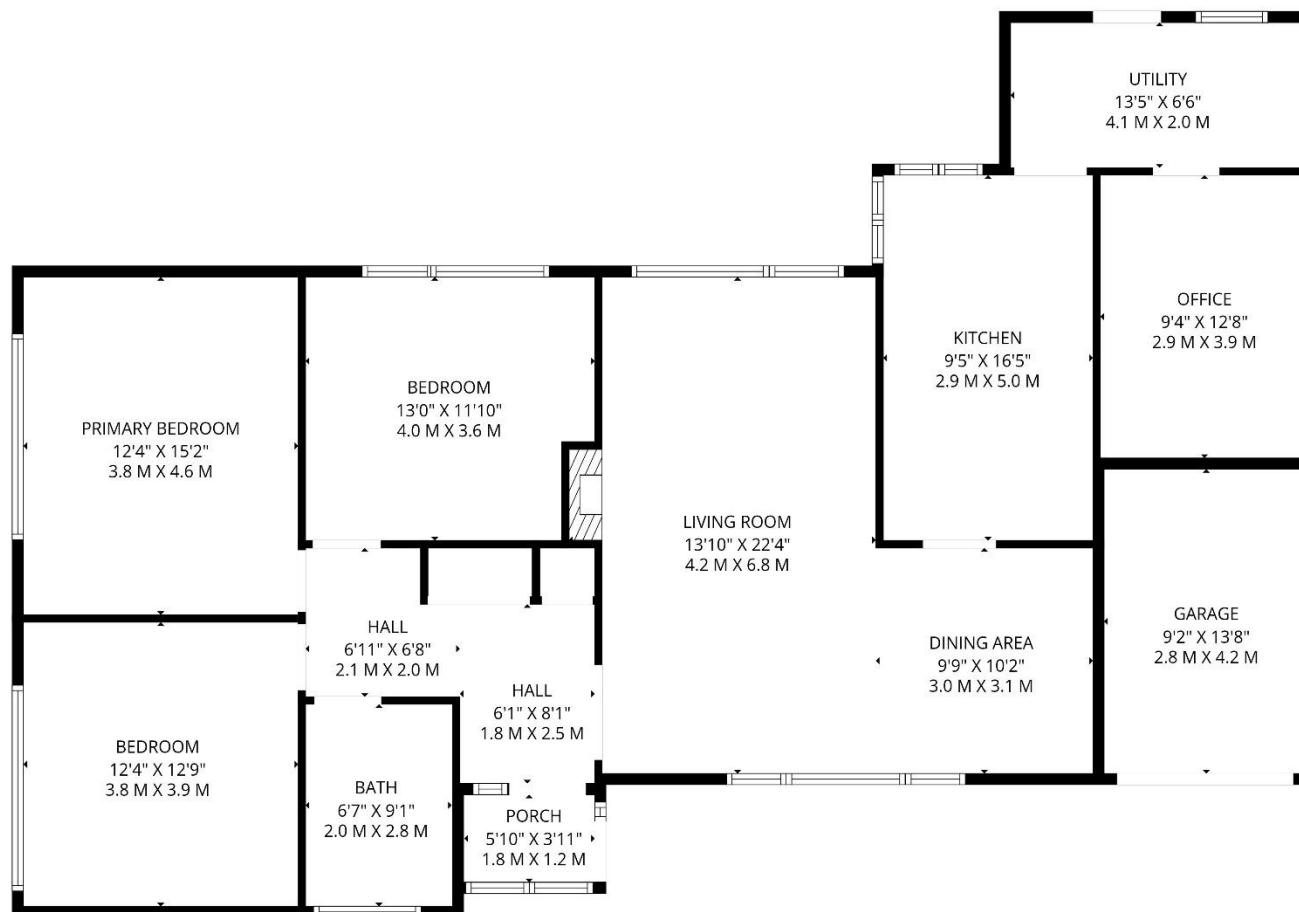

TOTAL: 1361 sq. ft, 126 m²

1st floor: 1361 sq. ft, 126 m²

EXCLUDED AREAS: PORCH: 23 sq. ft, 2 m², UTILITY: 87 sq. ft, 8 m², GARAGE: 126 sq. ft, 12 m²,
WALLS: 115 sq. ft, 11 m²



FLOOR PLAN CREATED BY INVISION MEDIA & MARKETING. MEASUREMENTS DEEMED HIGHLY RELIABLE BUT NOT GUARANTEED.

Since 1854



DOUGLAS

31 Victoria Street
Douglas IM1 2SE
T. 01624 623778
E. douglas@chrystals.co.im

PORT ERIN

23 Station Road
Port Erin IM9 6RA
T. 01624 833903
E. porterin@chrystals.co.im

COMMERCIAL

Douglas Office: 01624 625100, commercial@chrystals.co.im

RENTALS

Douglas Office: 01624 625300, douglasrentals@chrystals.co.im

Directors: Neil Taggart BSc (Hons), M.R.I.C.S.; Joney Kerruish BSc (Hons), M.R.I.C.S.; Dafydd Lewis BSc (Hons), M.R.I.C.S., MA (Cantab), Dip Surv Prac.
Registered in the Isle of Man No. 34808, Chrystal Bros, Stott & Kerruish Ltd. Trading as Chrystals. Registered Office, 31 Victoria Street, Douglas, Isle of Man IM1 2SE.