



Oakham Close, Desborough **Freehold** £225,000 O.I.E.O.

**Pattison
Lane**

Key Features



- No Onward Chain
- Three Bedroom Semi Detached
- Off Road Parking
- Ground Floor WC
- Southerly Facing Garden

Discover Your Dream Home: A Private Oasis with No Onward Chain! Step into this charming three-bedroom semi-detached home, perfectly situated on an enviable plot and offered for sale with no onward chain, ensuring a smooth and swift move.

The true highlight of this property is its magnificent southerly-facing rear garden. Imagine endless summer days enjoying the sunshine in complete tranquillity, thanks to the exceptionally high degree of privacy this outdoor haven provides. To the front, you'll find an additional garden space and a convenient driveway offering off-road parking.



Inside, the home welcomes you with a practical kitchen and a ground floor WC located at the front. The heart of the home, a spacious lounge diner, stretches across the rear, bathed in natural light thanks to beautiful French-style doors that perfectly capture the southerly aspect and offer seamless access to your private garden retreat.

Upstairs, you'll discover three comfortable bedrooms, each offering a peaceful sanctuary, alongside a stylishly refitted bathroom.

This delightful home truly offers the best of both worlds: a superb private garden for relaxation and entertaining, and a convenient location. Viewing is highly advised to fully appreciate all that this wonderful property has to offer!

The accommodation comprises:

ENTRANCE HALL

CLOAKROOM

KITCHEN 9'8 x 8'4 (2.94m x 2.54m)

LOUNGE / DINING ROOM 15'10 max x 14'10 max (4.82m x 4.52m)



GROUND FLOOR

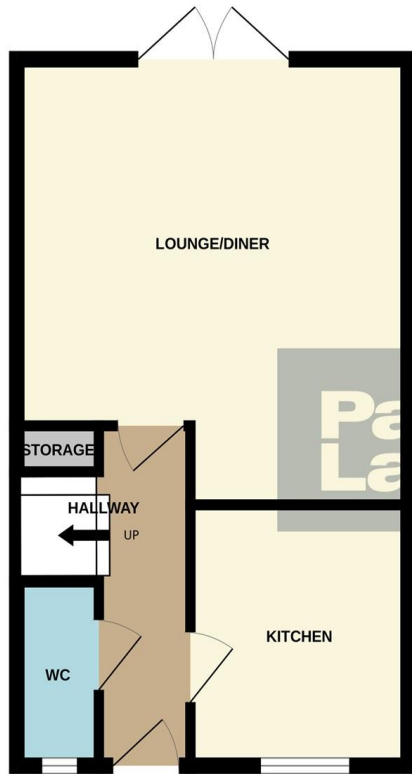

1ST FLOOR

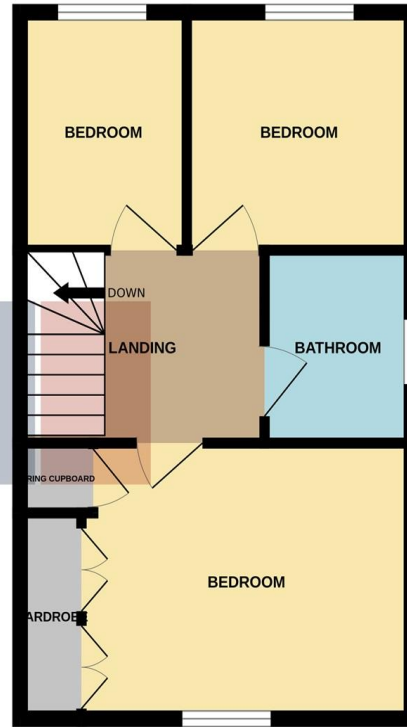

Whilst every attempt has been made to ensure the accuracy of the floorplan contained here, measurements of doors, windows, rooms and any other items are approximate and no responsibility is taken for any error, omission or mis-statement. This plan is for illustrative purposes only and should be used as such by any prospective purchaser. The services, systems and appliances shown have not been tested and no guarantee as to their operability or efficiency can be given.
Made with Metropix ©2025

FIRST FLOOR LANDING

BEDROOM ONE 12'10 max plus wardrobe x 10'
(3.91m x 3.04m)

BEDROOM TWO 8'5 x 8'6 (2.56m x 2.59m)

BEDROOM THREE 8'9 x 6' (2.66m x 1.82m)

BATHROOM

OUTSIDE

FRONT GARDEN

DRIVEWAY

REAR GARDEN

To view this property call Pattison Lane on:
01536 430527

Selling your property?



SCAN ME

Contact us to arrange a **FREE** home valuation.

 01536 430527

 42 Station Road, Desborough, KETTERING, Northamptonshire, NN14 2RL

 desborough@pattisonlane.co.uk

 www.pattisonlane.co.uk



SCAN ME



Sharman Quinney Holdings Limited is registered in England and Wales under company number 4174227, Registered Office is Cumbria House, 16-20 Hockliffe Street, Leighton Buzzard, Bedfordshire, LU7 1GN. VAT Registration Number is 500 2481 05.

1: These particulars do not constitute part or all of an offer or contract. 2: The measurements indicated are supplied for guidance only and as such must be considered incorrect. 3: Potential buyers are advised to recheck the measurements before committing to any expense. 4: Sharman Quinney has not tested any apparatus, equipment, fixtures, fittings or services and it is the buyers interests to check the working condition of any appliances. 5: Sharman Quinney has not sought to verify the legal title of the property and buyers must obtain verification from their legal representative. 6: Intending purchasers will be asked to produce identification documentation at a later stage and we would ask your co-operation in order that there will be no delay in agreeing the sale. Ref: DPL101634 - 0001

