



NO PHOTO

£1,250,000

Southbourne Crescent Hendon London NW4 2JY



4

Bedrooms



3

Bathrooms

34 Golders Green Road, London, NW11 8LL |
mail@dreamviewestates.co.uk

020 8455 0055



NO PHOTO

£1,250,000

Southbourne Crescent Hendon London NW4 2JY



Very spacious extended 4 bed 2 bath semi detached home of some 1943 sq dt/180.5 sq mt in a popular road between North Circular Road and Great North Way not far from Henlys Corner

SOUTHBOURNE CRESCENT, HENDON, NW4 2JY

Very spacious extended 4 bed 2 bath semi detached home of some 1943 sq dt/180.5 sq mt in a popular road between North Circular Road and Great North Way not far from Henlys Corner

The house has been tastefully modernised and is well looked after with a large through reception leading into the breakfast area of the fitted L shaped kitchen.

Also on the ground floor is a study or 5th bedroom with a shower room/wc plus a large playroom and utility room.

There is a stunning rear garden and off street parking.

Council Tax is band F

EPC is Band D

PRICE £1,250,000 FREEHOLD

VIEWING STRICTLY BY APPOINTMENT



NO PHOTO

£1,250,000

Southbourne Crescent Hendon London NW4 2JY

Southbourne Crescent, London, NW4

Approximate Area = 1943 sq ft / 180.5 sq m

For identification only - Not to scale

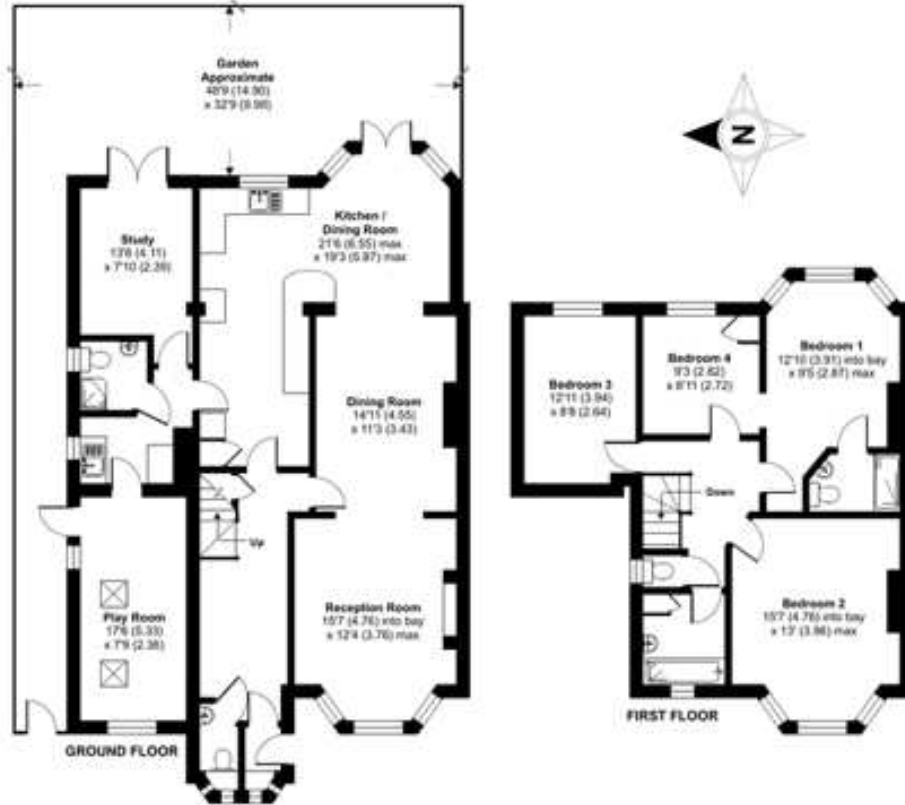

Energy Efficiency Rating

	Current	Potential
Very energy efficient - lower running costs		
(92+) A		
(81-91) B		81
(69-80) C		
(55-68) D	64	
(39-54) E		
(21-38) F		
(1-20) G		
Not energy efficient - higher running costs		
England & Wales	EU Directive 2002/91/EC	

WWW.EPC4U.COM



Floor plan produced in accordance with RICS Property Measurement Standards incorporating International Property Measurement Standards (IPMS Residential). ©edwardm 2022. Produced for Spence & Sons. HEP: 968455

zoopla **OnTheMarket** **PrimeLocation**
Find the home you deserve

naea
propertymark
PROTECTED

arla
propertymark
PROTECTED

rightmove