



Church Road, NW10

£2,800 Per Month

AVAILABLE TO LET is this bright two bedroom maisonette, set on the Ground Floor, situated on Church Road.

- AVAILABLE TO LET NOW
- 2 bedroom, 1 bathroom maisonette
- Bright reception room
- Spacious dining room
- Separate fitted kitchen
- Private garden
- COUNCIL: Brent (C)
- Deposit: £3,230
- Viewing is recommended



020 8450 9377 - 020 8459 1133
rentals@cameronsstiff.co.uk

Church Road, NW10

Approximate Area = 70.2 sq m / 755 sq ft

Limited Use Area(s) = 0.4 sq m / 4 sq ft

Total = 70.6 sq m / 759 sq ft

For Identification only - Not to Scale



Denotes Restricted
Head Height

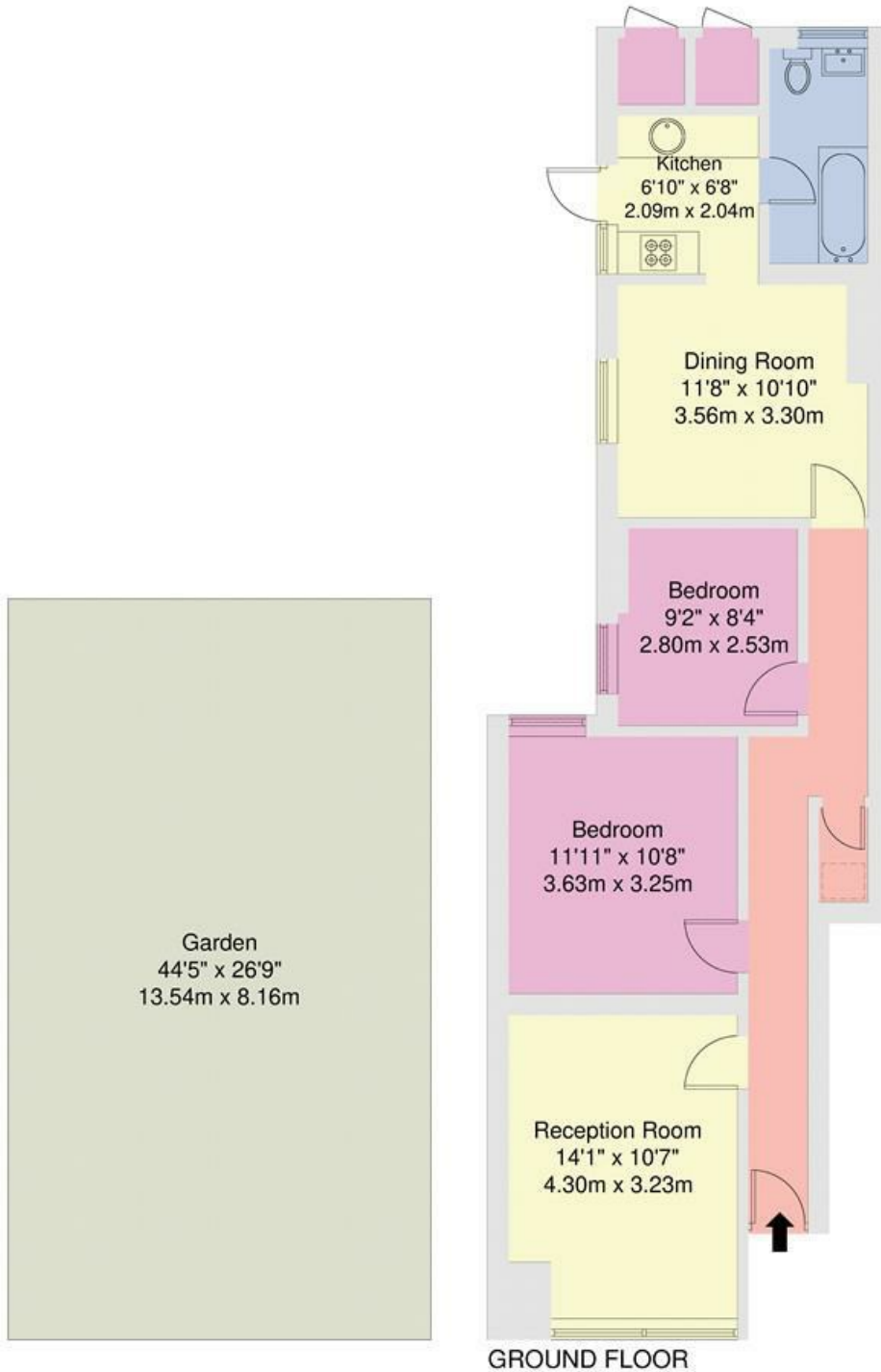

Disclaimer: Floorplan produced in accordance with RICS guidelines. While we do not doubt the floorplan accuracy and completeness, you or your advisors should conduct a careful, independent investigation of the property in respect of monetary valuation. Produced for Camerons Stiff & Co.

EPC: C

Ref: 19714193

