



**Flat 50 Lansdowne Place, Institute Road, Taplow, Maidenhead SL6 0FD**

**welcome to**

**Flat 50 Lansdowne Place, Institute Road, Taplow Maidenhead**

A well-presented two-bedroom flat ideally situated for convenient living, just a short distance from Taplow Station, making it perfect for commuters and professionals alike.



# Institute Road, Taplow, Maidenhead, SL6

Approximate Area = 771 sq ft / 71.6 sq m

For identification only - Not to scale

The property offers a bright and spacious living area, providing a comfortable setting for both relaxing and entertaining. The kitchen is well laid out with ample storage and workspace, catering to everyday needs with ease.

Both bedrooms are generously sized, offering flexible accommodation whether used for sleeping, working from home, or hosting guests. The bathroom and en-suite shower room are both neatly appointed and complete the practical layout of this attractive home.

Located in a desirable residential area, the flat benefits from close proximity to local amenities, shops, and transport links, while also being within easy reach of Maidenhead town centre and surrounding green spaces.

This property represents an excellent opportunity for first-time buyers, investors, or those seeking a conveniently located home with strong transport connections.

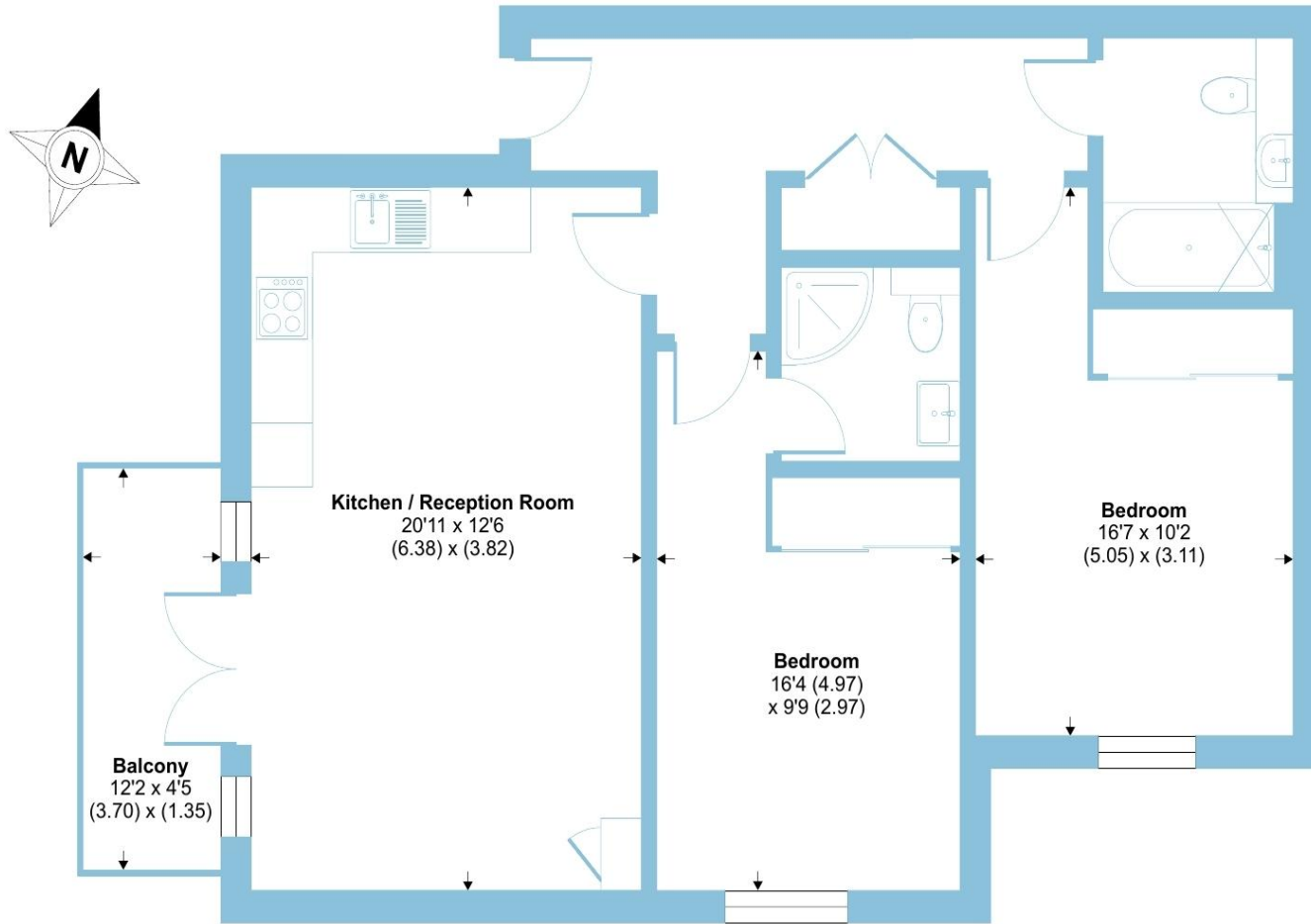

**FIRST FLOOR**

Floor plan produced in accordance with RICS Property Measurement 2nd Edition, Incorporating International Property Measurement Standards (IPMS2 Residential). © nchecom 2026. Produced for Barnard Marcus. REF: 1440791



welcome to

## Flat 50 Lansdowne Place, Institute Road

- IDEAL FIRST PURCHASE AND/OR INVESTMENT
- JUST A SHORT DISTANCE FROM TAPLOW STATION/ELIZABETH LINE
- BRIGHT & SPACIOUS LIVING AREA
- WELL LAID OUT KITCHEN WITH AMPLE STORAGE
- TWO DOUBLE BEDROOMS
- NEATLY APPOINTED BATHROOM & EN-SUITE
- ALLOCATED PARKING
- WITHIN EASY REACH OF MAIDENHEAD TOWN CENTRE

Tenure: Leasehold EPC Rating: B

Council Tax Band: C Service Charge: 2486.64

Ground Rent: 395.00

This is a Leasehold property with details as follows; Term of Lease 125 years from 29 Sep 2016. Should you require further information please contact the branch. Please Note additional fees could be incurred for items such as Leasehold packs.

# £340,000



Please note the marker reflects the postcode not the actual property

check out more properties at [rogerplatt.co.uk](http://rogerplatt.co.uk)



Property Ref:  
MHD117489 - 0001

1. MONEY LAUNDERING REGULATIONS Intending purchasers will be asked to produce identification documentation at a later stage and we would ask for your co-operation in order that there is no delay in agreeing the sale. 2. These particulars do not constitute part or all of an offer or contract. 3. The measurements indicated are supplied for guidance only and as such must be considered incorrect. Potential buyers are advised to recheck measurements before committing to any expense. 4. We have not tested any apparatus, equipment, fixtures or services and it is in the buyers interest to check the working condition of any appliances. 5. Where an EPC, or a Home Report (Scotland only) is held for this property, it is available for inspection at the branch by appointment. If you require a printed version of a Home Report, you will need to pay a reasonable production charge reflecting printing and other costs. 6. We are not able to offer an opinion either written or verbal on the content of these reports and this must be obtained from your legal representative. 7. Whilst we take care in preparing these reports, a buyer should ensure that his/her legal representative confirms as soon as possible all matters relating to title including the extent and boundaries of the property and other important matters before exchange of contracts.

Roger Platt is a trading name of Sequence (UK) Limited which is registered in England and Wales under company number 4268443, Registered Office is Cumbria House, 16-20 Hockliffe Street, Leighton Buzzard, Bedfordshire, LU7 1GN. VAT Registration Number is 500 2481 05.

  
roger platt



**01628 773333**



Maidenhead@rogerplatt.co.uk



25-29 Queen Street, MAIDENHEAD, Berkshire,  
SL6 1NB



**rogerplatt.co.uk**