



Connells

Jacksons Place
Colemans Hatch Hartfield

Jacksons Place Colemans Hatch Hartfield TN7 4HR

for sale offers in excess of
£750,000



Property Description

Nestled on Shepherds Hill in Hartfield, 1 Jackson's Place is a rare opportunity to acquire a four-bedroom semi-detached Victorian cottage set within approx. 4.35 acres and benefiting from direct access to the renowned Ashdown Forest. The property requires full renovation throughout, offering huge scope for improvement, modernisation, or reconfiguration to create a truly special rural home.

The grounds are exceptionally well-equipped, featuring an established cattery with 30 chalets, home office, and kitchen facilities, making it ideal for those seeking business or hobby use. Additional outbuildings include two stables, a garage, workshop, and a generous paddock extending to approx. 2³/₄ acres, perfectly suited for equestrian or smallholding interests and a 2-bedroom self-contained chalet and workshop. A large driveway provides ample parking for multiple vehicles.

Available to the market with no onward chain, this unique property presents a fantastic chance to secure land, buildings, and location rarely found together.

Entrance Hall

Reception/Dining Room

20' 11" x 9' 9" (6.38m x 2.97m)

Kitchen

12' x 11' 6" (3.66m x 3.51m)

Utility

Reception Room

12' 1" x 11' 6" (3.68m x 3.51m)

Utility Room

6' 11" x 5' 10" (2.11m x 1.78m)

Downstairs Bedroom

11' 6" x 7' (3.51m x 2.13m)

Downstairs Shower Room

Landing

Bedroom 1

14' 3" x 7' 5" (4.34m x 2.26m)

En Suite Bathroom

En Suite Shower Room

Bedroom 2

11' 10" x 7' 7" (3.61m x 2.31m)

Bedroom 3

8' 4" x 8' (2.54m x 2.44m)

Shower Room

Garage

3 X Stables

Office

9' 9" x 7' 8" (2.97m x 2.34m)

Utility Room

9' 9" x 7' 8" (2.97m x 2.34m)

Cloakroom

Self-Contained Chalet

With two bedrooms, large workshop (5m x 10m), power/lighting and water.









Ground Floor



First Floor

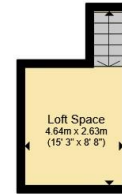

Second Floor

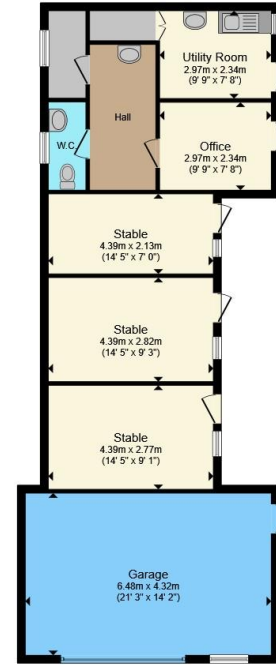

Outbuilding

Total floor area 213.7 m² (2,300 sq.ft.) approx

This floor plan is for illustrative purposes only. It is not drawn to scale. Any measurements, floor areas (including any total floor area), openings and orientation are approximate. No details are guaranteed, they cannot be relied upon for any purpose and they do not form part of any agreement. No liability is taken for any error, omission or misstatement. A party must rely upon its own inspection(s). Powered by www.propertybox.io



To view this property please contact Connells on

T 01342 325 911
E eastgrinstead@connells.co.uk

90 London Road
 EAST GRINSTEAD RH19 1EP

EPC Rating: F Council Tax
 Band: F

Tenure: Freehold

view this property online connells.co.uk/Property/EGR404820



1. MONEY LAUNDERING REGULATIONS Intending purchasers will be asked to produce identification documentation at a later stage and we would ask for your co-operation in order that there will be no delay in agreeing the sale. 2. These particulars do not constitute part or all of an offer or contract. 3. The measurements indicated are supplied for guidance only and as such must be considered incorrect. Potential buyers are advised to recheck measurements before committing to any expense. 4. We have not tested any apparatus, equipment, fixtures, fittings or services and it is in the buyers interest to check the working condition of any appliances.

Connells Residential is registered in England and Wales under company number 1489613, Registered Office is Cumbria House, 16-20 Hockliffe Street, Leighton Buzzard, Bedfordshire, LU7 1GN. VAT Registration Number is 500 2481 05.

See all our properties at www.connells.co.uk | www.rightmove.co.uk | www.zoopla.co.uk

Property Ref: EGR404820 - 0015