

Woburn Place, WC1H

£300,000

Located on the ninth floor with views of Russell Square, this studio apartment will make a perfect London base or first home. There is an open-plan living/bedroom, a separate kitchen and family bathroom. Heating and hot water is included in the service charge.

Russell Court was built in the 1930's and occupies a prominent position close to Russell Square underground station. The area has excellent transport, shopping and restaurants.

Features

- Studio Apartment
- 24 Hr Concierge
- Lift Access
- Excellent Condition
- Share Of Freehold
- No Onward Chain

Woburn Place, London, WC1H

Ninth Floor

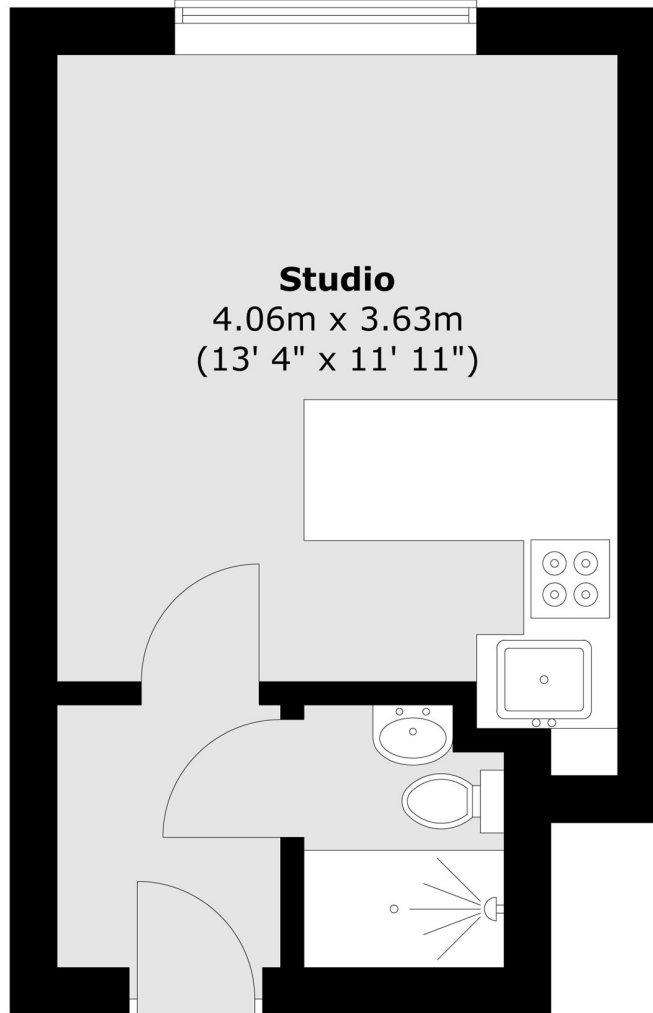

Total area (approx.) : 20.7 sq. m (223 sq. ft)