







 1 Bedrooms |  1 Receptions |  1 Bathrooms |  EPC Current D

Helliwell & Co are delighted to present this delightful flat which offers a perfect blend of comfort and convenience. Spanning approx. 549 square feet, the property features a well-appointed reception room that serves as an inviting space for relaxation or entertaining guests. The flat comprises one spacious bedroom, ideal for restful nights, and a modern bathroom that caters to all your daily needs. This property is perfect for individuals or couples seeking a stylish urban retreat in one of London's vibrant neighbourhoods. With its prime location, residents will enjoy easy access to local amenities, including shops, cafes, and public transport links, making commuting and exploring the city a breeze. Offered to the market unfurnished and is available for immediate occupation.

Located on Churchfield Road in the heart of Acton, this apartment offers a lively setting with a wide range of local shops, cafés and restaurants nearby, as well as Acton High Street and The Oaks Shopping Centre. Excellent transport links include Acton Central (Overground) within walking distance, plus Acton Main Line and Acton Town (Piccadilly & District lines) close by. The area is well served by multiple bus routes, providing easy access across West and Central London. Ideal for commuters and those seeking convenient urban living.

- | | |
|--|---|
| ■ One Bedroom Flat (approx. 549 sq ft) | ■ Bright Reception Room with Attractive Wooden Flooring |
| ■ Modern Kitchen & Bathroom | ■ Unfurnished Available Now |
| ■ Central Acton Location Near Boutique Shops & Cafés | ■ Excellent Transport Links Nearby |
| ■ Holding Deposit (1 weeks rent): £426.00 | ■ Security Deposit (5 weeks rent): £2,134.62 |
| ■ Council Tax Band | ■ Long Let 12-24 months + |

CHURCHFIELD ROAD

Approximate Gross Internal Area

588 sq ft / 54.70 sq m

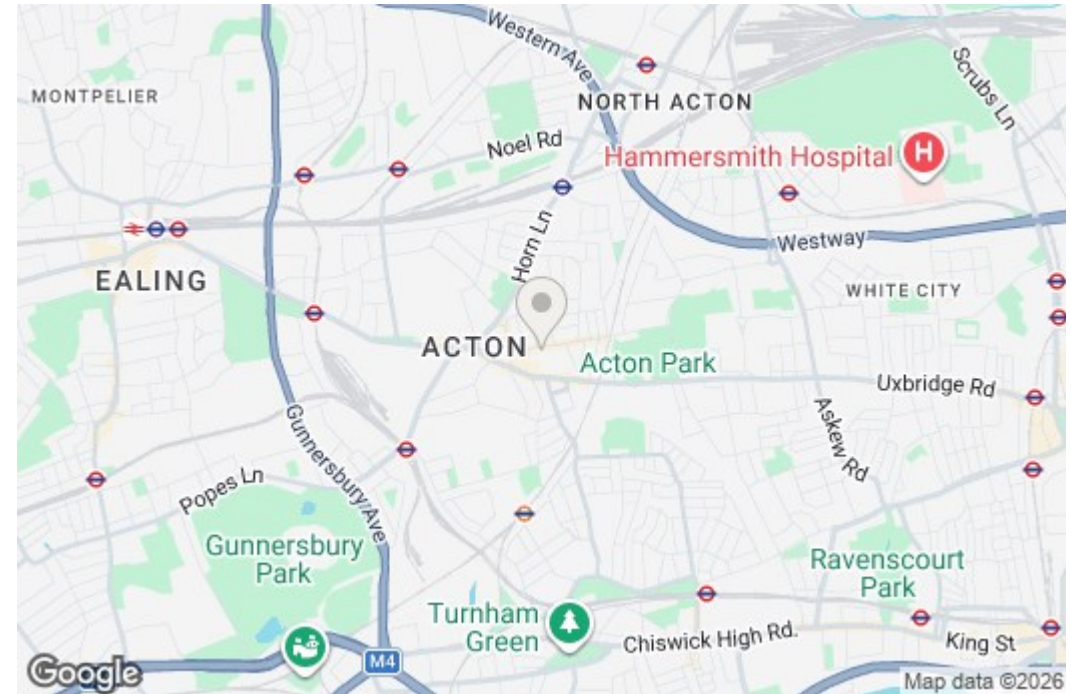
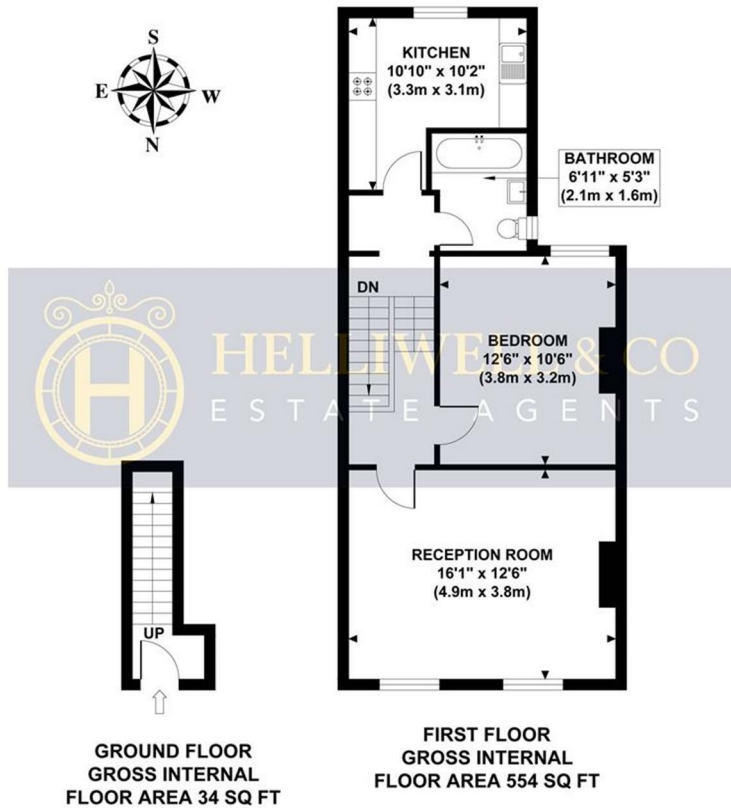

Although every attempt has been made to ensure accuracy,
all measurements are approximate and no responsibility is taken for any error, omission, or mis-statement.
This floor plan is for illustrative purposes only and not to scale. Measured in accordance to RICS standards.