



Turnchapel, Plymstock, Plymouth
Plymouth

An individually architecturally designed waterside detached home offering exceptional views and lifestyle appeal.

- Architect-designed three-storey detached waterside home
- Stunning open-plan living with bespoke kitchen and wood burner
- Wrap-around balcony with uninterrupted water views
- Principal suite with freestanding bath and private balcony
- Flexible layout with bedrooms and home office space
- Contemporary bathrooms across all floors
- Planning consent for a private slipway and boating access
- Prime Turnchapel village location with marina and city links

Council Tax Band: D

An architecturally designed waterside detached home offering exceptional views and lifestyle appeal.

This stunning three-storey detached home, individually designed and built seven years ago, has been thoughtfully created to complement its picturesque waterside setting. Every aspect of this property has been carefully considered to maximise both light and panoramic views, offering an unparalleled living experience that blends contemporary design with tranquil waterside charm.

Ground Floor

A welcoming entrance hallway leads into a versatile and well-proportioned room currently used as a home office. A practical utility room and a further home office and lobby with external door complete this level, providing functional spaces for both work and daily living.





Clovelly View, Turnchapel, Plymstock, Plymouth, PL9

Approximate Area = 2475 sq ft / 229.9 sq m

For identification only - Not to scale

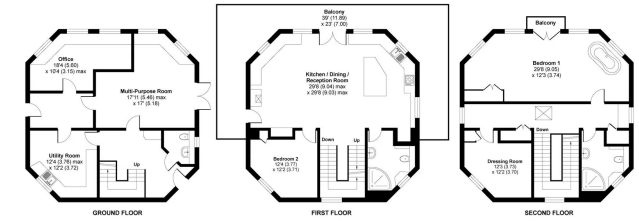
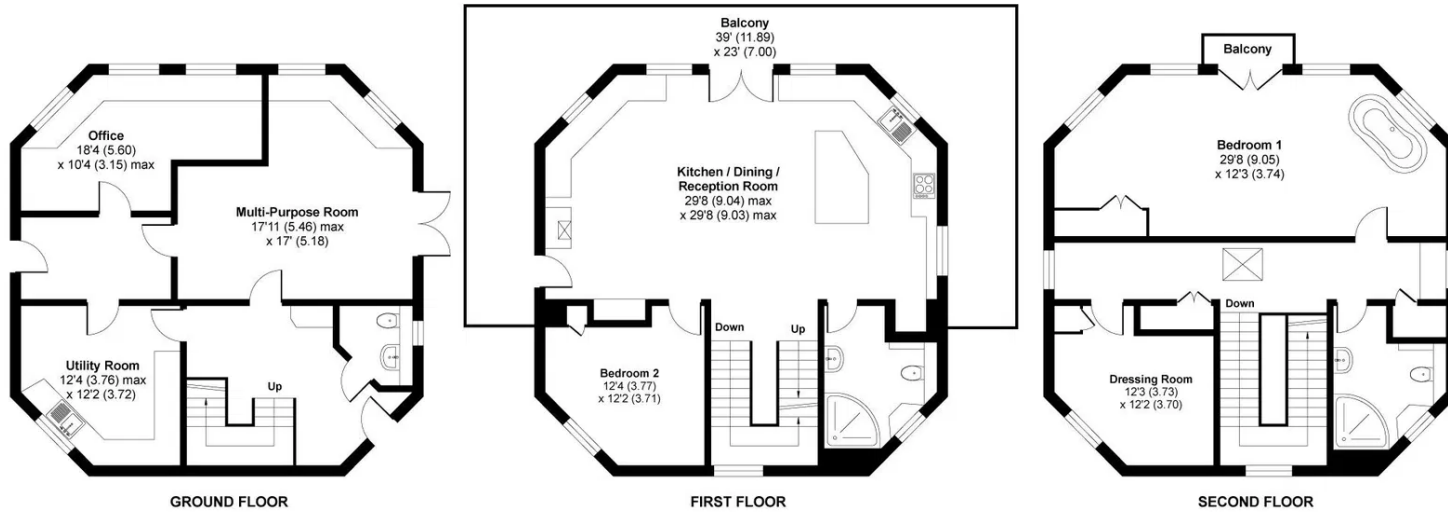

Floor plan produced in accordance with RICS Property Measurement 2nd Edition, Incorporating International Property Measurement Standards (IPMS2 Residential). © nichcom 2025. Produced for Luscombe Maye REF: 1359302

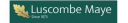

Clovelly View, Turnchapel, Plymstock, Plymouth, PL9

Approximate Area = 2475 sq ft / 229.9 sq m

For identification only - Not to scale

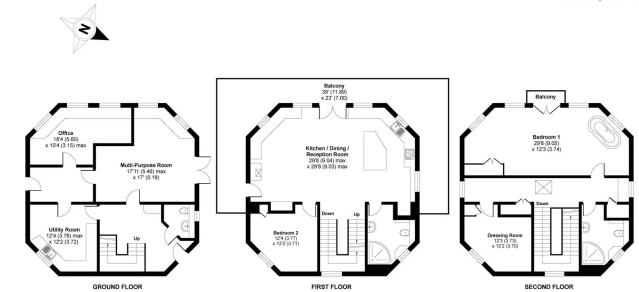

Floor plan produced in accordance with RICS Property Measurement 2nd Edition, Incorporating International Property Measurement Standards (IPMS2 Residential). © nichcom 2025. Produced for Luscombe Maye REF: 1359302

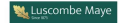

Floor plan produced in accordance with RICS Property Measurement 2nd Edition, Incorporating International Property Measurement Standards (IPMS2 Residential). © nichcom 2025. Produced for Luscombe Maye. REF: 1359302



Energy Efficiency Rating		Current	Potential
Very energy efficient - lower running costs			
(92+)	A		92
(81-91)	B	87	
(69-80)	C		
(55-68)	D		
(39-54)	E		
(21-38)	F		
(1-20)	G		
Not energy efficient - higher running costs			
England & Wales		EU Directive 2002/91/EC	