



Salisbury Close, SE17

£3,000 Per calendar month

A newly refurbished and spacious three double bedroom maisonette with two private balconies. The property also offers a spacious lounge, separate modern kitchen, a tiled bathroom, permit parking and Heating & Hot Water Included.

Ideally located for Elephant and Castle Underground (Northern & Bakerloo Lines) and close to the many amenities that Walworth High Street has to offer.

Features

- Three Double Bedrooms
- Large Reception
- Modern Kitchen
- Two Private Balconies
- Permit Parking Available
- Heating & Hot Water Included

Salisbury Close, London, SE17

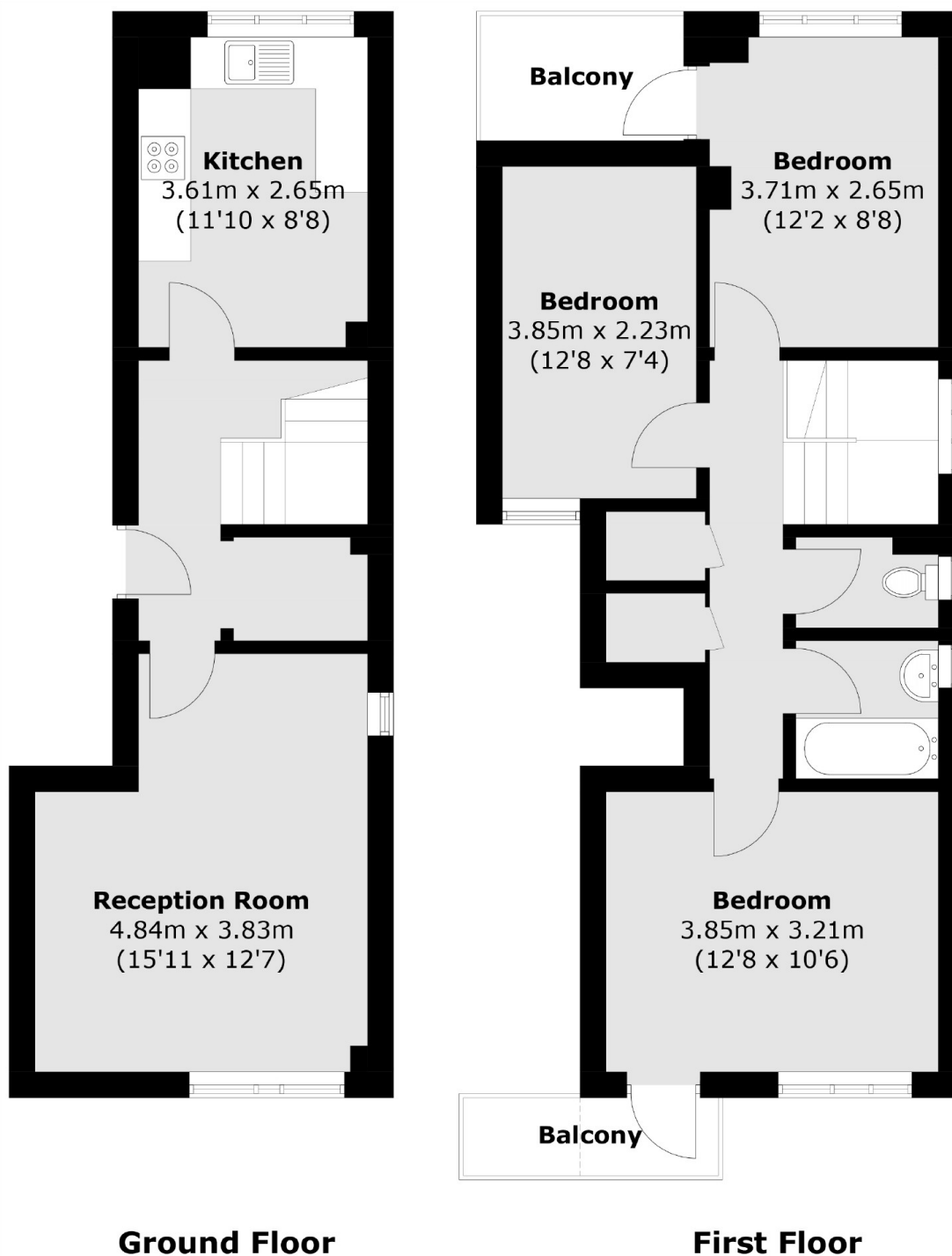

Total area (approx.): 83.3 sq. m (896.6 sq. ft)
Balcony (approx.): 6.1 sq. m (65.7 sq. ft)