



Connells

Hesketh Close
Leicester



Property Description

Eyres Monsell is located in the South West corner of Leicester. This sought after location boasts two primary schools, a selection of shops and takeaways, two large parks with play and gym equipment, churches and doctors surgeries, public house and is served by regular bus links to the city centre and has everything you need for convenient living.

This end terrace house in a cul-de-sac position benefits from three bedrooms, large kitchen/diner, off road parking and an air source boiler. Situated in a popular location it would make an ideal first time buy or investment purchase. Call now to view.

Entrance Hall

With a door to the front of the property, stairs rising to the first floor and window to the side of the property.

Lounge

There is a window to the front of the property, central heating radiator and under stairs cupboard.

Kitchen/Diner

Fitted with wall and base units, work surfaces housing the stainless steel sink drainer, splashback tiling, electric oven and hob with cooker hood over, plumbing for a washing machine, space for a fridge freezer, central heating radiator, double glazed windows to the rear and side of the property and a door to the side of the property.



First Floor Landing

With stairs rising from the hallway, airing cupboard, loft access, central heating radiator and double glazed window to the rear of the property.

Bedroom One

With a double glazed window to the rear of the property and central heating radiator.

Bedroom Two

There is a double glazed window to the front of the property and central heating radiator.

Bedroom Three

With a double glazed window to the front of the property and central heating radiator.

Bathroom

There is a bath with shower over, wash hand basin, wc, fully tiled walls, central heating radiator and double glazed window to the rear of the property.

Outside

At the front of the property there is off road parking.

The rear garden is low maintenance with paved and pebbled areas and has fenced borders.







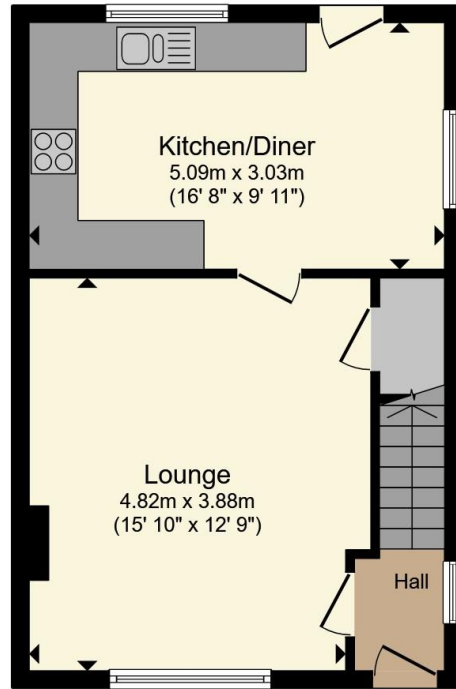

Ground Floor

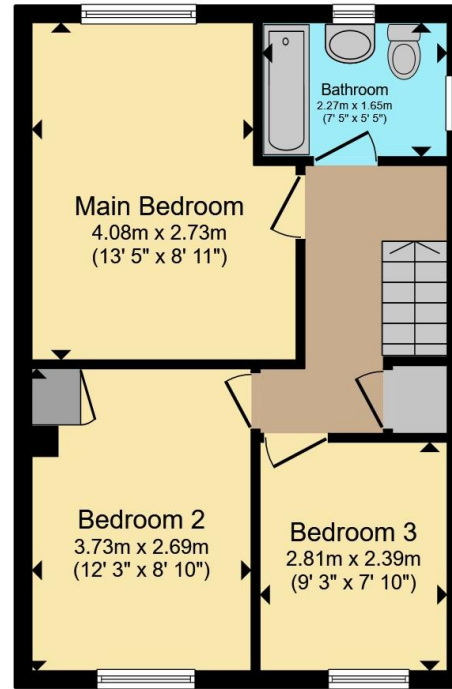

First Floor

Total floor area 81.0 m² (872 sq.ft.) approx

This floor plan is for illustrative purposes only. It is not drawn to scale. Any measurements, floor areas (including any total floor area), openings and orientation are approximate. No details are guaranteed, they cannot be relied upon for any purpose and they do not form part of any agreement. No liability is taken for any error, omission or misstatement. A party must rely upon its own inspection(s). Powered by www.propertybox.io



To view this property please contact Connells on

T 0116 247 7477
E blaby@connells.co.uk

8-10 Leicester Road BLABY
LEICESTER LE8 4GQ

directions to this property:

Proceed out of Blaby along Leicester Road and continue straight ahead towards Glen Parva. At the traffic lights continue ahead along Leicester Road. Turn right onto Red House Road, then right onto Ambleside Drive, taking the fourth left turn onto Hesketh Avenue. Turn left onto Hesketh Close where the property is located.

EPC Rating: C Council Tax Band: A

Tenure: Freehold

view this property online connells.co.uk/Property/BLA309996



1. MONEY LAUNDERING REGULATIONS Intending purchasers will be asked to produce identification documentation at a later stage and we would ask for your co-operation in order that there will be no delay in agreeing the sale. 2. These particulars do not constitute part or all of an offer or contract. 3. The measurements indicated are supplied for guidance only and as such must be considered incorrect. Potential buyers are advised to recheck measurements before committing to any expense. 4. We have not tested any apparatus, equipment, fixtures, fittings or services and it is in the buyers interest to check the working condition of any appliances.

Connells Residential is registered in England and Wales under company number 1489613, Registered Office is Cumbria House, 16-20 Hockliffe Street, Leighton Buzzard, Bedfordshire, LU7 1GN. VAT Registration Number is 500 2481 05.

See all our properties at www.connells.co.uk | www.rightmove.co.uk | www.zoopla.co.uk

Property Ref: BLA309996 - 0003