

Rowson Street, New Brighton

Offers In Region Of £159,950, Council Tax Band A, EPC Rating C

 2  1  2



Immaculately presented and much improved, double fronted, two bedroom ground floor flat within a fantastic detached building. Having the added benefit of additional basement rooms, and access to a west facing rear garden plus a new kitchen, bathroom, freshly plastered walls and new flooring throughout! Situated a short stroll down to the promenade, the beach and Vale Park. Also being a great base for local schooling, frequent transport services and commuter links. Interior: porch, inviting hallway, living room, dining room, kitchen, two bedrooms and bathroom. Complete with central heating radiator system and upgraded uPVC double glazing. Exterior: sunny patio garden. Sold with no chain; this is one not to be missed!

Key Features

- Two Bedroom Ground Floor Flat
- Immaculately Presented
- New Kitchen and Bathroom
- Council Tax Band A
- EPC Rating C
-
-
-

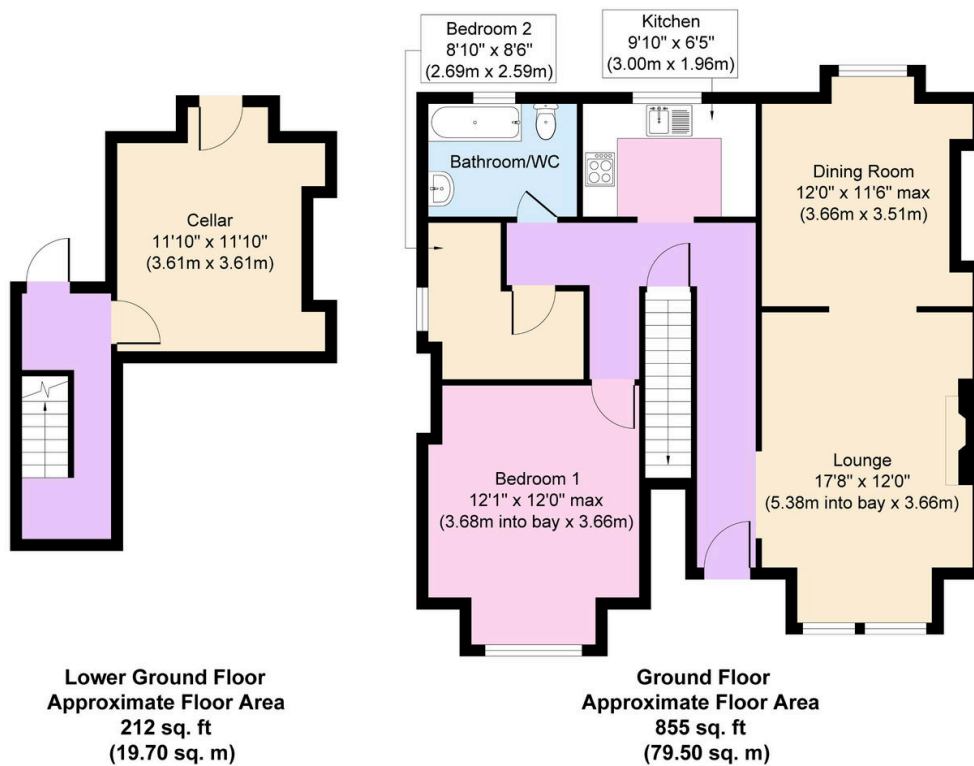

Copyright V360 Ltd 2025 | www.houseviz.com