

Merton Road, SW19

£660,000

* Share Of The Freehold * Victorian style new build apartment, this ground floor garden flat with two large bedrooms, and low running costs. The apartment spans 876 square foot, with a west facing garden this apartment would be perfect for a buyer with a young child or a pet.

Located adjacent to South Wimbledon Underground station (Northern line), which is just approximately 65 metres away. Merton Park and Morden Road Tram Stops are also nearby. Merton Road provides easy access to the A3, and the M25 motorway. There are numerous shops, bars, and restaurants on Merton High Street and in the wider Wimbledon area.

Features

- Two Large Bedrooms
- West-Facing Private Garden
- Worcester Gas Boilers
- Vent-Axia Mechanical Ventilation
- Wet Underfloor Heating
- NEF Appliances
- Quartz Worktops
- Gas Boiler

Merton Road,
South Wimbledon, SW19

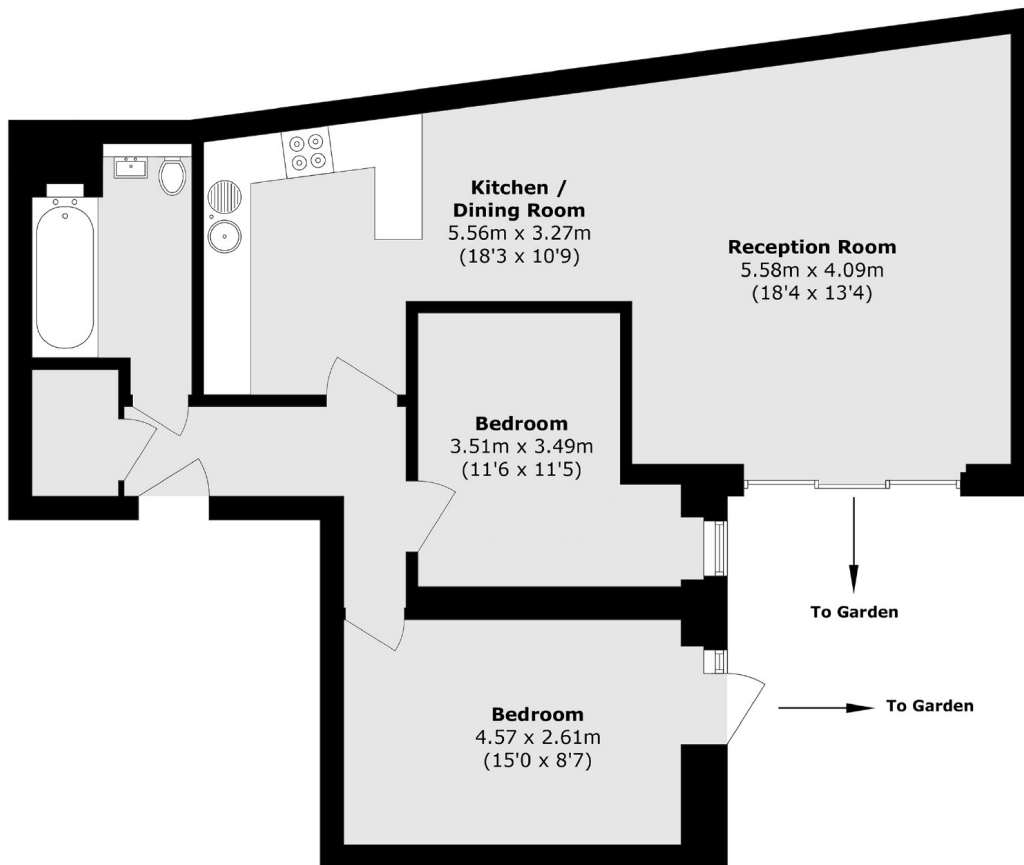

Total area (approx.): 81.4 sq. m (876.2 sq. ft)