



Tyron Way

Sidcup
DA14 6AZ

Freehold

Two bedroom mid terrace house
Overlooking a green
Chain Free
Garage en bloc close by
Private rear garden
Conservatory
Large lounge





FULL DESCRIPTION

This chain free, two bedroom mid terrace is situated in a sought after location, overlooking the green to the front.

The property is in good order throughout and comprises: Large lounge, good sized kitchen diner/diner and conservatory overlooking the rear garden.

To the first floor are two good sized bedrooms and the family bathroom.

Externally there is a private rear garden, front garden and garage en bloc.



Directions

From our Sidcup office, turn left and proceed along Station Road. At the traffic lights go straight into Elm Road then take the third right into Upperton Road, first left into Langdon Shaw and first right into Tyron Way. Closest Stations: Sidcup (0.87 mi) New Eltham (1.32 mi) Albany Park (1.66 mi) Closest Schools: Longlands Primary School (0.57 mi) West Lodge School (0.58 mi) Chislehurst School for Girls (0.34 mi) Chislehurst and Sidcup Grammar School (1.1 mi)



Local Authority
Council Tax Band
EPC Rating

Bexley London Borough Council

D
C

Tyron Way, Sidcup, DA14

Approximate Area = 807 sq ft / 74.9 sq m (excludes garage)

For identification only - Not to scale

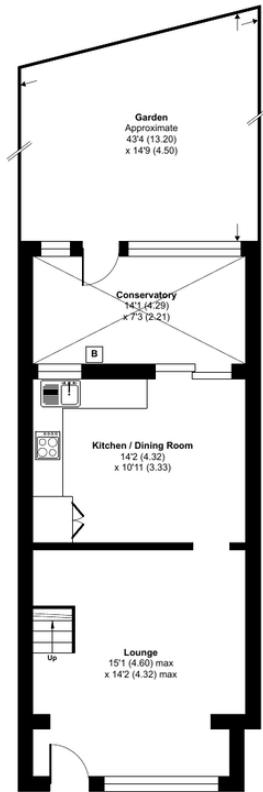

GROUND FLOOR

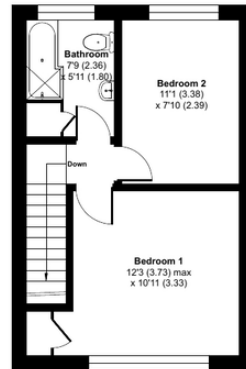

FIRST FLOOR

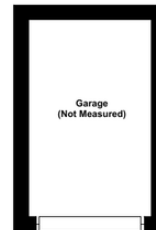

 Floor plan produced in accordance with RICS Property Measurement Standards incorporating International Property Measurement Standards (IPMS2 Residential). © rnhcom 2026. Produced for Drewery. REF: 1447465

Drewery Property Consultants

128 Station Road
Sidcup
Kent
DA15 7AF

Contact

020 8269 6605
info@drewery.co.uk
www.drewery.co.uk

Agents Note: Whilst every care has been taken to prepare these particulars, they are for guidance purposes only. All measurements are approximate and are for general guidance purposes only and whilst every care has been taken to ensure their accuracy, they should not be relied upon and potential buyers/tenants are advised to recheck the measurements.