



**Daniel Way, Silver End, WITHAM, CM8 3SS**

**welcome to**

**Daniel Way, Silver End, WITHAM**

**\*\* GUIDE PRICE £290,000 - £300,000 \*\*** William H Brown are pleased to offer this spacious three-bedroom family home, set in the popular village of Silver End and located close to local amenities, primary school, and with excellent access to the A120 and A12, it's perfect for families and commuters.



### **Porch**

Door leading to:-

### **Dining Area**

11' 10" x 10' 2" ( 3.61m x 3.10m )

Double glazed window to front aspect. Pendant lighting. Carpets.

### **Lounge Area**

16' 5" x 11' 2" ( 5.00m x 3.40m )

Double glazed window to rear aspect. Stairs to first floor. Electric radiators. Pendant lighting. Carpets.

### **Kitchen**

9' 10" x 6' 7" ( 3.00m x 2.01m )

Double glazed window and door to rear garden. Range of matching base and eye level units with work surface over incorporating a one and a half sink drainer with hot and cold mixer tap. Space for cooker and fridge freezer. Plumbing and space for washing machine.

### **Landing**

Loft access. Doors leading to:-

### **Bedroom One**

13' 5" x 10' 10" ( 4.09m x 3.30m )

Double glazed window to front aspect. Carpets. Pendant lighting.

### **Bedroom Two**

10' 10" x 10' 6" ( 3.30m x 3.20m )

Double glazed window to rear aspect. Carpet. Electric heater. Circle spotlights.

### **Bedroom Three**

9' 10" max x 8' 2" max ( 3.00m max x 2.49m max )

Double glazed window to front aspect. Circle spotlights. Laminate flooring.

### **Bathroom**

5' 7" x 7' 5" ( 1.70m x 2.26m )

Obscure double glazed window to rear aspect. Side panel bath with hot and cold mixer tap and shower attachment. Low level WC. Vanity hand wash basin. Part tiled walls. Laminate flooring,

### **Garden**

Commencing with patio seating area and remainder laid to lawn. Enclosed by panel fencing.

### **Parking**

Driveway providing off street parking leading to garage.

### **Garage**

18' 1" x 9' 10" ( 5.51m x 3.00m )



***view this property online*** [williamhbrown.co.uk/Property/BTR110191](http://williamhbrown.co.uk/Property/BTR110191)



welcome to

## Daniel Way, Silver End WITHAM

- Three Bedroom Family Home
- Popular Village of Silver End
- Two Reception Rooms
- Close to Local Amenities
- Driveway for Multiple Cars

Tenure: Freehold EPC Rating: Awaited  
Council Tax Band: C

guide price

**£290,000 - £300,000**

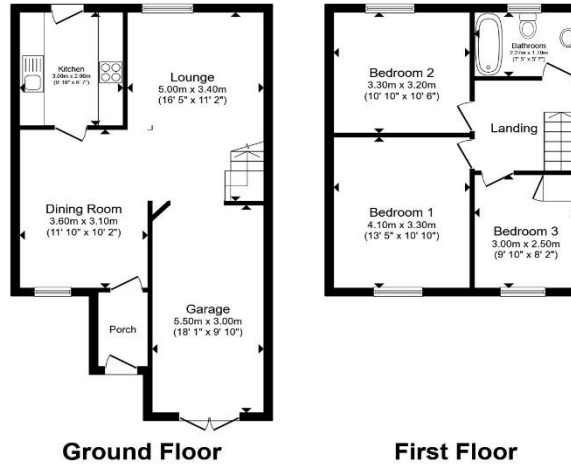

Total floor area 97.8 m<sup>2</sup> (1,053 sq.ft.) approx  
This floor plan is for illustrative purposes only. It is not drawn to scale. Any measurements, floor areas (including any total floor area), openings and orientation are approximate. No details are guaranteed, they cannot be relied upon for any purpose and they do not form part of any agreement. No liability is taken for any error, omission or misstatement. A party must rely upon its own inspection(s). Powered by www.propertybox.io

william  
h brown



Please note the marker reflects the  
postcode not the actual property

view this property online [williamhbrown.co.uk/Property/BTR110191](https://www.williamhbrown.co.uk/Property/BTR110191)



Property Ref:  
BTR110191 - 0002

1. MONEY LAUNDERING REGULATIONS Intending purchasers will be asked to produce identification documentation at a later stage and we would ask for your co-operation in order that there is no delay in agreeing the sale. 2. These particulars do not constitute part or all of an offer or contract. 3. The measurements indicated are supplied for guidance only and as such must be considered incorrect. Potential buyers are advised to recheck measurements before committing to any expense. 4. We have not tested any apparatus, equipment, fixtures or services and it is in the buyers interest to check the working condition of any appliances. 5. Where an EPC, or a Home Report (Scotland only) is held for this property, it is available for inspection at the branch by appointment. If you require a printed version of a Home Report, you will need to pay a reasonable production charge reflecting printing and other costs. 6. We are not able to offer an opinion either written or verbal on the content of these reports and this must be obtained from your legal representative. 7. Whilst we take care in preparing these reports, a buyer should ensure that his/her legal representative confirms as soon as possible all matters relating to title including the extent and boundaries of the property and other important matters before exchange of contracts.

William H Brown is a trading name of Sequence (UK) Limited which is registered in England and Wales under company number 4268443, Registered Office is Cumbria House, 16-20 Hockliffe Street, Leighton Buzzard, Bedfordshire, LU7 1GN. VAT Registration Number is 500 2481 05.

william  
h brown



**01376 320018**



[braintree@williamhbrown.co.uk](mailto:braintree@williamhbrown.co.uk)



51-53 High Street, BRAINTREE, Essex, CM7 1JX



[williamhbrown.co.uk](https://www.williamhbrown.co.uk)