

16 JURA WAY
CRIEFF, PH7 3FX



IrvingGeddes
W.S. • Solicitors • Estate Agents

16 JURA WAY, CRIEFF, PH7 3FX

Irving Geddes are delighted to offer for sale this most attractive and very well presented modern 4 bed detached Champion Homes 'Laburnum' villa completed in 2024. Located in a popular development, within a 5 minute walk of the community campus. The well-proportioned accommodation is offered in true move-in condition and comprises on the ground floor: large LOUNGE with under-stairs storage, beautiful DINING KITCHEN with patio doors, & UTILITY ROOM with garden access & W.C. off. The upper landing has three storage cupboards & attic access, FAMILY BATHROOM, useful STUDY/OFFICE, & FOUR BEDROOMS, three with built-in wardrobes & the master with EN-SUITE SHOWER ROOM. An energy efficient home warmed by gas-fired central heating, supplemented by solar panels, with high performance double glazing.

There are private low-maintenance front and rear gardens, the front laid to lawn with a large mono-block driveway. The fully enclosed rear has a large lawn, raised paved patio and is bordered by timber fencing. The large integral single garage has power and lighting, with side pedestrian access.

A quality family home with NHBC warranty, boasting a great location and turn-key presentation.











These particulars are believed to be correct, but their accuracy is not guaranteed and they do not form part of any contract. All measurements are approximate only.

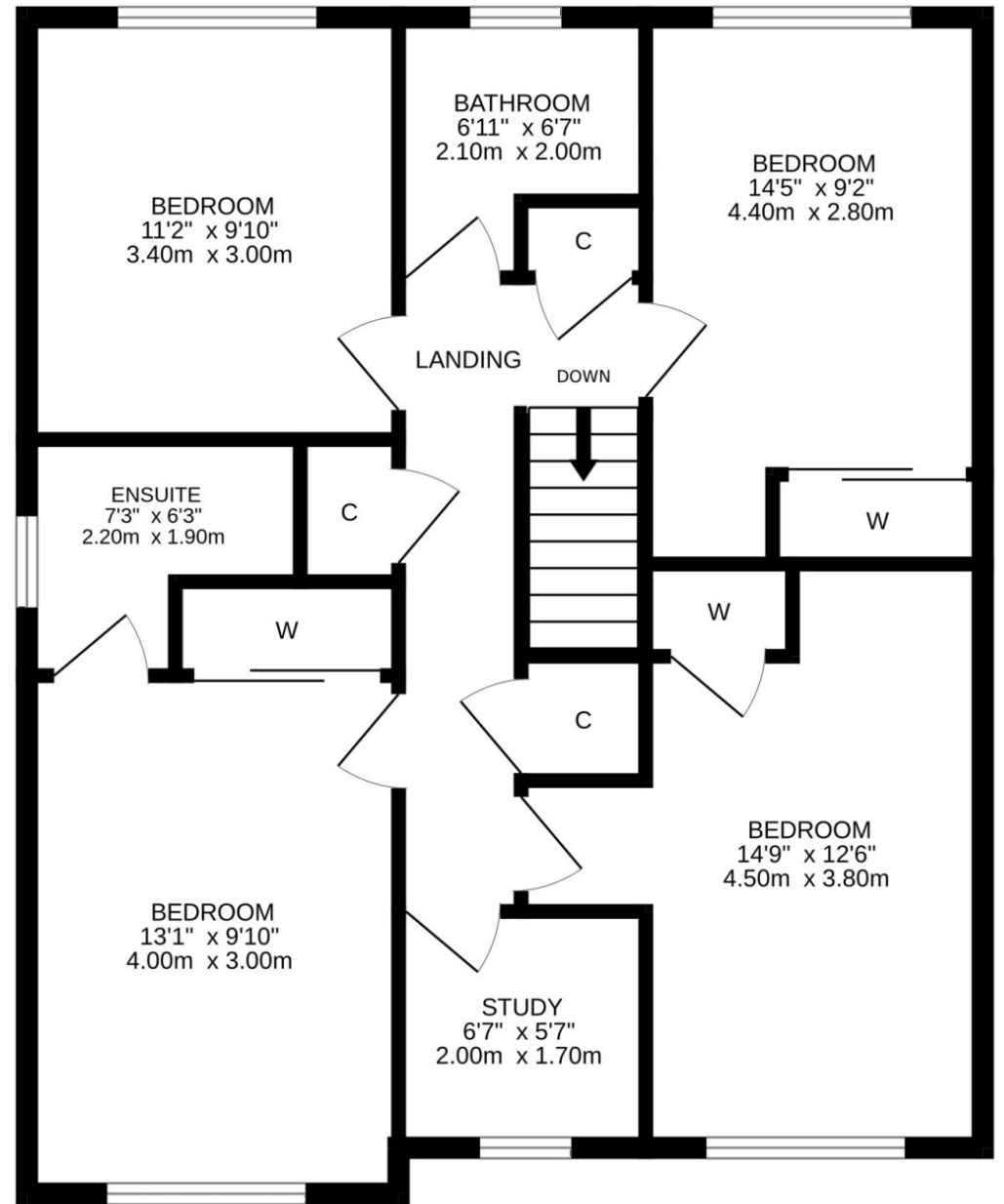
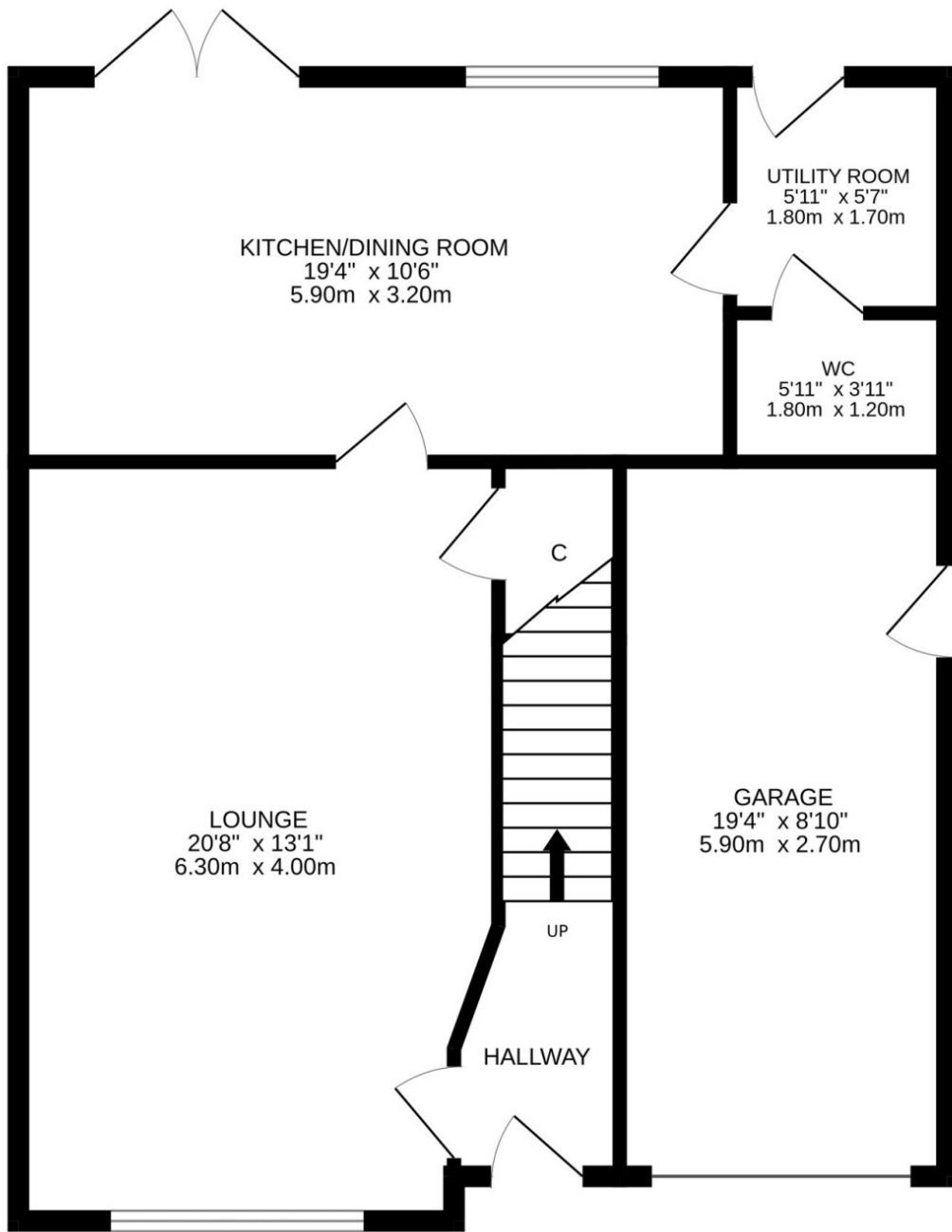



Crieff
25 West High Street, PH7 4AU
Tel: 01764 653771

Comrie
1 Drummond Street, PH6 2DW
Tel: 01764 670325

Aberfeldy
6 The Square, PH15 2DD
Tel: 01887 822722