



**3 Bed  
Flat  
located in**

**£3,600 Per month**



**SECOMBE**  
estates

36 Kepler Road  
London  
SW4 7PQ

Kitchen

Living Room

Bedroom One

Bathroom

Bedroom Two

Bedroom Three

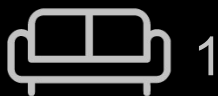



KEPLER ROAD, SW4  
 TOTAL APPROX FLOOR PLAN AREA 1062 SQ.FT (99 SQ.M)

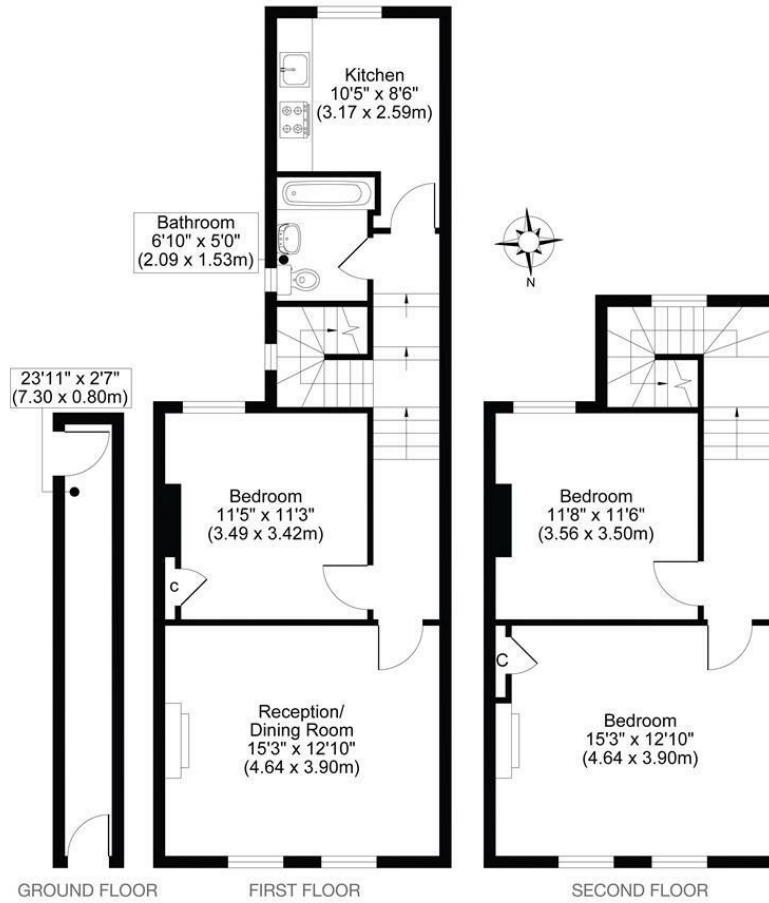

All measurements, walls, doors, windows, fittings and their appliances, their size and locations are shown conventionally and are approximate only and cannot be regarded as being a representation either by the seller or his agent.



**DIRECTIONS**

**CONTACT**

25 St Julians Farm Road  
 London  
 SE27 0RJ

E: [hello@secombeestates.co.uk](mailto:hello@secombeestates.co.uk)  
 T: 07493 164 455  
[www.secombeestates.co.uk](http://www.secombeestates.co.uk)

Energy Efficiency Rating		Current	Potential
<i>Very energy efficient - lower running costs</i>			
(92 plus) <b>A</b>			
(81-91) <b>B</b>			
(69-80) <b>C</b>			
(55-68) <b>D</b>			
(39-54) <b>E</b>			
(21-38) <b>F</b>			
(1-20) <b>G</b>			
<i>Not energy efficient - higher running costs</i>			
<b>England &amp; Wales</b>		EU Directive 2002/91/EC	

**SECOMBE**  
 estates