



Godsey Crescent, Market Deeping, Peterborough
£215,000 Freehold

**Sharman
Quinney**

Key Features



- Terrace Home
- Three Bedrooms
- Lounge
- Kitchen/Diner
- South Facing Garden

Accommodation Includes

Front door to :

Reception Hall
Understairs storage cupboard.

Kitchen Dining Room
2.90m x 4.00m (9'6" x 13'1"). Comprising a range of base and eye level units with worktops over, sink, plumbing for washing machine, electric oven with 5 ring electric hob and extractor over, space for fridge freezer, window to front aspect.



Lounge

3.50m x 5.40m (11'6" x 17'9"). Multi fuel burner with surround, radiator, window to rear aspect, door to rear garden, stairs to first floor and landing, understairs storage.

Stairs to first floor and landing

Loft access, loft housing combi boiler.

Bedroom One

3.85m x 3.35m (12'8" x 11'). Radiator, two windows to front aspect, two radiators.

Bedroom Two

3.85m x 3.15m (12' 8" x 10'4"). Radiator, window to rear aspect.

Bedroom Three

2.15m x 2.15m max (7'1" x 7'1" max). Window to rear, over stairs storage cupboard.

Family Bathroom

Refitted and comprising free standing bath, shower cubicle with rain shower, wc, wash hand basin.





Ground Floor

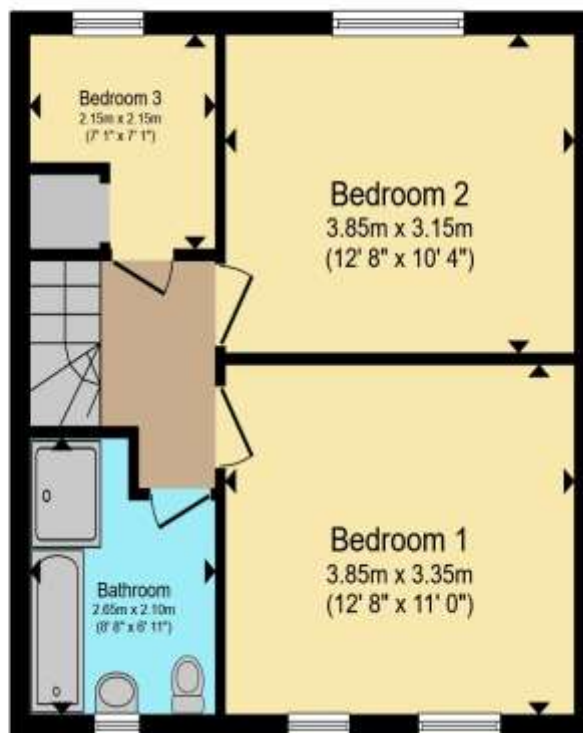

First Floor

Total floor area 75.0 m² (807 sq.ft.) approx

This floor plan is for illustrative purposes only. It is not drawn to scale. Any measurements, floor areas (including any total floor area), openings and orientation are approximate. No details are guaranteed, they cannot be relied upon for any purpose and they do not form part of any agreement. No liability is taken for any error, omission or misstatement. A party must rely upon its own inspection(s). Powered by www.propertybox.ie



Outside

The private south facing rear garden has a patio seating area leading to lawned area with further raised patio to the end of the garden and pergola, two storage sheds and enclosed by timber fencing. The property also benefits from roof solar panels.

To the front the ornamental garden is enclosed by picket fencing and there is a communal parking area.

To view this property call Sharman Quinney on:
01778 343322

Selling your property?

Contact us to arrange a **FREE** home valuation.

 01778 343322

 25 Market Place, Market Deeping,
PETERBOROUGH, Cambridgeshire, PE6 8EA

 marketdeeping@sharmanquinney.co.uk

 www.sharmanquinney.co.uk



 SCAN ME



Sharman Quinney Holdings Limited is registered in England and Wales under company number 4174227, Registered Office is Cumbria House, 16-20 Hockliffe Street, Leighton Buzzard, Bedfordshire, LU7 1GN. VAT Registration Number is 500 2481 05.

1: These particulars do not constitute part or all of an offer or contract. 2: The measurements indicated are supplied for guidance only and as such must be considered incorrect. 3: Potential buyers are advised to recheck the measurements before committing to any expense. 4: Sharman Quinney has not tested any apparatus, equipment, fixtures, fittings or services and it is the buyers interests to check the working condition of any appliances. 5: Sharman Quinney has not sought to verify the legal title of the property and buyers must obtain verification from their legal representative. 6: Intending purchasers will be asked to produce identification documentation at a later stage and we would ask your co-operation in order that there will be no delay in agreeing the sale. Ref: MRD202419 - 0005

