



143, Cartmell Road, Sheffield, S8 0NL

143, Cartmell Road

Sheffield, S8 0NL

Description

An end of run, mid terrace property offering an impressive 1079 square feet of accommodation (including the cellar). The property features a UPVC framed utility room/rear porch off the kitchen offshot, wood burning stoves in both reception rooms and a modern finish throughout. Being an end of run terrace there is also a sense of privacy in the rear garden with no passing traffic and the potential to create a lovely, private garden to complement the immaculate interior. The location on Cartmell Road is also a major plus to this property. Situated a short walk away from the excellent amenities that are found on Woodseats and also not far away from the cosmopolitan Abbeydale Road which has seen a huge Renaissance in recent years with a number of independent bars, cafes and restaurants opening to give the area its own, unique feel. This is a lovely property, perfect for first time buyers who are looking for a house that doesn't require any modernisation.

- Three bedrooms including two good doubles.
- Offshot kitchen with modern units, plinth heater and access to the UPVC framed utility room/entrance porch.
- Sitting room with a wood burning stove creating a cosy feel in the winter months.
- Dining room, overlooking the rear garden and having a further wood burner to set the scene while dining.
- Modern bathroom.
- End of run garden providing privacy and more security.
- Gas central heating and UPVC double glazing combine to create an EPC rating of D63.
- Freehold, Council Tax Band A.
- Great location, close to excellent local shops, bars, restaurants and transport links.
- Cellar and brick built store for occasional storage.





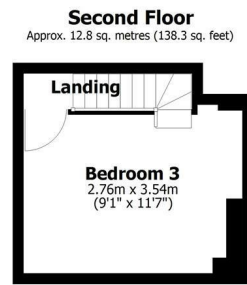
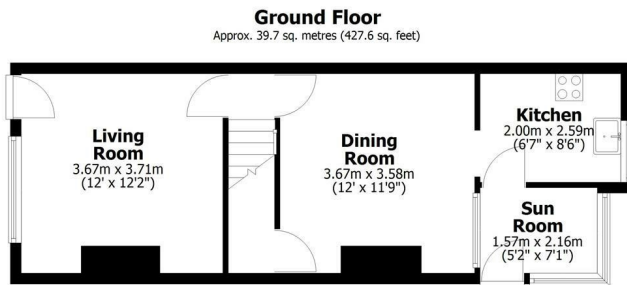
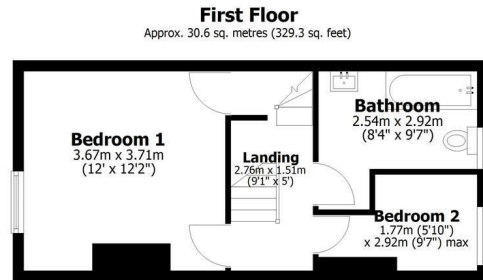
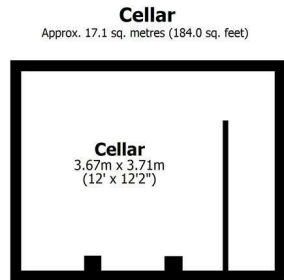

Total area: approx. 100.3 sq. metres (1079.2 sq. feet)

All measurements are approximate
Yorkshire EPC & Floor Plans Ltd
Plan produced using PlanUp.

143 Cartmell Road



Bakewell
3 Royal Oak Place
Matlock Street
Bakewell DE45 1HD
T: 01629 700699
E: bakewell@elr.co.uk

Banner Cross
888 Ecclesall Road
Banner Cross
Sheffield S11 8TP
T: 01142 683388
E: bannercross@elr.co.uk

Dore
33 Townhead Road
Sheffield
S17 3GD
T: 0114 2362420
E: dore@elr.co.uk

Hathersage
Main Road, Hathersage
Hope Valley
Derbyshire S32 1BB
T: 01433 651888
E: peakdistrict@elr.co.uk

Rotherham
149 Bawtry Road
Wickersley
Rotherham S66 2BW
T: 01709 917676
E: wickersley@elr.co.uk

**EADON
LOCKWOOD
& RIDDLE**
ESTD 1840