



## SOMERFIELD ROAD, FINSBURY PARK, N4

### 2 BED APARTMENT

£2,150 PCM

\*LIVING ROOM CONVERTED TO A SECOND BEDROOM\* - Two double bedroom period conversion set on the second floor moments from Finsbury Park station. The property comprises of a separate kitchen, two double bedroom and a tiled bathroom. The apartment has wood flooring throughout.

Well located for easy access to Finsbury Park tube (3 mins walk) servicing the Victoria Line, with the vibrant local shops and amenities located moments away

Available 25th August 2025 on a furnished basis.

**Hemmingfords**

Somerfield Road, N4

Approximate Gross Internal Area = 34.4 sq m / 370 sq ft

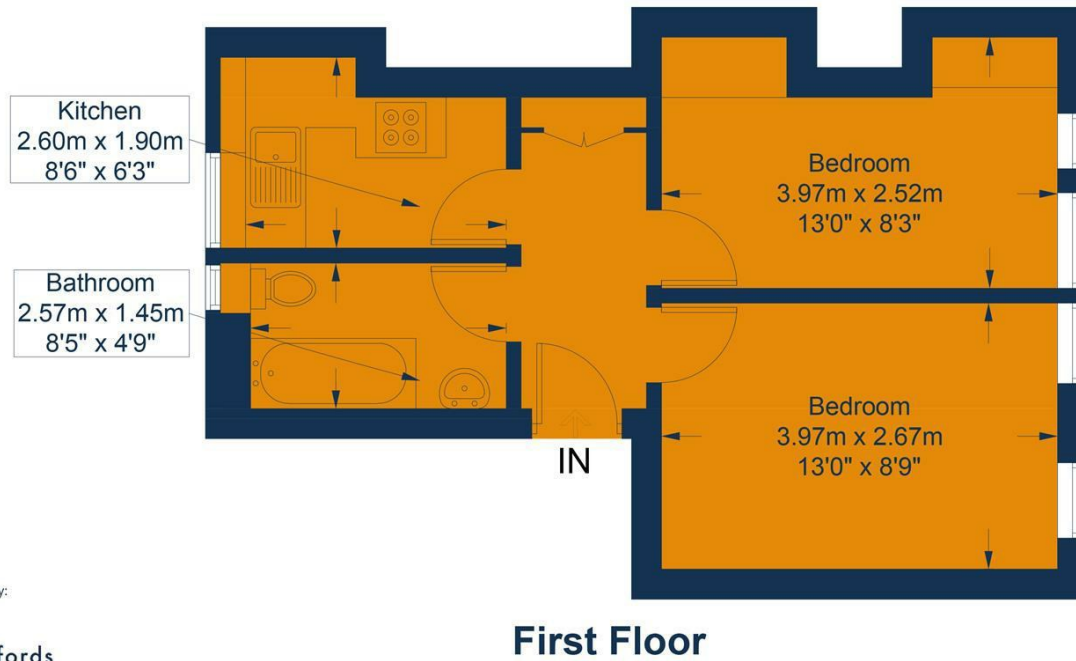

Brought to you by:

**Hemmingfords**

This plan is for layout guidance only and is not to scale unless stated. All dimensions, including windows, doors, fittings, and the total area, are approximate measurements. Produced by a



Energy Efficiency Rating		Current	Potential
Very energy efficient - lower running costs			
(92 plus) A			
(81-91) B			
(69-80) C		75	79
(55-68) D			
(39-54) E			
(21-38) F			
(1-20) G			
Not energy efficient - higher running costs			
<b>England &amp; Wales</b>		EU Directive 2002/91/EC	

Agents Note: Whilst every care has been taken to prepare these particulars, they are for guidance purposes only. All measurements are approximate and are for general guidance purposes only and whilst every care has been taken to ensure their accuracy, they should not be relied upon and potential buyers/tenants are advised to recheck the measurements

Hemmingfords Lettings  
34 Upper Street  
London  
N1 0PN

020 3890 7470  
info@hemmingfords.co.uk  
www.hemmingfords.co.uk

**Hemmingfords**