



Balfe Street, N1

£675 Per week

A well presented two bedroom split level apartment on the first floor of this Georgian conversion. The apartment has a spacious reception with separate kitchen, two double bedrooms and modern bathroom suite.

Balfe Street is a stones throw from Kings Cross/St Pancras station. It is very conveniently located for all links for central London and beyond. It is a quiet street with residents parking and is well located for UCL, SOAS and Central Saint Martins.

Features

- Georgian Property
- Two Double Bedrooms
- Split Level
- Modern Kitchen
- Wooden Floors
- Great Location

Balfe Street,
London, N1

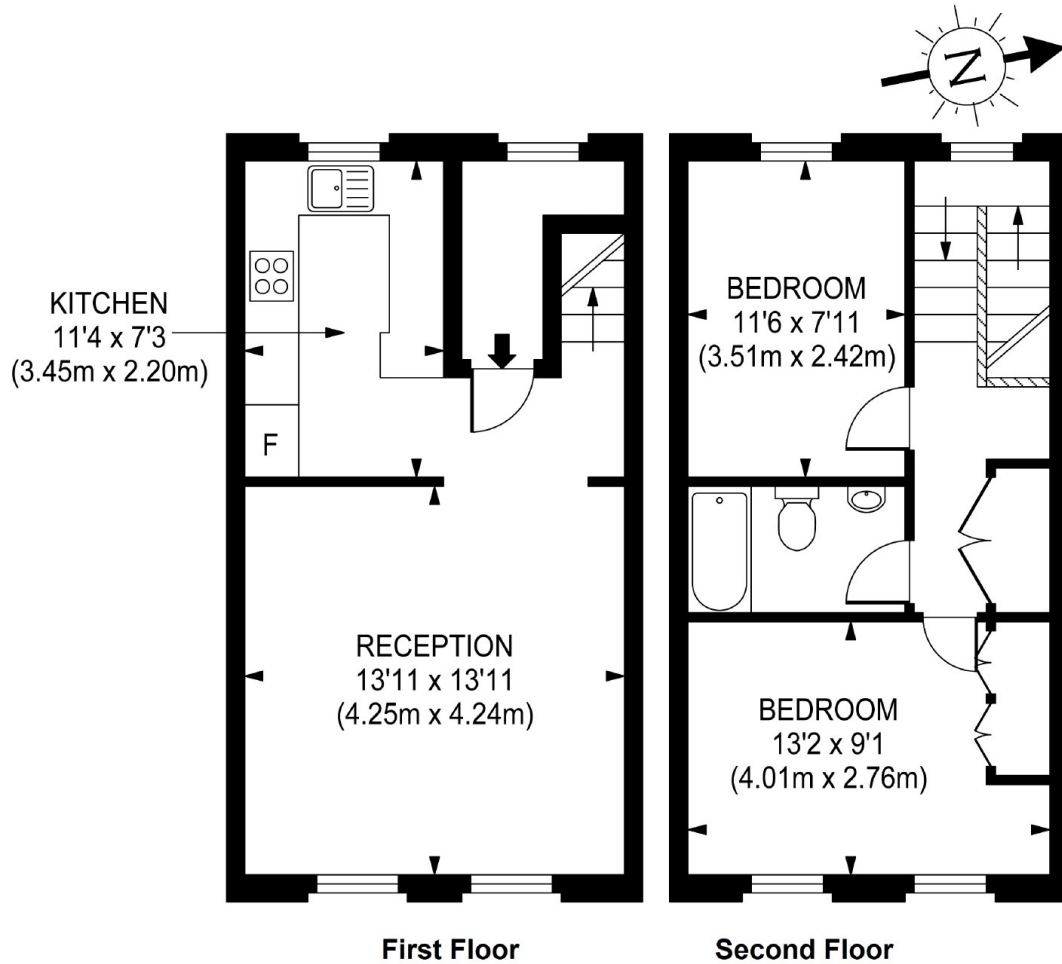

Gross Internal Area 700 sq ft/ 65 sq meters

Whilst every attempt had been made to ensure the accuracy of the floorplan shown, all the measurements, positioning fixtures, fittings and any other data shown are an approximate interpretation for illustrative purposes only and are not for scale. No responsibility is taken for any error, omission, miss-statement or use of data shown.

Dexters

Bloomsbury
55-56 Coram Street
London
WC1N 1HB

Lettings
020 7833 4488

Energy Rating: C. We aim to make our particulars both accurate and reliable. However they are not guaranteed; nor do they form part of an offer or contract. If you require clarification on any points then please contact us, especially if you're traveling some distance to view. Please note that appliances and heating systems have not been tested and therefore no warranties can be given as to their good working order.

 **RICS** Regulated
Estate Agent
and Letting Agent

dexters.co.uk