



HILL LANE, BRENT KNOLL

TA9



# HILL LANE BRENT KNOLL

Detached, five bedroom home set high on Brent Knoll, standing prominently in its own private plot with sweeping countryside views, landscaped gardens and versatile outbuildings.



Local Authority: North Somerset Council

Council Tax band: G

Tenure: Freehold

**Guide Price: £895,000**



Set in an elevated position on the slopes of Brent Knoll with sweeping views across open countryside, this handsome detached home has been cherished by the same family for 25 years. During that time, it has been thoughtfully extended and upgraded, including a kitchen remodel and renovation, addition of a bright conservatory and a summer house in the landscaped gardens.

Approached via a long private drive, the house stands prominently within its plot. The accommodation is set over two floors and offers five bedrooms, a double garage and various outbuildings.









A broad entrance hall leads to a bright, dual aspect sitting room with a log-burning stove and impressive west facing bay window with fantastic countryside views. There is a separate dining room with access to the patio to the front of the house. The current owners have added a conservatory, on the southly aspect, which enjoys panoramic garden views. The heart of the house is the open-plan kitchen/ breakfast room with views over the rear garden, fitted with bespoke cabinetry, a central island and an Aga. There is a well-equipped utility with internal access to the double garage, and cloakroom alongside.

Upstairs are five well-proportioned bedrooms. The principal suite has a luxurious en-suite bath and shower room which benefits from dual aspect rural views. Two further bedrooms also enjoy en-suite facilities and have lovely west facing views at the front of the home. The remaining bedrooms, one of which is currently used as a home office, share a smart family bathroom.







The landscaped gardens are a true highlight, with mature planting and a generous terrace for outdoor entertaining. There are outbuildings on the plot including: a summer house, with electricity and water supply which overlooks the pond; a stable and store which is currently used as additional storage space.







# Hill Lane

## Brent Knoll, Highbridge

Gross Internal Area (Approx.)  
 Main House = 243.5 sq m / 2,621 sq ft  
 Garage = 36.5 sq m / 393 sq ft  
 Outbuildings = 58.3 sq m / 628 sq ft  
 Total Area = 338.3 sq m / 3,642 sq ft

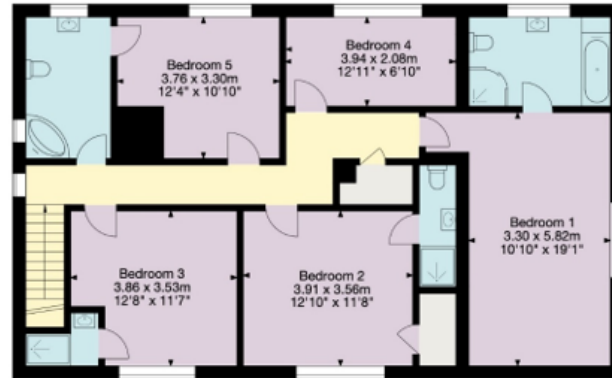

First Floor

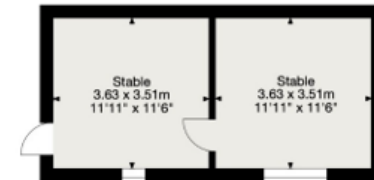
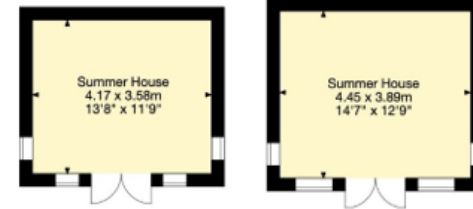

Outbuildings



Ground Floor

- Living Area/Reception
- Kitchen/Utility
- Bedroom/Dressing Room
- Bathroom/WC
- Vaults/Storage
- Terrace/Outside Space

Important Notice: This plan is not to scale (unless specified), is for guidance only and must not be relied upon as a statement of fact. All measurements and areas are approximate only (and have been prepared in accordance with the current edition of the RICS Code of Measuring Practice). Please read the Important Notice on the last page of text of the particulars. © Capture Property Marketing 2025.

**0117 317 1999**

1 The Mall, Clifton  
 Bristol, BS8 4DP  
 bristol@knightfrank.com

We would be delighted  
to tell you more.

**Robin Engley**  
0117 317 1996  
robin.engley@knightfrank.com

**Knight Frank Bristol**  
1 The Mall  
Clifton

[knightfrank.co.uk](https://www.knightfrank.co.uk)

Your partners in property

1. Particulars: These particulars are not an offer or contract, nor part of one. You should not rely on statements given by Knight Frank in the particulars, by word of mouth or in writing ("information") as being factually accurate about the property, its condition or its value. Neither Knight Frank nor any joint agent has any authority to make any representations about the property, and accordingly any information given is entirely without responsibility on the part of Knight Frank. 2. Material Information: Please note that the material information is provided to Knight Frank by third parties and is provided here as a guide only. While Knight Frank has taken steps to verify this information, we advise you to confirm the details of any such material information prior to any offer being submitted. If we are informed of changes to this information by the seller or another third party, we will use reasonable endeavours to update this as soon as practical. 3. Photos, Videos etc: The photographs, property videos and virtual viewings etc. show only certain parts of the property as they appeared at the time they were taken. Areas, measurements and distances given are approximate only. 4. Regulations etc: Any reference to alterations to, or use of, any part of the property does not mean that any necessary planning, building regulations or other consent has been obtained. A buyer must find out by inspection or in other ways that these matters have been properly dealt with and that all information is correct. 5. Fixtures and fittings: A list of the fitted carpets, curtains, light fittings and other items fixed to the property which are included in the sale (or may be available by separate negotiation) will be provided by the Seller's Solicitors. 6. VAT: The VAT position relating to the property may change without notice. 7. To find out how we process Personal Data, please refer to our Group Privacy Statement and other notices at <https://www.knightfrank.com/legals/privacy-statement>.

Particulars dated May 2024. Photographs and videos dated May 2024. All information is correct at the time of going to print. Knight Frank is the trading name of Knight Frank LLP. Knight Frank LLP is a limited liability partnership registered in England and Wales with registered number OC305934. Our registered office is at 55 Baker Street, London W1U 8AN. We use the term 'partner' to refer to a member of Knight Frank LLP, or an employee or consultant. A list of members names of Knight Frank LLP may be inspected at our registered office. If you do not want us to contact you further about our services then please contact us by either calling 020 3544 0692, email to [marketing.help@knightfrank.com](mailto:marketing.help@knightfrank.com) or post to our UK Residential Marketing Manager at our registered office (above) providing your name and address.