



Connells

Furlong Lane
Alrewas Burton-On-Trent



Property Description

A Semi detached family home situated in the very popular Village of Alrewas, conveniently close to local schools and amenities.

The property offers two generous double bedrooms, a spacious lounge to the fore and a large breakfast kitchen to the rear over looking the garden ideal for a young family or professional couple just starting out.

Outside, there is a private enclosed rear garden with a useful brick build store. The property is being offered with vacant possession, making it an excellent opportunity for first time buyers, downsizers or investors.

Alrewas is a highly sought after Staffordshire Village offering a blend of rural charm and modern convenience. Renowned for its picturesque riverside setting, the village provides excellent local amenities, well regarded schools and superb transport links.



Porch

Reception Hallway

Guest W/C

Lounge

11' 10" x 9' 8" (3.61m x 2.95m)

Kitchen/Dining Room

16' 7" x 11' 7" (5.05m x 3.53m)

First Floor Landing

Master Bedroom

13' x 9' 5" (3.96m x 2.87m)

Bedroom Two

11' 8" x 9' 6" (3.56m x 2.90m)

Shower Room

8' 4" x 6' 9" (2.54m x 2.06m)

Rear Garden

Brick Built Garden Store

Alrewas

Alrewas is a large village in Staffordshire, situated between the cities of Lichfield and Burton upon Trent. It lies on the banks of the River Trent and is known for its attractive rural setting, historic character, and strong community atmosphere.

Some highlights of the village include:

* Home to the nationally significant National Memorial Arboretum, a 150-acre site featuring memorials, gardens, and woodland dedicated to remembrance.

* Excellent access to major road networks, including the A38, A50, and M6 Toll, making it popular with commuters.

* A range of local amenities including shops, pubs, cafés, a doctor's surgery, and a primary school.

* Surrounded by attractive Staffordshire countryside with numerous walking, cycling, and riverside routes.

* A thriving village community with regular events, clubs, and activities throughout the year.







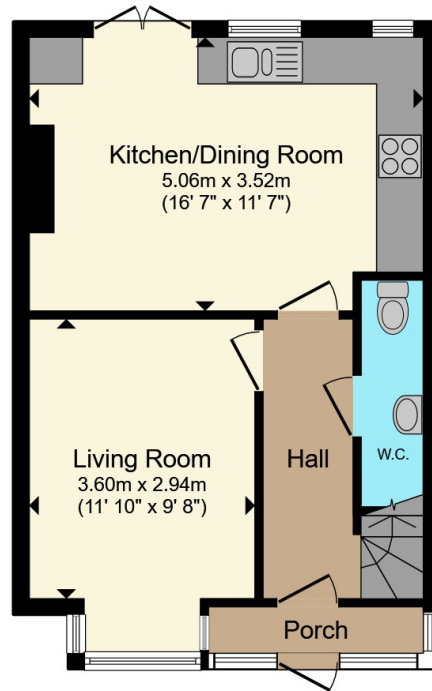

Ground Floor

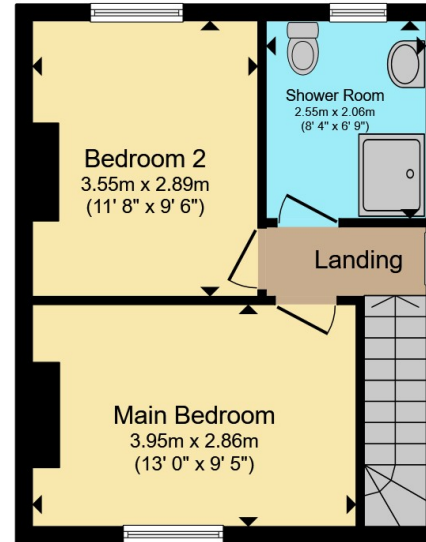

First Floor

Total floor area 72.5 m² (781 sq.ft.) approx

This floor plan is for illustrative purposes only. It is not drawn to scale. Any measurements, floor areas (including any total floor area), openings and orientation are approximate. No details are guaranteed, they cannot be relied upon for any purpose and they do not form part of any agreement. No liability is taken for any error, omission or misstatement. A party must rely upon its own inspection(s). Powered by www.propertybox.io



To view this property please contact Connells on

T 01543 262 376
E lichfield@connells.co.uk

11-13 Bore Street
 LICHFIELD WS13 6LZ

EPC Rating: E Council Tax
 Band: B

Tenure: Freehold

view this property online connells.co.uk/Property/LFD312236



1. MONEY LAUNDERING REGULATIONS Intending purchasers will be asked to produce identification documentation at a later stage and we would ask for your co-operation in order that there will be no delay in agreeing the sale. 2. These particulars do not constitute part or all of an offer or contract. 3. The measurements indicated are supplied for guidance only and as such must be considered incorrect. Potential buyers are advised to recheck measurements before committing to any expense. 4. We have not tested any apparatus, equipment, fixtures, fittings or services and it is in the buyers interest to check the working condition of any appliances.

Connells Residential is registered in England and Wales under company number 1489613, Registered Office is Cumbria House, 16-20 Hockliffe Street, Leighton Buzzard, Bedfordshire, LU7 1GN. VAT Registration Number is 500 2481 05.

See all our properties at www.connells.co.uk | www.rightmove.co.uk | www.zoopla.co.uk

Property Ref: LFD312236 - 0003