

**Campernell Close, Brightlingsea  
CO7 0TB  
Offers in Excess of £110,000  
Leasehold**





- WELL PRESENTED
- SPACIOUS LOUNGE
- FITTED KITCHEN
- DOUBLE BEDROOM
- FAMILY BATHROOM

- FIRST FLOOR
- PARKING AVAILABLE
- IDEAL FIRST TIME PURCHASE OR INVESTMENT OPPORTUNITY
- CLOSE TO TOWN CENTRE
- NO ONWARD CHAIN

**\*\* SPACIOUS ONE BEDROOM FLAT with No Chain \*\***

Well presented first floor flat, which would suit single occupiers and couples alike.

The spacious light and airy lounge/diner opens to the fitted kitchen, there is a good sized double bedroom as well as a bathroom.

Located with walking distance to the town centre, close to schools, local amenities and transport links.

Off road parking available for convenience.

**NO ONWARD CHAIN**



The accommodation with approximate room sizes are as follows:

#### **COMMUNAL ENTRANCE**

Entrance door, stairs to first and second floor landings.

#### **ENTRANCE HALL**

Entrance door, doors to:

#### **LOUNGE/DINER**

14' 2" x 10' 2" (4.31m x 3.10m)

Window to rear aspect, carpet flooring, electric radiator, centre light.

#### **KITCHEN**

10' 1" x 6' 10" (3.07m x 2.08m)

Window to rear aspect, tiled flooring. Range of base and wall units with roll-top work surfaces, single sink/drain, electric hob & oven, space for washing machine, centre light.

#### **BEDROOM**

12' 5" x 10' 5" (3.78m x 3.17m)

Two windows to front aspect, carpet flooring, electric heater, centre light.

#### **BATHROOM**

6' 10" x 5' 10" (2.08m x 1.78m)

Panelled bath with shower over, low level WC and pedestal wash hand basin, centre light. Tiled flooring, partially tiled walls, centre light.

#### **EXTERIOR**

Off road parking.





Score	Energy rating	Current	Potential
92+	A		
81-91	B		83 B
69-80	C	75 C	
55-68	D		
39-54	E		
21-38	F		
1-20	G		

FIRST FLOOR  
446 sq.ft. (41.4 sq.m.) approx.

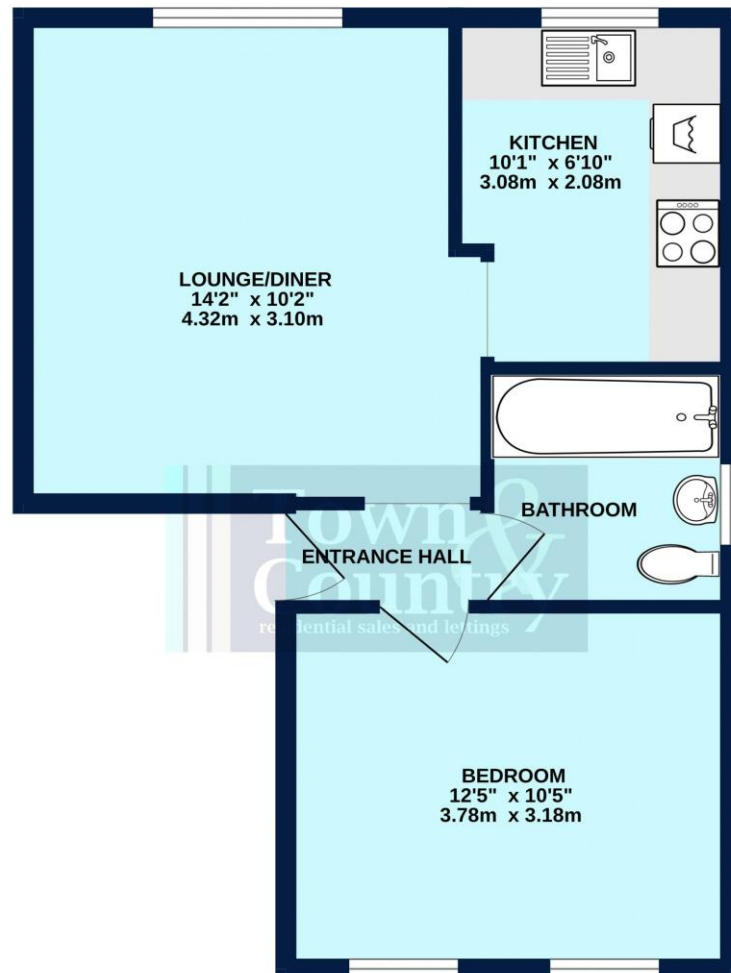

CAMPERNELL CLOSE

TOTAL FLOOR AREA: 446 sq.ft. (41.4 sq.m.) approx.

Whilst every attempt has been made to ensure the accuracy of the floorplan contained here, measurements of doors, windows, rooms and any other items are approximate and no responsibility is taken for any error, omission or mis-statement. This plan is for illustrative purposes only and should be used as such by any prospective purchaser. The services, systems and appliances shown have not been tested and no guarantee as to their operability or efficiency can be given.  
Made with Metropix ©2025

Property Misdescription Act 1991: The Agent has not tested any apparatus, equipment, fixture, fittings or services and does not verify they are in working order, fit for their purpose, or within ownership of the sellers, or within the lessors interest therefore the buyer or ingoing tenant must assume the information given is incorrect. All sizes are approx. and should not be relied on. Buyers/ tenants should satisfy themselves of dimensions when ordering inward fixtures and fittings. Neither has the agent checked the legal documentation to verify legal status of the property, or any neighbourhood planning that is pending, current or proposed for the future. A buyer or ingoing tenant must assume the information is incorrect until it has been verified by their own solicitors. Nothing concerning the type of construction, condition of the structure or its surroundings is to be implied