



Pilgrims Way, Harleston IP20 9QE



welcome to

Pilgrims Way, Harleston

A well-maintained three-bedroom detached home in Harleston, within walking distance of the town centre, featuring a stylish newly renovated kitchen and a bright open-plan living and dining area with garden access. Benefits include a south-facing turfed garden with decking, plus a driveway and garage

Entrance Porch

Front door, window to side aspect.

Entrance Hall

Radiator, tiled flooring.

Lounge

15' 6" x 11' 3" Max (4.72m x 3.43m Max)

Door to rear aspect, fire place with gas fire, carpet flooring.

Dining Room

10' x 8' 1" (3.05m x 2.46m)

Window to side aspect, French doors to rear aspect, radiator, hard flooring.

Kitchen

11' x 9' 3" Max (3.35m x 2.82m Max)

Windows to front and side aspect, door leading to rear garden, wall and base units, tiled splash back, built in sink, radiator.

Landing

Window to side aspect, airing cupboard with gas combi boiler, loft access.

Bedroom 1

11' 3" x 8' 5" Max (3.43m x 2.57m Max)

Window to front aspect, radiator, fitted wardrobes, carpet flooring.

Bedroom 2

11' 2" x 6' 10" Plus recess (3.40m x 2.08m Plus recess)

Window to front aspect, radiator, carpet flooring.

Bedroom 3

8' 1" x 6' 10" (2.46m x 2.08m)

Window to rear aspect, radiator, carpet flooring.

Bathroom

W/C, wash basin, bath with shower over head, radiator, pat tiled walls, laminate flooring.

Rear Garden

Decking area, turfed area, shingle, access to side.

Parking

Driveway for off road parking.

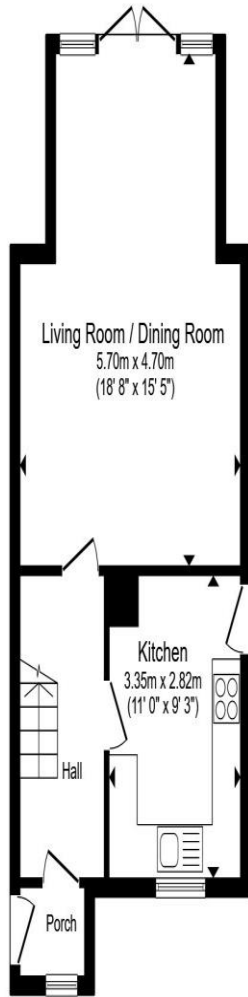

Ground Floor

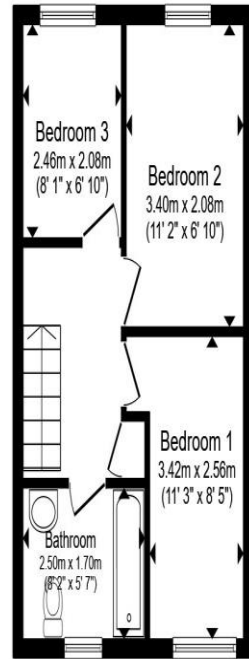

First Floor

Total floor area 74.4 m² (801 sq.ft.) approx

This floor plan is for illustrative purposes only. It is not drawn to scale. Any measurements, floor areas (including any total floor area), openings and orientation are approximate. No details are guaranteed, they cannot be relied upon for any purpose and they do not form part of any agreement. No liability is taken for any error, omission or misstatement. A party must rely upon its own inspection(s). Powered by www.propertybox.io



**welcome to
Pilgrims Way,
Harleston**

- Three-bedroom detached house
- Walking distance of Harleston town centre
- South-facing garden
- Beautifully renovated kitchen
- Open-plan living and dining area

Tenure: Freehold EPC Rating: D
Council Tax Band: C

offers in excess of
£250,000



view this property online williamhbrown.co.uk/Property/DSS111552



Property Ref:
DSS111552 - 0002

1. MONEY LAUNDERING REGULATIONS Intending purchasers will be asked to produce identification documentation at a later stage and we would ask for your co-operation in order that there is no delay in agreeing the sale. 2. These particulars do not constitute part or all of an offer or contract. 3. The measurements indicated are supplied for guidance only and as such must be considered incorrect. Potential buyers are advised to recheck measurements before committing to any expense. 4. We have not tested any apparatus, equipment, fixtures or services and it is in the buyers interest to check the working condition of any appliances. 5. Where an EPC, or a Home Report (Scotland only) is held for this property, it is available for inspection at the branch by appointment. If you require a printed version of a Home Report, you will need to pay a reasonable production charge reflecting printing and other costs. 6. We are not able to offer an opinion either written or verbal on the content of these reports and this must be obtained from your legal representative. 7. Whilst we take care in preparing these reports, a buyer should ensure that his/her legal representative confirms as soon as possible all matters relating to title including the extent and boundaries of the property and other important matters before exchange of contracts.

William H Brown is a trading name of Sequence (UK) Limited which is registered in England and Wales under company number 4268443, Registered Office is Cumbria House, 16-20 Hockliffe Street, Leighton Buzzard, Bedfordshire, LU7 1GN. VAT Registration Number is 500 2481 05.



william h brown



01379 644719



Diss@williamhbrown.co.uk



1 Navire House Mere Street, DISS, Norfolk,
IP22 4AG



williamhbrown.co.uk