

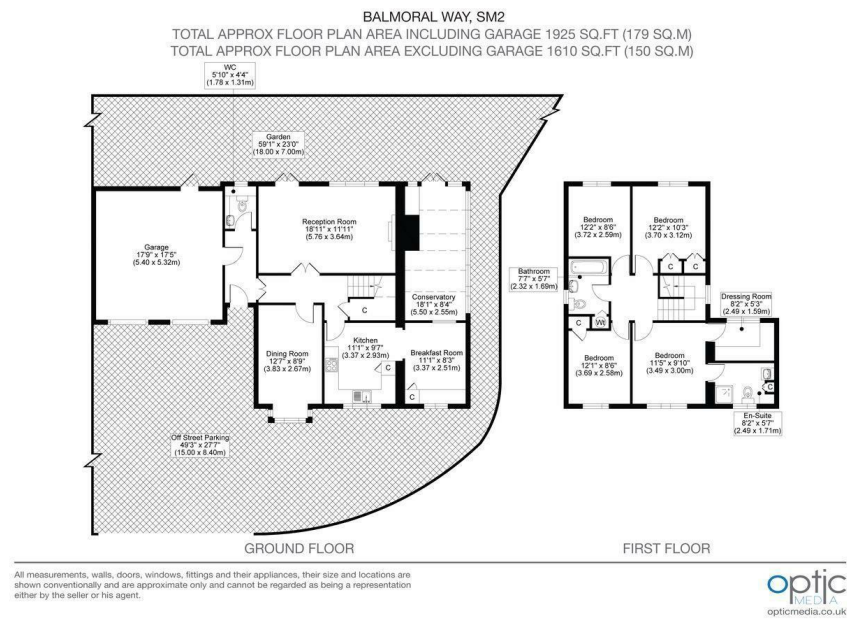

## Floor Plan



For illustration purposes only



All dimensions and measurements are approximate and for guidance only.

### *Just Centro's Opinion...*

Nestled in a quiet residential position on Balmoral Way, this impressive four-bedroom detached family home offers spacious and versatile accommodation, ideal for modern family living.

The ground floor comprises a generous living room alongside a separate reception room, providing flexible space for both entertaining and day-to-day family life. The well-appointed kitchen features a breakfast area perfect for informal dining and opens through to a bright conservatory overlooking the private rear garden. Further benefits include a double garage and a driveway providing off-street parking for two vehicles.

Upstairs, the principal bedroom benefits from a walk-in wardrobe and a modern ensuite shower room. There are three further well-proportioned bedrooms and a family bathroom, offering ample accommodation throughout.

The property has recently undergone a number of improvements, including a newly installed boiler and shower, new flooring in several rooms, and full redecoration, creating a fresh, modern, and well-presented home ready for immediate occupation.

## Additional Photos

