



## Mapesbury Road, NW2 £250,000

A bright studio apartment located in the sought after Mapesbury Conservation area. This property combines a modern contemporary feel with classic character and charm, whilst maintaining the building's original features. Benefits include a chain free sale and communal parking.

Mapesbury Road is located within close proximity to both Kilburn and Willesden Green underground stations (Jubilee line), making access into central London extremely convenient and direct. The Mapesbury Conservation area is renowned for its beautiful residential streets, making it a safe and welcoming area.

### Features

- Studio Apartment
- High Ceilings
- Modern Features
- Cast Iron Fireplace
- Communal Parking
- Chain Free

Mapesbury Road,  
London, NW2

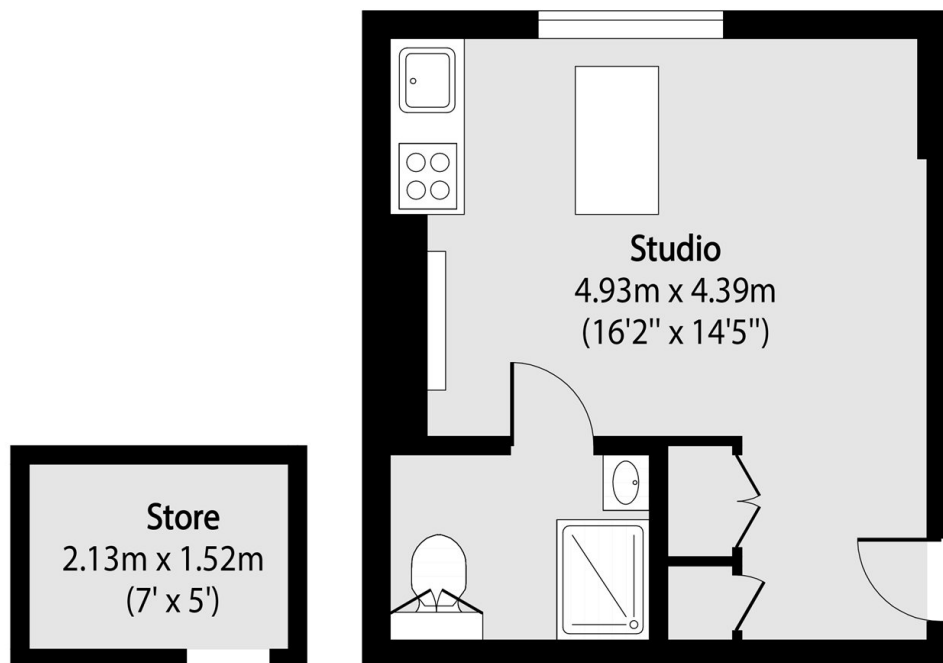

Total area (approx): 21.83 sq m (235 sq. ft)

Store total area (approx): 3.25 sq m (35 sq. ft)