



South Road, Bourne  
£600,000 **Freehold**

QUENTIN  
MARKS



# Key Features



- Large Family Home
- Conveniently Located
- 5 Bedrooms
- Large Ensuite
- Refitted Bathroom

Conveniently located within walking distance of Bourne Grammar School, this substantial and spacious 5 bedroomed detached family home offers versatile and well-appointed accommodation throughout and occupies a large plot of approaching a quarter of an acre.

The property boasts a generous principal bedroom with a large en suite, and there is a refitted family bathroom which serves the remaining 4 bedrooms. To the ground floor, multiple reception rooms provide excellent flexibility for modern family living. The spacious breakfast kitchen has been refitted in the kitchen area and is accompanied by a separate utility room.

The lounge is particularly impressive in size and features an attractive stone open fireplace, creating a warm focal point. This flows seamlessly into a delightful garden room/playroom at the rear





**Ground Floor**

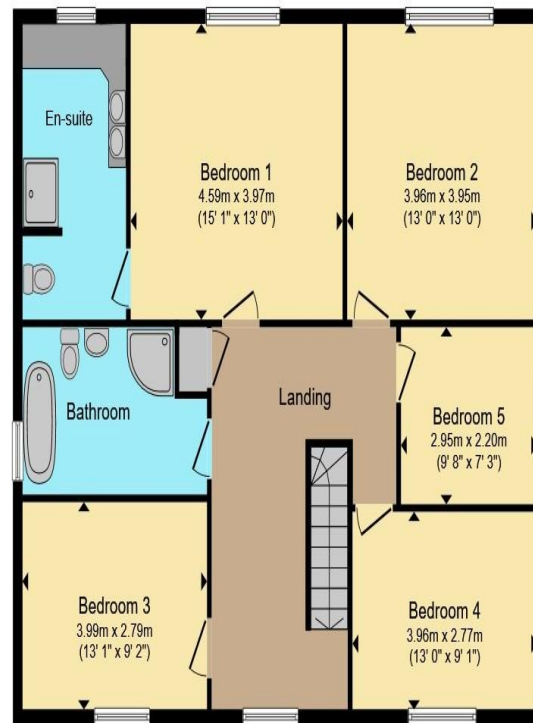

**First Floor**

Total floor area 229.8 sq.m. (2,473 sq.ft.) approx

This floor plan is for illustrative purposes only. It is not drawn to scale. Any measurements, floor areas (including any total floor area), openings and orientation are approximate. No details are guaranteed, they cannot be relied upon for any purpose and they do not form part of any agreement. No liability is taken for any error, omission or misstatement. A party must rely upon its own inspection(s). Powered by [www.PropertyBox.io](http://www.PropertyBox.io)



of the property. The exceptionally large reception hall provides access to a further family room or substantial study, ideal for those working from home. A refitted downstairs WC adds further convenience.

In addition, there is a highly versatile treatment room/hair salon, accessible either internally via the kitchen or independently through a separate external entrance. This space benefits from water supply and also houses the gas-fired central heating boiler, making it suitable for a variety of uses.

Externally, the property is approached via an in-and-out driveway providing ample parking for numerous vehicles and access to a double garage with an attached brick-built garden store. The rear garden is predominantly west-facing and generously proportioned, featuring a paved patio area, an extensive lawn, and a bark-chipped children's play area at the far end.

With its flexible layout, excellent outdoor space, and prime location close to Bourne Grammar School, this is an outstanding family home.

To view this property call Quentin Marks on:  
**01778 391600**

# Selling your property?

Contact us to arrange a **FREE** home valuation.

 01778 391600

 2 West Street, Bourne, Lincs, PE10 9NE

 [sales@quentinmarks.co.uk](mailto:sales@quentinmarks.co.uk)

 [www.quentinmarks.co.uk](http://www.quentinmarks.co.uk)



SCAN FOR MORE  
INFORMATION



Sharman Quinney Holdings Limited is registered in England and Wales under company number 4174227, Registered Office is Cumbria House, 16-20 Hockliffe Street, Leighton Buzzard, Bedfordshire, LU7 1GN. VAT Registration Number is 500 2481 05.

1: These particulars do not constitute part or all of an offer or contract. 2: The measurements indicated are supplied for guidance only and as such must be considered incorrect. 3: Potential buyers are advised to recheck the measurements before committing to any expense. 4: Sharman Quinney has not tested any apparatus, equipment, fixtures, fittings or services and it is the buyers interests to check the working condition of any appliances. 5: Sharman Quinney has not sought to verify the legal title of the property and buyers must obtain verification from their legal representative. 6: Intending purchasers will be asked to produce identification documentation at a later stage and we would ask your co-operation in order that there will be no delay in agreeing the sale. Ref: SQB100610 - 0005

