



# The Old Laundry, Glovers Road, Reigate

Guide Price £600,000 - £650,000





“

This is not just a home - it's a statement of design, luxury, and individuality. Set back from the road, beyond the gates lies a home that has been thoughtfully and thoroughly transformed into something truly special.

”



Guide Price £600,000- £650,000

Tucked away from the road and accessed via double gates and a private driveway, this unique residence opens into a peaceful private setting, creating a true oasis of calm just moments from everyday amenities.

This detached home has undergone a complete renovation, and is finished to a very high specification throughout. Every aspect has been enhanced with a keen eye for design and the results are a true feast for the senses.

At the heart of the home is an open-plan kitchen dining space, designed with entertaining and everyday living in mind. With a large sociable breakfast bar, integrated appliances, and elegant finishes, the kitchen flows seamlessly into a light-filled dining area where French doors open directly onto the south-facing garden.

The dining space flows into the stylish living room, offering a warm and inviting atmosphere. Whilst the layout is open plan, it has defined areas for living, dining, and entertaining. On the ground floor, you'll also find a spa-style shower room, thoughtfully designed with a serene, spa like feel—offering a tranquil space to relax. Upstairs there are two sumptuous, mezzanine bedrooms, one on each side of the property, allowing a good amount of seclusion.

Outside, there is a dropped kerb, providing parking for a small vehicle on the resin bonded driveway, as well as a second car across the driveway. The rear garden is secluded and peaceful, bathed in natural light from the Southerly aspect, it is the perfect space to unwind at the end of the day.



## Need to know

- GUIDE PRICE £600,000 - £650,000
- Detached period home with stylish, high end finishes throughout
- Open plan living which flows seamlessly together
- Perfect blend of character and contemporary with an elegant finish
- Striking exposed brick work wall and wooden beams
- High quality fittings including Karndean flooring, Quartz worktops, designed radiators, porcelain tiles, Vado bathroom hardware
- Fitted kitchen with built in appliances including a Smeg oven and Bosch dishwasher
- Secluded, low maintenance, landscaped front and rear gardens
- Feature staircases to mezzanine bedrooms
- Located just a short stroll from local shops at Lesbourne Road and Reigate town centre

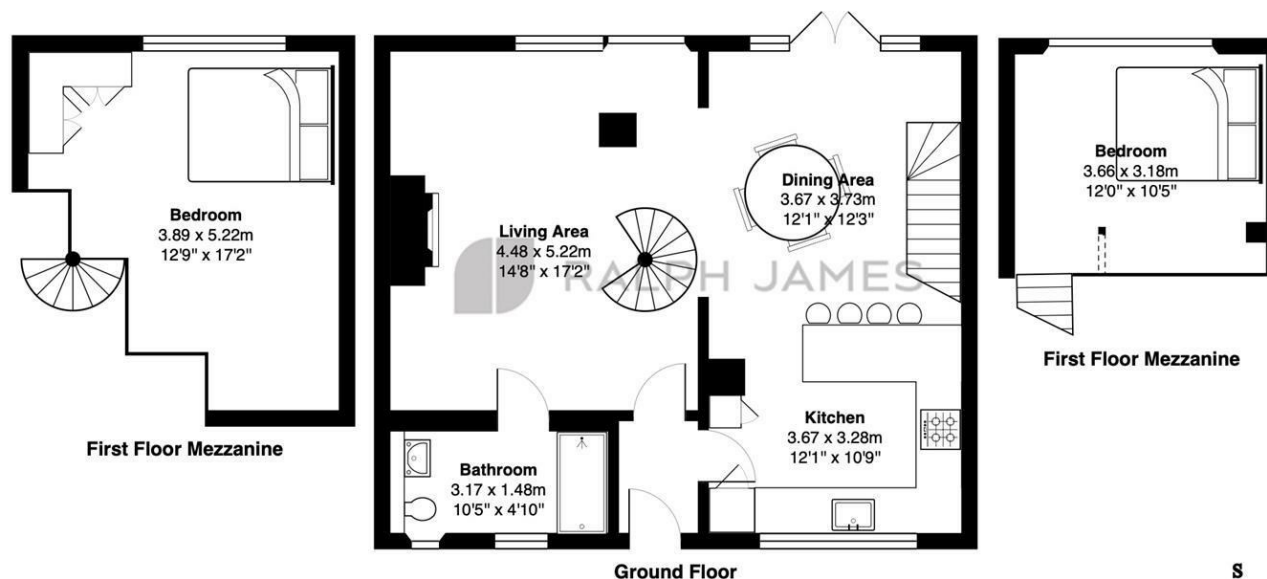

Glovers Road, Reigate

Total Area: 88.7 m<sup>2</sup> ... 954 ft<sup>2</sup>

FOR ILLUSTRATIVE PURPOSES ONLY.

Whilst every attempt has been made to ensure the accuracy of the floor plan shown, all measurements, positioning, fixtures, features, fittings and any other data shown are an approximate interpretation for illustrative purposes only and are not to scale.

No responsibility is taken for any error, omission, miss-statement or use of data shown.

The above statement applies to both 'Still Moving London LTD' and the Company or individual displaying this floor plan.

Unauthorised reproduction prohibited.

© Still Moving London LTD (www.stillmoving.london)

 RALPH JAMES

## Interested?

reigate@ralphjames.co.uk  
01737 333677

ralphjames.co.uk