

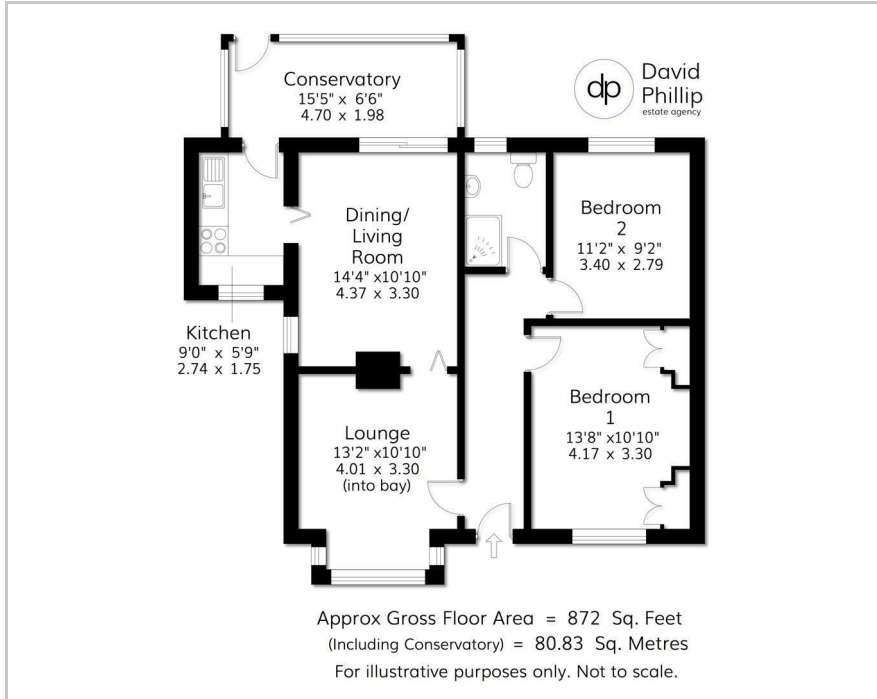

6 Park Mount, Otley, LS21 3BX
Price Guide £350,000

Floor Plan



Area Map

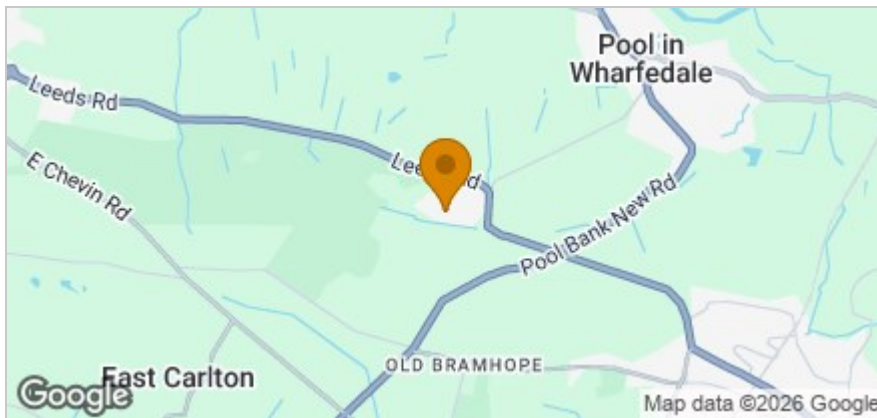

Accommodation

- A Delightfully Situated True Semi-Detached Bungalow
- Offering Two Double Bedrooms and Part Boarded Loft
- Lovely Semi-Rural Setting and Delightful Private Garden
- Offering Improvement Potential to suite Individuals' Needs
- Hamlet of Upper Old Pool Bank with Access onto Otley Chevin
- Off Street Parking for One Car
- Energy Performance Certificate (EPC) Rated F
- Freehold, Leeds City Council Tax Band D

Viewing

Please contact our David Phillip Estate Agents Office on 01134 676 400 if you wish to arrange a viewing appointment for this property or require further information.

Energy Efficiency Graph

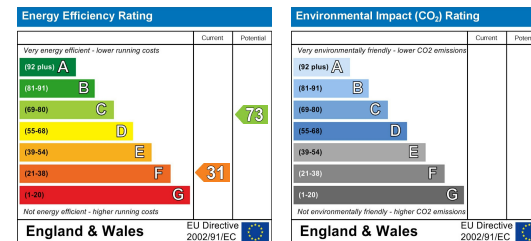

These particulars, whilst believed to be accurate are set out as a general outline only for guidance and do not constitute any part of an offer or contract. Intending purchasers should not rely on them as statements of representation of fact, but must satisfy themselves by inspection or otherwise as to their accuracy. No person in this firm's employment has the authority to make or give any representation or warranty in respect of the property.