

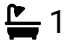



HOMES BY VICTORIA
ESTATE AGENCY

St. Peters Close, Redditch, B97 5LE

Offers In Region Of £310,000

 3  1  1



Welcome to St. Peter's Close, an exceptional home discreetly positioned within a quiet cul-de-sac in the highly desirable area of Crabbs Cross, Redditch. From the moment you arrive, the property exudes kerb appeal, approached via a beautifully landscaped fore-garden and an elegant paved driveway providing tandem parking for several vehicles.

[homesbyvictoria.co.uk](https://www.homesbyvictoria.co.uk)

victoria@homesbyvictoria | 07833 136521

FOR M HOMES MIDLANDS LIMITED trading as Homes By Victoria Company Number: 13688840 VAT no: 470190115



HOMES BY VICTORIA
ESTATE AGENCY



Key Features

- STUNNING & SPACIOUS FAMILY HOME
- LOCATED IN THE DESIRABLE AREA OF CRABBS CROSS
- IMMACULATE FRONT AND REAR GARDENS
- PORCH AND ENTRANCE HALLWAY
- BEAUTIFUL LOUNGE DINER WITH MULTI FUEL BURNER
- MODERN FAMILY BATHROOM
- THREE DOUBLE BEDROOMS
- OFF ROAD PARKING AND GARAGE
- EPC RATING D & COUNCIL TAX BAND C

Approx Gross Internal Area
91 sq m / 979 sq ft

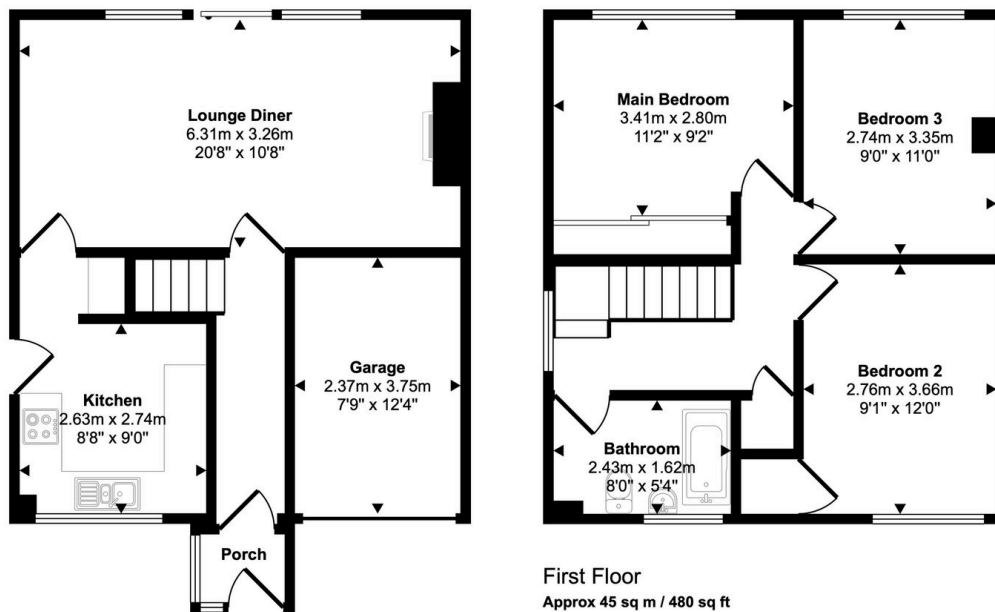

This floorplan is only for illustrative purposes and is not to scale. Measurements of rooms, doors, windows, and any items are approximate and no responsibility is taken for any error, omission or mis-statement. Icons of items such as bathroom suites are representations only and may not look like the real items. Made with Made Snappy 360.