

TAYLOR
MICHAEL

SALES & LETTINGS



2 Bed
Flat
located in

£1,200 Per month

TAYLOR
MICHAEL
SALES & LETTINGS



TAYLOR
MICHAEL
SALES & LETTINGS



TAYLOR
MICHAEL
SALES & LETTINGS



TAYLOR
MICHAEL

Lansdowne Place, Hove, BN3 1HG

Approximate Gross Internal Area = 65.9 sq m / 709 sq ft

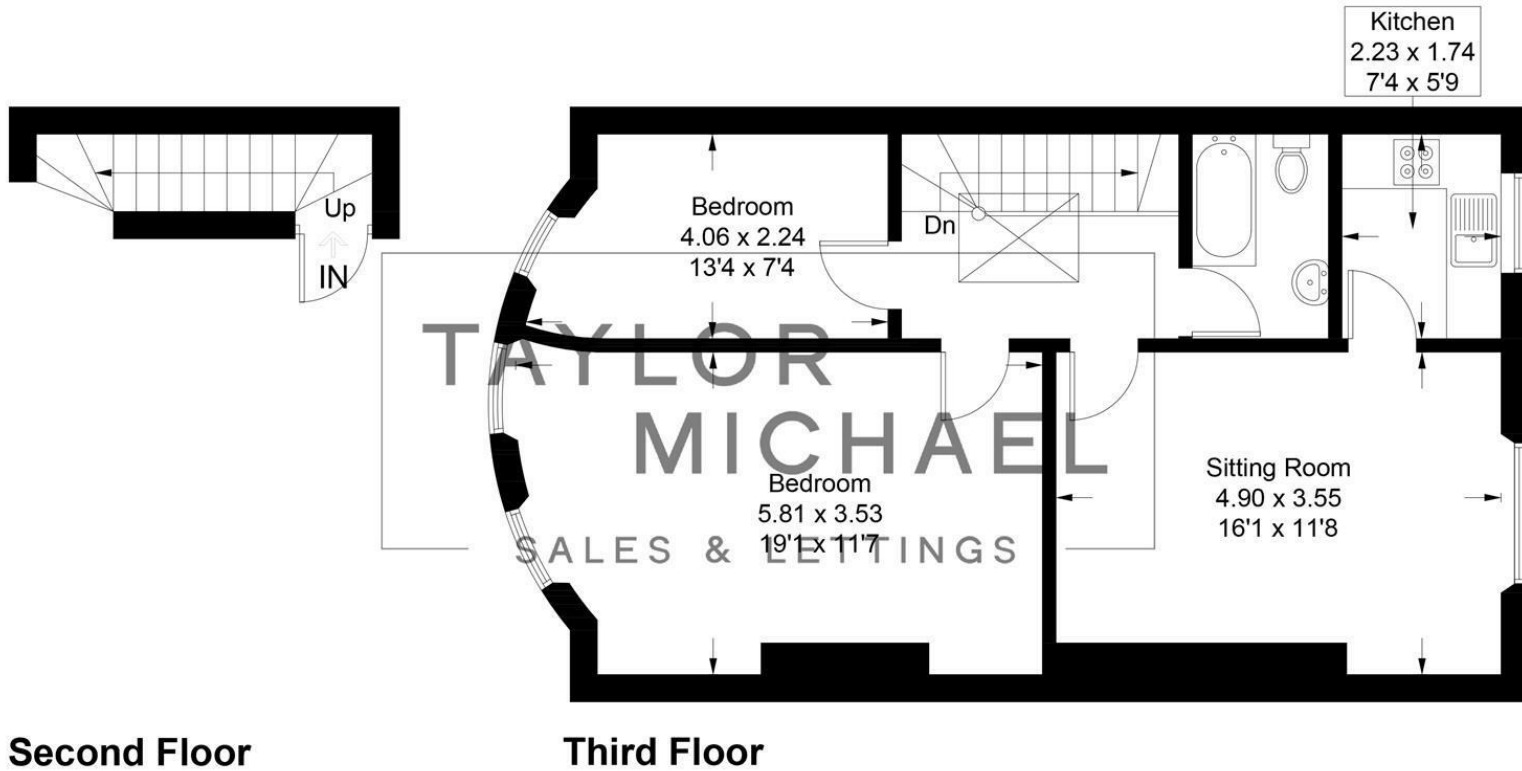

Second Floor

Third Floor

DIRECTIONS

CONTACT

62 Church Road
Hove
East Sussex
BN3 2FP

E: lettings@taylormichael.agency
T: 01273 600100
<https://taylormichael.agency/>

Illustration for identification purposes only, measurements are approximate, not to scale.
Imageplansurveys @ 2025

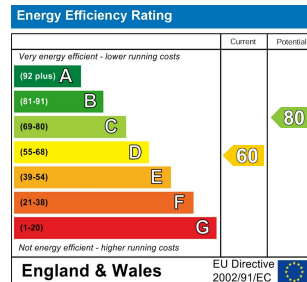

TAYLOR
MICHAEL