

# Frank Harris & Co.



## Foundling Court, Brunswick Centre, WC1N

£850,000

Discover this beautifully renovated two-bedroom home in the landmark Brunswick Centre, positioned on the sixth floor of Foundling Court and offering an inviting east-facing balcony.



Located only moments from Russell Square tube station, the property benefits from the extensive amenities of the Brunswick Centre below, offering a large Waitrose as well as a variety of shops, bars, and restaurants.

- Extended Lease • Two Double Bedrooms • Lift Access •
- Private Balcony • Chain Free • Brunswick Centre •





# Frank Harris & Co.

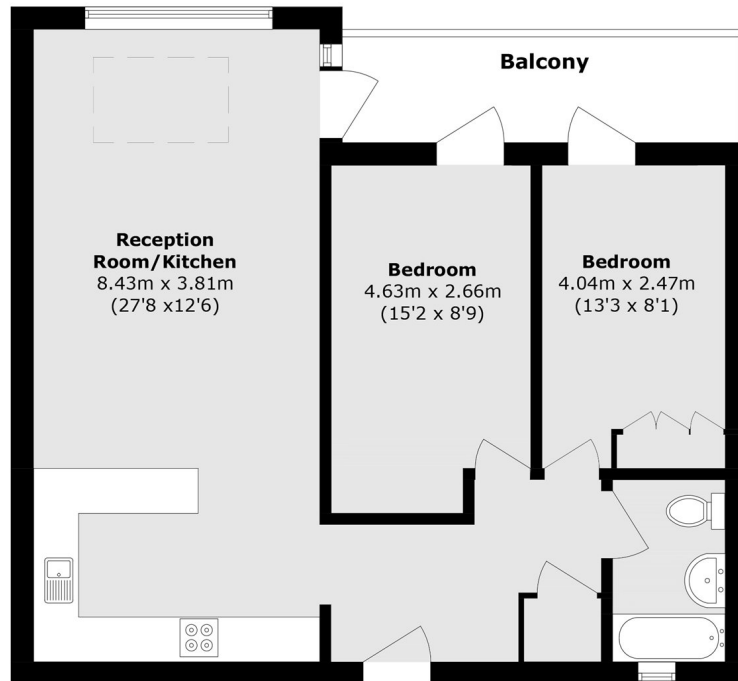

Total area (approx.): 67.4 sq. m (725.4 sq. ft)  
Balcony area (approx.): 9.0 sq. m (96.8 sq. ft)

Frank Harris & Co. Bloomsbury and Kings Cross  
81 Marchmont Street,  
London, WC1N 1AL  
020 7405 4444  
[bloomsburysales@frankharris.co.uk](mailto:bloomsburysales@frankharris.co.uk)

Energy Rating: . We aim to make our particulars both accurate and reliable. However they are not guaranteed; nor do they form part of an offer or contract. If you require clarification on any points then please contact us, especially if you're traveling some distance to view. Please note that appliances and heating systems have not been tested and therefore no warranties can be given as to their good working order.

