



## 159 Dover Road , Portsmouth, PO3 6JU

Guide price £280,000



# 159 Dover Road

, Portsmouth, PO3 6JU

Guide price £280,000



This beautifully presented three-bedroom terraced house in the sought-after area of Baffins offers a perfect blend of character and modern living, making it an ideal home for families and professionals alike. Thoughtfully modernised throughout, the property provides a stylish and comfortable environment while retaining a welcoming, homely feel.

Upon entering the property, you are greeted by a bright and inviting hallway, complete with convenient under-stairs storage, ideal for keeping everyday essentials neatly tucked away. To the front of the house, the spacious reception room benefits from a charming single bay window, allowing plenty of natural light to fill the space. A cosy log burner adds a focal point and enhances the warm, relaxing atmosphere, making it perfect for both entertaining guests and unwinding after a long day.

To the rear, the heart of the home is the impressive open-plan kitchen and dining area. This modern space has been designed with both functionality and style in mind, featuring a contemporary fitted kitchen, ample worktop space, and a practical breakfast bar, perfect for casual dining or morning coffee. The dining area seamlessly connects to the conservatory, enhancing the sense of space and providing an excellent flow for modern living.

The conservatory offers a versatile additional reception area with lovely views over the garden, making it an ideal spot for a sitting area, playroom, or home office. It also benefits from a convenient W/C and a separate area that has been plumbed, offering excellent potential to be used as a utility space.

Externally, the rear garden is mainly laid to lawn, providing a great outdoor space for families, gardening enthusiasts, or summer entertaining. To the front, the property features a forecourt and single bay frontage, adding to its kerb appeal.

Upstairs, the property continues to impress with three well-proportioned double bedrooms, offering flexibility for growing families or those needing additional workspace. Each room is bright and airy, creating comfortable and restful spaces. The accommodation is completed by a modern family bathroom, fitted with contemporary fixtures and finishes.

Overall, this superb home combines modern updates with practical living spaces in a popular and convenient location. With its generous layout, stylish interior, and versatile features, it presents a fantastic opportunity for anyone looking to move straight into a well-appointed property in Baffins.



## Road Map

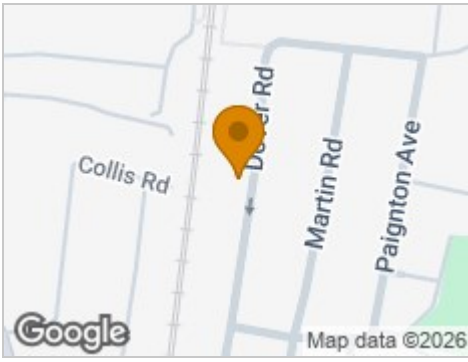

## Hybrid Map



## Terrain Map



## Floor Plan

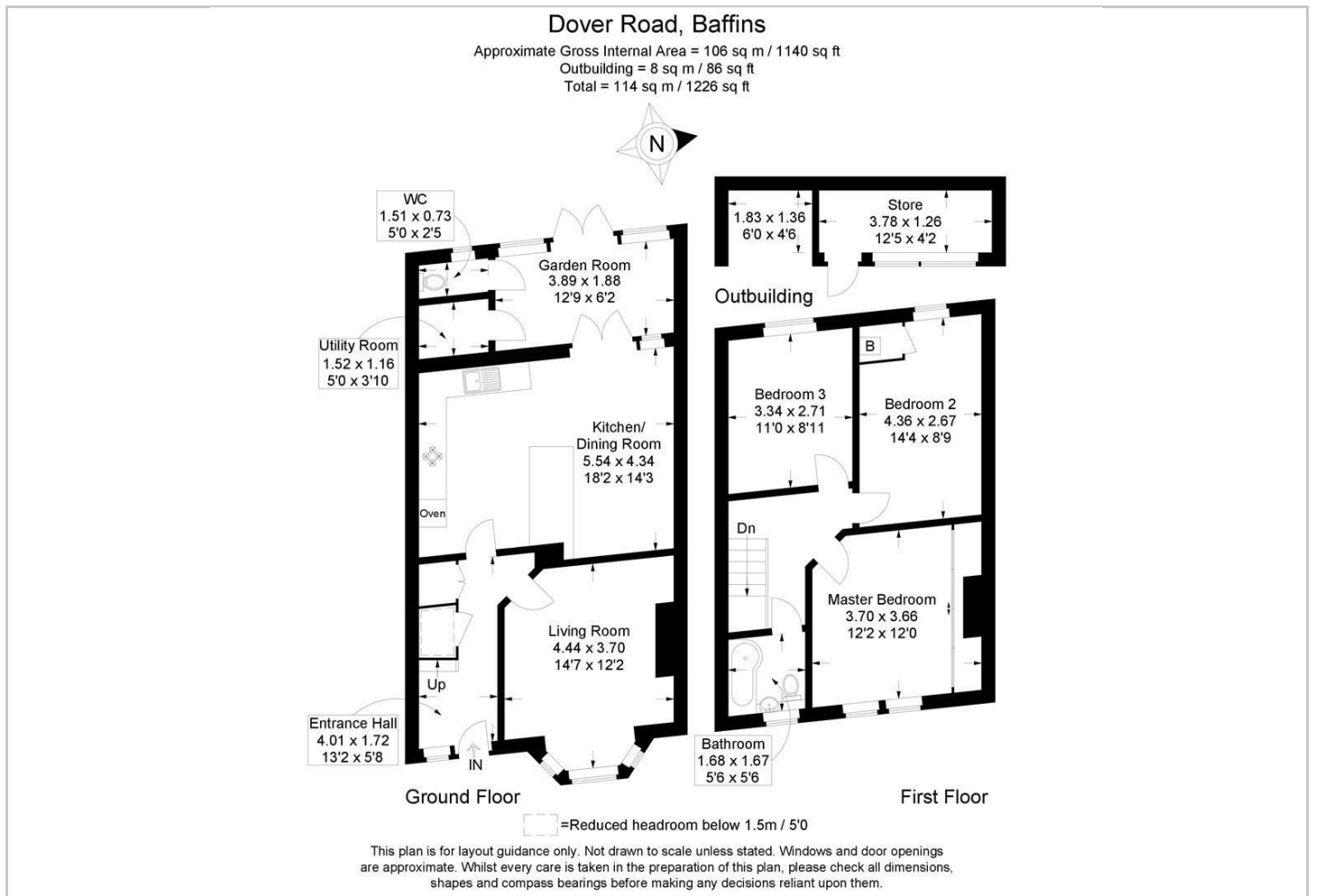

## Viewing

Please contact our Central Office on 02394 217317 if you wish to arrange a viewing appointment for this property or require further information.

## Energy Efficiency Graph

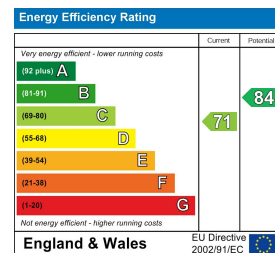

These particulars, whilst believed to be accurate are set out as a general outline only for guidance and do not constitute any part of an offer or contract. Intending purchasers should not rely on them as statements of representation of fact, but must satisfy themselves by inspection or otherwise as to their accuracy. No person in this firm's employment has the authority to make or give any representation or warranty in respect of the property.