



Flat 13 Arabella Court, 176 London Road, Portsmouth, PO2 9DP

£875 PCM Council Tax Band B Deposit £1,009



**Tully's**

## Floor Plan

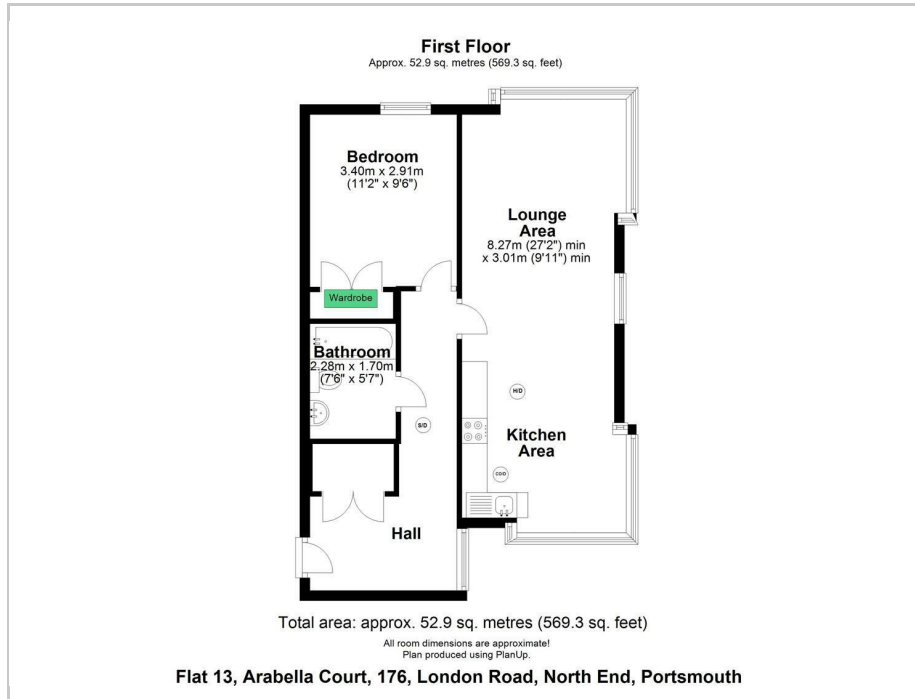

## Area Map



## Accommodation

- Holding Deposit – £173
- Deposit -- £865
- Council Tax Band – B
- 1 Bedroom
- Modern Property
- Gas Central Heating
- Double Glazing

## Viewing

Please contact our Southsea Office on 023 9273 2241 if you wish to arrange a viewing appointment for this property or require further information.

## Energy Efficiency Graph

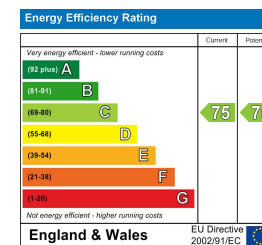

157-159 Albert Road, Southsea, Portsmouth, Hampshire, PO4 0JW  
023 9273 2241 Email: tully@tullyand.co lettings@tullyand.co

**Tully's**