



21 Harrison Croft Gilberdyke HU15 2GW

£259,950
FREEHOLD

A beautifully presented, three storey townhouse, located on Harrison Croft, a sought after cul-de-sac on the edge of the village of Gilberdyke. The property offers extremely well appointed accommodation over three floors, extending to approx 1580 sq ft and briefly comprises, an open plan kitchen/dining room on the ground floor with French doors leading out to the rear garden along with a handy downstairs w/c and utility room. The first floor offers a spacious living room, family bathroom and two bedrooms, which could easily be utilised as offices for those that work from home. The second floor boasts two double bedrooms both with en-suites and Velux windows letting in plenty of light. Externally there is an attractive rear garden together with a single garage and parking area to the front, together with additional visitor parking spaces. The property is on the outskirts of Gilberdyke and located next to a delightful pond making it an ideal, peaceful location. A viewing is highly advised to appreciate this spacious home.

EPC: B



Ground Floor

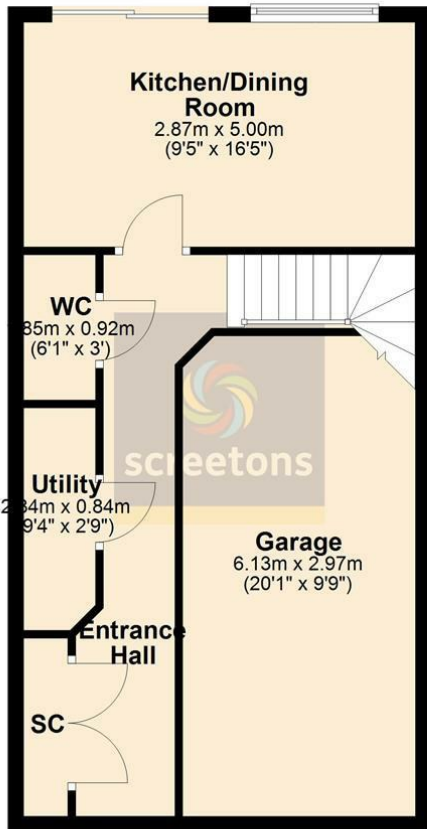

First Floor

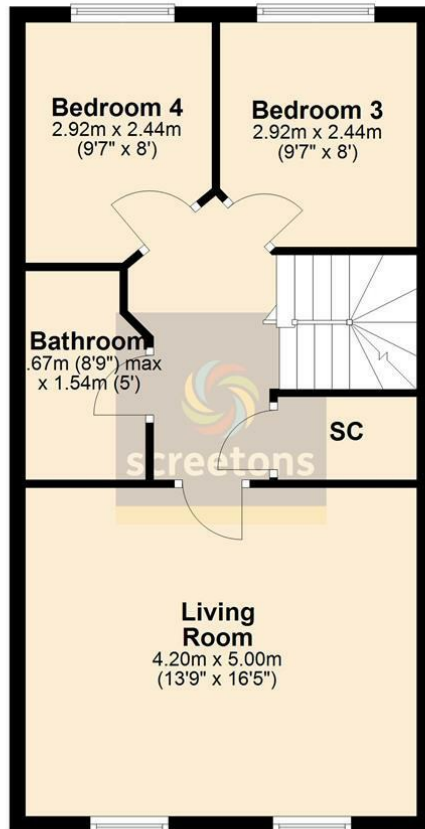

Second Floor

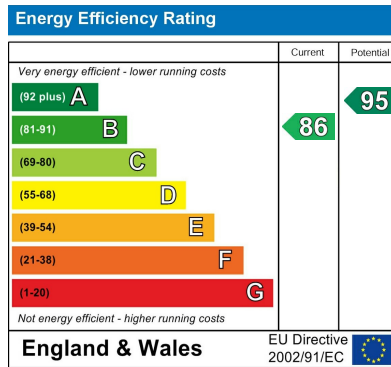
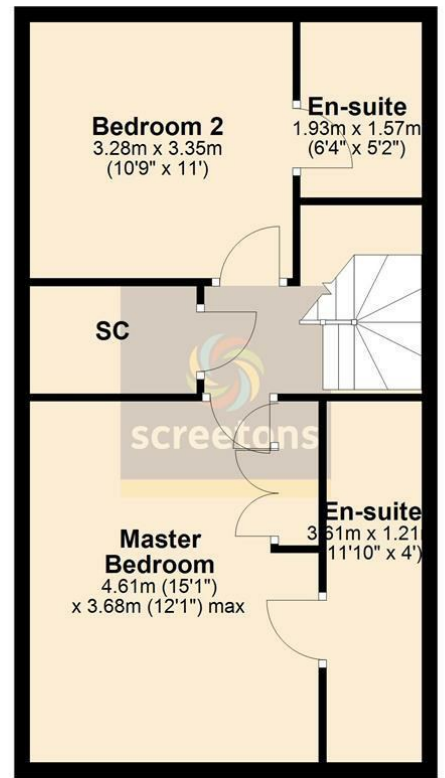

Agents Note: Whilst every care has been taken to prepare these particulars, they are for guidance purposes only. All measurements are approximate and are for general guidance purposes only and whilst every care has been taken to ensure their accuracy, they should not be relied upon and potential buyers/tenants are advised to recheck the measurements

Howden Office Sales
25 Bridgegate
Howden
East Yorkshire
DN14 7AA

01430 431201
howden@screetons.co.uk
www.screetons.co.uk

