



ABERDEEN COURT, W9

£3,000 per month

Situated on the fourth floor of a prestigious portered Edwardian mansion block, this two-bedroom apartment benefits from bright modern interiors, high ceilings and period features. The stylish apartment comprises a large

Two bedrooms
Two bathrooms

Private balcony
Portered building

STEP INSIDE ABERDEEN COURT

Aberdeen Court, W9

APPROX. GROSS INTERNAL FLOOR AREA 710 SQFT / 65.96 SQM

Key :
CH - Ceiling Height

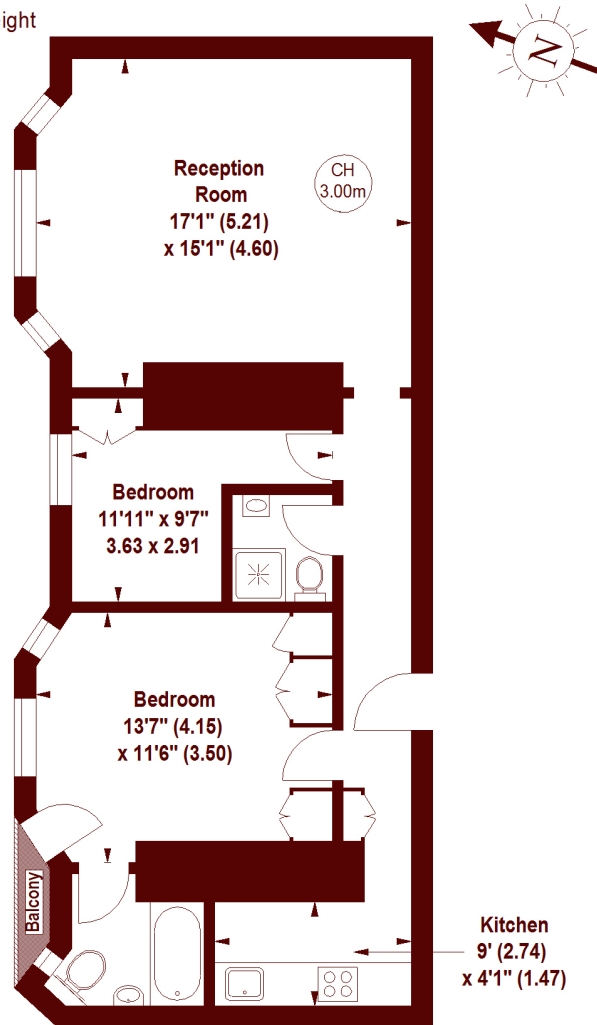

FOURTH FLOOR

The floor plan is not to scale and measurements and areas shown are approximate and therefore should be used for illustrative purposes only. The plan has been prepared in accordance with the RICS code of Measuring Practice and whilst we have confidence in the information produced, it must not be relied on.

If there is any aspect of particular importance, you should carry out or commission your own inspection of the property.

Copyright of FeaturePRO.

Little Venice
020 7993 3060

Energy Rating: We aim to make our particulars both accurate and reliable. However, they are not guaranteed; nor do they form part of an offer or contract. If you require clarification on any points then please contact us, especially if you're traveling some distance to view. Please note that appliances and heating systems have not been tested and therefore no warranties can be given as to their good working order

MARSH &
PARSONS