



## NORMANDY PLACE, W12

£365,000

Set within a quiet, well-maintained development, this well-presented one-bedroom flat offers bright, modern living with a spacious open-plan layout, a private balcony overlooking the London rooftops; ideal for both

One Bedroom  
Private Balcony  
Lift

Third Floor  
No Onwards Chain  
Westfield Shopping Centre

# STEP INSIDE NORMANDY PLACE

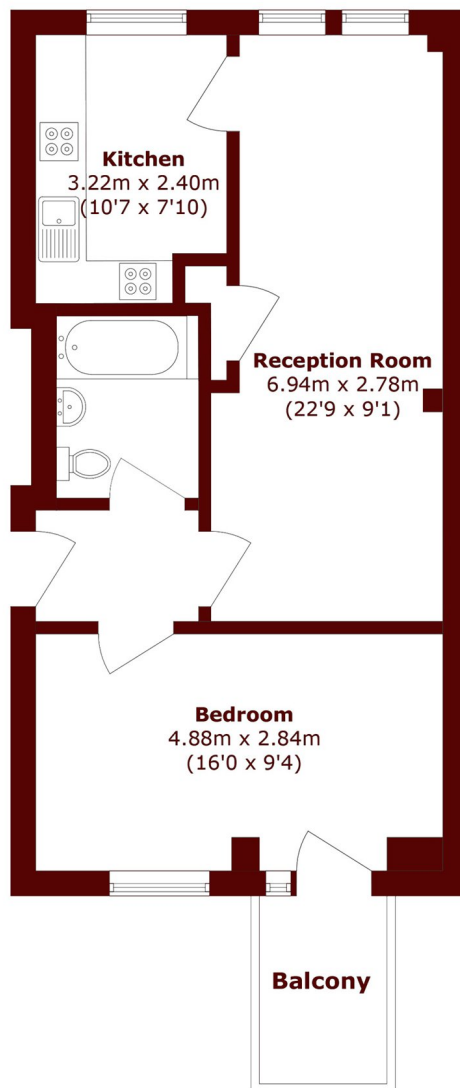

Total area (approx.): 48.0 sq. m (516.6 sq. ft)  
Balcony area (approx.): 3.4 sq. m (36.5 sq. ft)

**Brook Green**  
020 7605 7765

Energy Rating: We aim to make our particulars both accurate and reliable. However, they are not guaranteed; nor do they form part of an offer or contract. If you require clarification on any points then please contact us, especially if you're traveling some distance to view. Please note that appliances and heating systems have not been tested and therefore no warranties can be given as to their good working order

**MARSH &  
PARSONS**