



## 7 Lambton Court

, Peterlee, SR8 1NG

**Offers Over £450,000**



Situated on a large corner plot in one of the most sought after areas of Peterlee Lambton Court, this impressive detached house offers a perfect blend of space, style, and comfort. Boasting four/five generously sized bedrooms, this home has been thoughtfully extended to create an inviting living environment. The property features three well-appointed bathrooms, ensuring convenience for families or guests.

As you enter, you are greeted by a stunning open staircase which is one of many features in addition to the granite integrated kitchen that seamlessly flows into a spacious living area, making it an ideal space for entertaining or family gatherings. In addition to the kitchen, the home includes four reception rooms, providing ample space for relaxation and leisure. Originally designed as a five-bedroom property, the layout has been cleverly adapted to enhance living space, with the option to easily convert it back to five bedrooms if desired.

The exterior of the home is equally impressive, featuring a large garden that offers a tranquil retreat for outdoor activities or simply enjoying the fresh air. A standout feature of the property is the expansive garden room and bar area at the rear, perfect for hosting friends or unwinding after a long day.

With a three-car driveway, parking is never a concern, making this home not only practical but also a true gem in the heart of Oakerside, Peterlee. This property is a must-see for those seeking a spacious family home with modern amenities and a beautiful outdoor space.





Area Map



Floor Plan

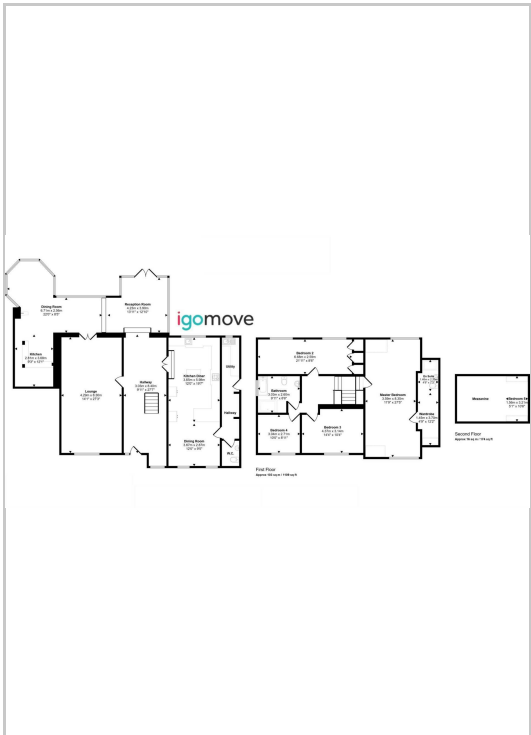

Energy Efficiency Graph

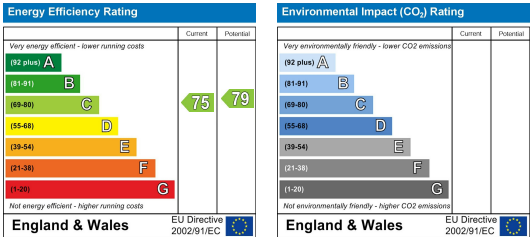

These particulars, whilst believed to be accurate are set out as a general outline only for guidance and do not constitute any part of an offer or contract. Intending purchasers should not rely on them as statements of representation of fact, but must satisfy themselves by inspection or otherwise as to their accuracy. No person in this firms employment has the authority to make or give any representation or warranty in respect of the property.