



Motor Walk, Colchester, CO4 5SP

£1,400 Per month



Motor Walk, Colchester, CO4 5SP

£1,400 Per month



Some More Information

The property opens into an entrance hallway with stairs rising to the first floor and access into the main living accommodation.

To the front is the kitchen, fitted with a range of wall and base units, integrated cooking appliances and space for additional appliances. At the rear of the property is the main lounge, which is a bright and comfortable living space with French doors opening directly onto the garden. There is also useful understairs storage and enough room to comfortably accommodate both living and dining furniture. The ground floor also benefits from a cloakroom with WC and wash hand basin.

Upstairs, there are two well-proportioned bedrooms and a family bathroom fitted with a bath and shower over, WC and wash hand basin. The main bedroom sits across the front of the property, whilst the second bedroom overlooks the rear garden and includes fitted storage.

Overall, the house offers a straightforward and practical layout that feels easy to maintain, with good natural light throughout and comfortable living space both upstairs and down.

Externally

The property benefits from a private rear garden which has been designed to remain relatively low maintenance, whilst still providing enough space for outdoor seating and day-to-day use during the warmer months.

To the rear, there is allocated parking alongside a garage providing useful additional storage space. Please note the garage does not have power connected.

To the front of the property, there is a communal green and play park area, helping give the position a more open residential feel and making it well suited to those looking for a quieter setting away from busier main roads.

Location

The property is positioned within a well-connected part of Colchester, giving convenient access to a wide range of everyday amenities and transport links.

A number of well-regarded primary and secondary schools are located nearby, making the area particularly popular with families, whilst Colchester North Station is within easy reach for those needing regular access into London Liverpool Street and surrounding areas.

Colchester General Hospital is also close by, alongside regular bus routes connecting across the city and neighbouring districts.

For day-to-day convenience, there are nearby shops, supermarkets

and local amenities, whilst the surrounding area also offers a number of well-known pubs, restaurants and golf courses, helping provide a good balance between practicality and lifestyle.

Living / Dining Room

12'3" x 8'8" (3.73m x 2.64m)

Kitchen

9'8" x 5'3" (2.95m x 1.60m)

W/C

Bedroom One

12'3" x 8'7" (3.73m x 2.62m)

Bedroom Two

12'3" x 7'8" (3.73m x 2.34m)

Family Bathroom

Services

Council Tax Band - C

Local Authority - Colchester City Council

EPC - C

Gas Central Heating

Mains Electric

Mains Water

Mains Drainage

Broadband Availability - Ultrafast broadband via County Broadband, Openreach and Nexfibre with speeds to 2000mbs (May 2026).

Mobile Coverage - It is understood that the best available mobile service in the area is provided by EE (details obtained from Ofcom Mobile and Broadband Checker) – May 2026.

- Two Bedroom Terraced House
- French Doors From Lounge
- Garage & Allocated Parking
- Well Maintained Throughout

- Private Rear Garden
- Ground Floor Cloakroom
- Modern Kitchen & Bathroom
- Convenient Access To Local Amenities & Transport Links



GROUND FLOOR

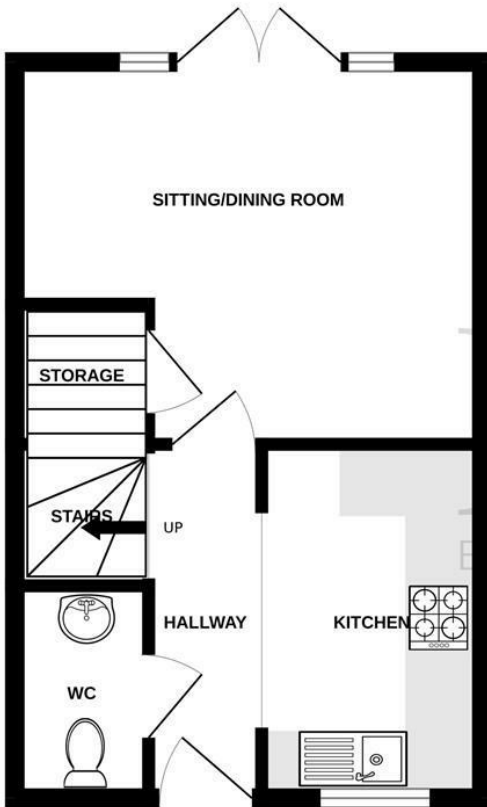

1ST FLOOR

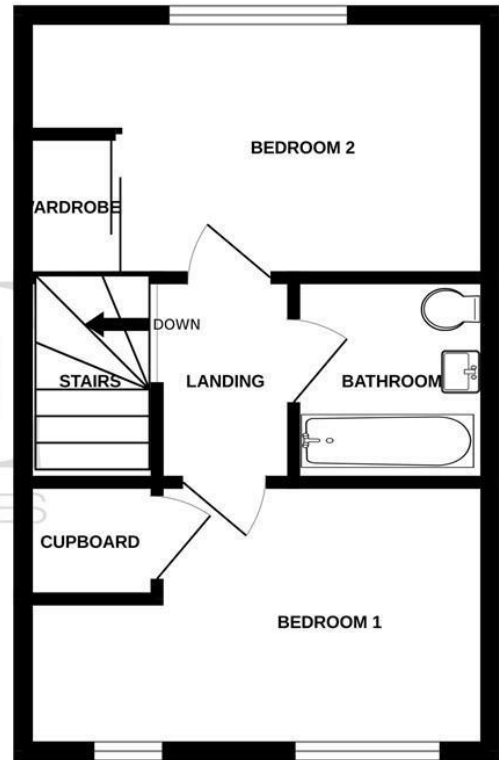

Whilst every attempt has been made to ensure the accuracy of the floorplan contained here, measurements of doors, windows, rooms and any other items are approximate and no responsibility is taken for any error, omission or mis-statement. This plan is for illustrative purposes only and should be used as such by any prospective purchaser. The services, systems and appliances shown have not been tested and no guarantee as to their operability or efficiency can be given.
Made with Metropix ©2026

| Energy Efficiency Rating | | Current | Potential |
|---|--|-------------------------|-----------|
| Very energy efficient - lower running costs | | | |
| (92 plus) A | | | 92 |
| (81-91) B | | | |
| (69-80) C | | | 77 |
| (55-68) D | | | |
| (39-54) E | | | |
| (21-38) F | | | |
| (1-20) G | | | |
| Not energy efficient - higher running costs | | | |
| England & Wales | | EU Directive 2002/91/EC | |

| Environmental Impact (CO ₂) Rating | | Current | Potential |
|---|--|-------------------------|-----------|
| Very environmentally friendly - lower CO ₂ emissions | | | |
| (92 plus) A | | | |
| (81-91) B | | | |
| (69-80) C | | | |
| (55-68) D | | | |
| (39-54) E | | | |
| (21-38) F | | | |
| (1-20) G | | | |
| Not environmentally friendly - higher CO ₂ emissions | | | |
| England & Wales | | EU Directive 2002/91/EC | |

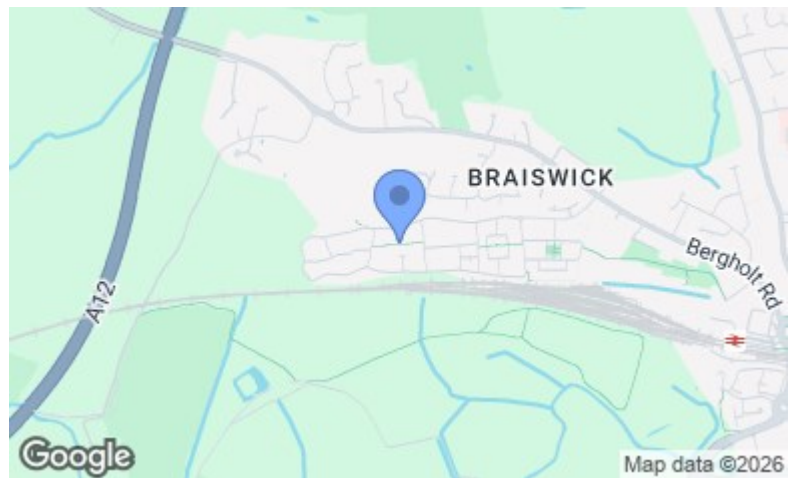

These particulars, whilst believed to be accurate are set out as a general outline only for guidance and do not constitute any part of an offer or contract. Intending purchasers should not rely on them as statements of representation of fact, but must satisfy themselves by inspection or otherwise as to their accuracy. No person in this firm's employment has the authority to make or give any representation or warranty in respect of the property.