

TOTAL APPROX. FLOOR AREA 426 SQ.FT. (39.6 SQ.M.)

Whilst every attempt has been made to ensure the accuracy of the floor plan contained here, measurements of doors, windows, rooms and any other items are approximate and no responsibility is taken for any error, omission, or mis-statement. This plan is for illustrative purposes only and should be used as such by any prospective purchaser. The services, systems and appliances shown have not been tested and no guarantee as to their operability or efficiency can be given

Made with Metropix ©2019

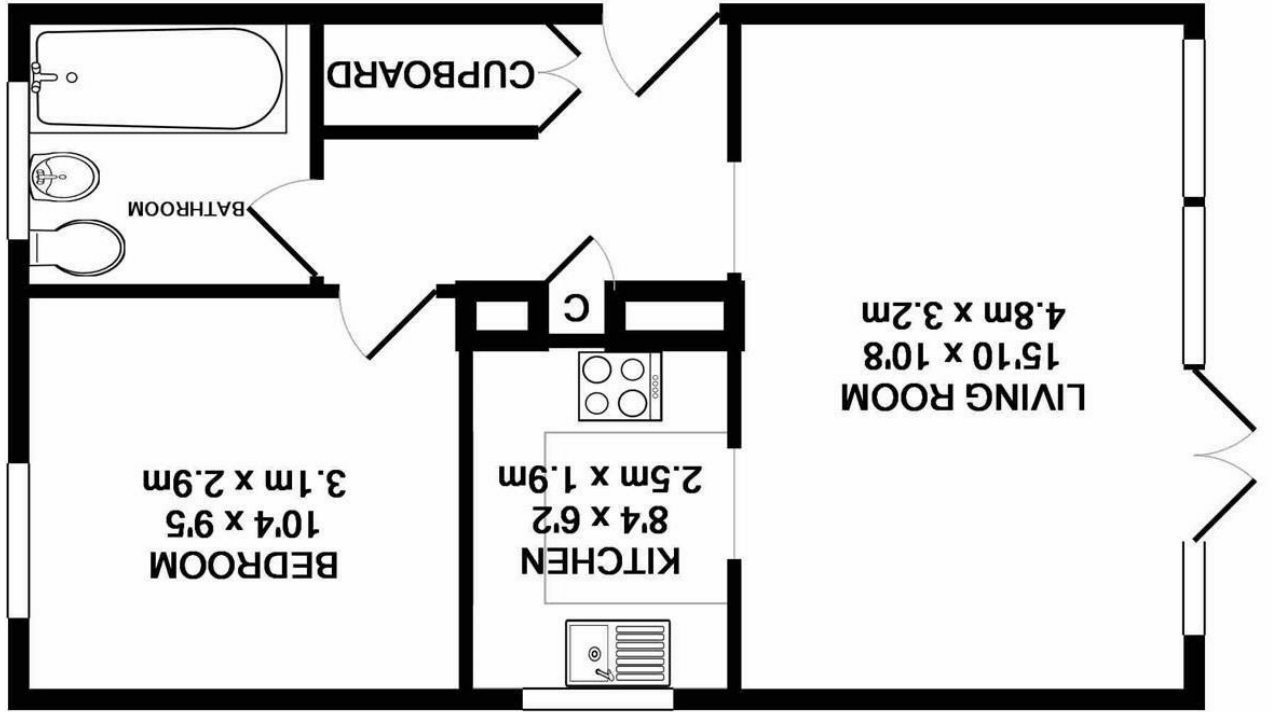



Property Description

A charming and modern one-bedroom ground-floor apartment with a large private patio garden situated in a popular development in the heart of the City centre a short walk from the train station and all the amenities of the City. The property would suit a professional couple or a single person.



Private entrance

Inner entrance hallway

Large living room

Fitted kitchen with appliances

Contemporary bathroom suite

Private patio garden

Residents parking space

Council tax band C

EPC rating C



Rental Fees

If you are interested in renting this property then it is important you contact Daniels Estate Agents as soon as possible as other tenants may be interested too. Daniels will need you to provide certain information in order for us to discuss your potential tenancy with your new landlord. Once we have the initial agreement from the landlord to proceed with your application you will then be sent an e-mail confirming the proposed terms.

We will then need all tenants to be fully referenced by 'Rightmove Referencing' who will carry out the referencing and a credit check process on our behalf, you will need to pay the equivalent of one week's rent as a holding deposit.

Due to a change in legislation with effect from 1st June 2019 agents will no longer be able to charge tenants for this process. The same legislation also sets out that deposit amounts will be capped at five weeks' rent.

It is important that all information provided for reference purposes is accurate as if a tenant fails Right to Rent checks or the referencing process, having provided false or misleading information, the holding deposit will not be returned.

The holding deposit will also be retained by Daniels if the tenant withdraws from the proposed tenancy or fails to take reasonable steps to enter into the tenancy.

Prior to the commencement of any tenancy, Daniels Estate Agents will need to have received the first month's rent plus four weeks' rent to add to the one week's rent holding deposit (five weeks' rent in total).

