



**GASCOIGNE
HALMAN**

HILL VIEW AVENUE, HELSBY, FRODSHAM

THE AREAS LEADING ESTATE AGENT



HILL VIEW AVENUE, HELSBY, FRODSHAM

£235,000

A traditional, 1930's built bay fronted semi-detached house in a popular area of Helsby, close to local shops and facilities.

Built by renowned local builders, Clare and Ryder in the 1930's, this is a house with enduring appeal and attractive kerb appeal. Hill View Avenue is a particularly popular road in Helsby with many homes often remaining in long term ownership with many also being extended and subject to significant investment over the years.





DESCRIPTION

The layout includes an entrance hallway, a spacious and light through lounge/dining room and a fitted kitchen. The first floor offers three bedrooms and a bathroom that has modern fittings and tiling. The property has double glazed windows and a gas fired central heating system is installed. There is a wide frontage with plenty of parking. The enclosed rear garden includes patio area and lawn plus a number of mature cherry blossom trees.

LOCATION

The property is situated within a sought after area of Helsby, convenient for access to local facilities and shops including a Tesco supermarket. The house is also within a few minutes walk from Horns Mill Primary School and close to open countryside. The road, rail and motorway networks allow daily commuter access to many part of the North West including Chester, Warrington, Liverpool and Manchester.

TENURE

Freehold.

COUNCIL TAX

Band C. Cheshire West & Chester.

EPC RATING

Current D.

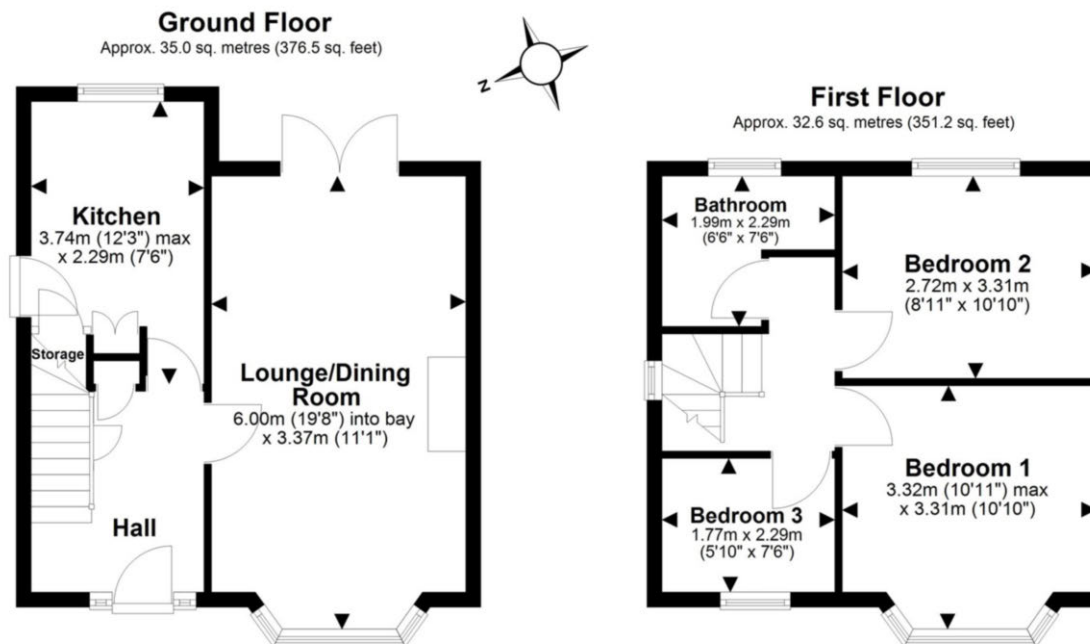

Total area: approx. 67.6 sq. metres (727.7 sq. feet)

NOTICE Gascoigne Halman for themselves and for the vendors or lessors of this property whose agents they are give notice that: (i) the particulars are set out as a general outline only for the guidance of intending purchasers or lessees, and do not constitute, nor constitute part of, an offer or contract; (ii) all descriptions, dimensions, references to condition and necessary permissions for use and occupation, and other details are given in good faith and are believed to be correct but any intending purchasers or tenants should not rely on them as statements or representations of fact but must satisfy themselves by inspection or otherwise as to the correctness of each of them; (iii) no person in the employment of Gascoigne Halman has any authority to make or give any representation or warranty whatever in relation to this property.

FRODSHAM OFFICE

01928 739777

frodsham@gascoignehalman.co.uk

Pollard Buildings, Church Street, Frodsham, WA6 7DW

**GASCOIGNE
HALMAN**