

Martello Court, Flat 23, 3-15, Jevington Gardens, Eastbourne, East Sussex  
Approximate Gross Internal Area  
48 Sq M/517 Sq Ft

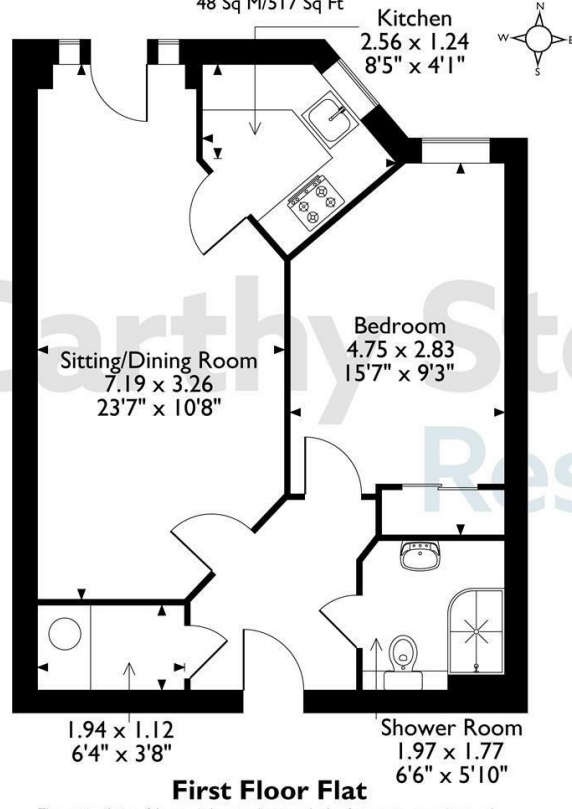

The position & size of doors, windows, appliances and other features are approximate only.  
© ehouse. Unauthorised reproduction prohibited. Drawing ref. dig/8672578/DST.

**23 Martello Court**

Jevington Gardens, Eastbourne, BN21 4SD



**Council Tax Band: B**



Energy Efficiency Rating		
	Current	Potential
Very energy efficient - lower running costs		
(92 plus) <b>A</b>		
(81-91) <b>B</b>	<b>88</b>	<b>88</b>
(69-80) <b>C</b>		
(55-68) <b>D</b>		
(39-54) <b>E</b>		
(21-38) <b>F</b>		
(1-20) <b>G</b>		
Not energy efficient - higher running costs		
<b>England &amp; Wales</b>	EU Directive 2002/91/EC	

**Asking price £160,000 Leasehold**

A SUPERB one double bedroom retirement apartment situated on the FIRST FLOOR. The apartment features a FITTED KITCHEN, though lounge dining room with JULIETTE BALCONY boasting LOVELY VIEWS, one double bedroom with a fitted mirrored wardrobe, a wet room style shower room, underfloor heating and a 24 hour Careline system.

Martello Court is an age exclusive development for the over 60's situated within close proximity to the SEA FRONT. Residents benefit from a range of lifestyle features, to include; a Communal Lounge where SOCIAL EVENTS take place, a GUEST SUITE for visiting family and friends, and MORE!

**Call us on 0345 556 4104 to find out more.**

resales@mccarthyandstone.co.uk | mccarthyandstoneresales.co.uk

This floor plan is not drawn to scale and is for illustrative purposes only. Any measurements, floor areas (including any total floor area), openings and orientation are approximate and for guidance only. McCarthy Stone Resales do not take liability for any error, omission or misstatement. All parties must rely on their own inspections. It should not be assumed that any furniture or fittings contained in the photographs are included in any sale. All details referring to time and distances to localities are approximate. Details regarding any common charges and other applicable fees are provided by the seller and should not be relied on without verification and further checks made through a solicitor/conveyancer. Please contact the Property Consultant for further information that Appliances (including central heating) have not been tested, therefore it cannot be assumed that they are in good working order. All interested parties are advised to check availability and make an appointment before travelling to view the property to avoid disappointment or wasted time or travel expenses. The details contained within this brochure are for information purposes only and do not form part of any agreement. All purchases will be subject to contract terms. © All artwork (photos and floorplans) and written content are the sole property and copyright of McCarthy & Stone Resales Limited and are legally protected by UK & International copyright laws. Under no circumstance may you download, reproduce, publish or distribute any content for commercial purposes, without prior written permission from McCarthy Stone Resales. Unauthorised reproduction is prohibited.



# Martello Court, Jevington Gardens, Eastbourne

## Summary

Martello Court was built by McCarthy & Stone purpose built for retirement living. The development consists of one and two-bedroom retirement apartments for the over 60s. There is a House Manager on site and a 24-hour emergency call system provided via a personal pendant alarm and with call points in the bathroom.

The apartment features a fully fitted kitchen, lounge, bedroom, bathroom underfloor heating and 24 hour Careline system. The development includes a Homeowners' lounge and landscaped gardens. There is a guest suite for visitors who wish to stay (additional charges apply). A car parking – permit scheme applies, check with the House Manager for availability.

The dedicated House Manager is on site during working hours to oversee the smooth running of the development. The service charge covers the cost of all external maintenance, gardening and landscaping, external window cleaning, buildings insurance, water rates and security systems. All energy costs of the laundry room, homeowners lounge and other communal areas are also covered in the service charge. For your peace of mind the development has camera door entry and 24-hour emergency call systems, should you require assistance. The Homeowners' lounge provides a great space to socialise with friends and family. If your guests have travelled from afar, they can extend their stay by booking into the development Guest Suite (fees apply - subject to availability).

The property is located in an ideal location within close proximity to local shops and amenities and within walking distance to the seafront. Eastbourne's nearby Town Centre caters for everyone with its extensive shopping facilities, restaurants, bars, and mainline train station with great links to London and Brighton.

It is a condition of purchase that residents must meet the age requirement of 60 years or over.

## Entrance Hall

Front door with spy hole leads to the large entrance hall - the 24-hour Tunstall emergency response pull cord system is situated in the hall. From the hallway there is a door to a walk-in

storage cupboard/airing cupboard. Illuminated light switches, smoke detector, apartment security door entry system with intercom and emergency pull cord located in the hall. Doors lead to the living room, bedroom and shower room.

## Living Room with Balcony

Spacious living room benefitting from a glazed patio door with a Juliette balcony. Feature fire surround and electric fire, TV and telephone points, Sky/Sky+ connection point. Two ceiling lights. Fitted carpets, raised electric power sockets. Partially glazed door leads into a separate kitchen.

## Kitchen

Fully fitted modern kitchen with tiled floor. Stainless steel sink with lever tap. Built-in oven, ceramic hob and extractor hood. Fitted integrated fridge/freezer and under pelmet lighting.

## Bedroom with Balcony

A generous double bedroom benefitting from a fitted mirrored wardrobe with sliding doors. Ceiling lights, TV and phone point.

## Shower Room

Fully tiled and fitted with suite comprising of level access shower. Low level WC, vanity unit with wash basin and mirror above. Shaving point, electric heater and extractor fan.

## Service Charge (Breakdown)

- Cleaning of communal windows
- Water rates for communal areas and apartments
- Electricity, heating, lighting and power to communal areas
- 24 hour emergency call system
- Upkeep of gardens and grounds
- Repairs and maintenance to the interior and exterior communal areas
- Contingency fund including internal and external redecoration of communal areas
- Buildings insurance

Service charge £2,795.65 per annum (for financial year ending 31/03/2027)

The Service Charge does not cover external costs such as your Council Tax, electricity or TV, but does include the cost of your House Manager, your water rates, our 24 hour emergency call

# 1 bed | £160,000

system, the heating and maintenance of all communal areas and all external window cleaning, exterior property maintenance and gardening. To find out more about service charges please contact your Property Consultant or House Manager.

## Leasehold

Leasehold 125 Years from 2013

Ground Rent £425 p.a

Ground rent review: 2028

## Car Parking Permit Scheme

Parking is by allocated space, subject to availability. The fee is usually £250 per annum, but may vary by development. Permits are available on a first come, first served basis. Please check with the House Manager on site for availability.

## Moving Services & Additional Information

Moving is a huge step, but don't let that hold you back. We have a range of services to help your move go smoothly, including:

- FREE Entitlements Advice to help you find out what benefits you may be entitled.
  - Part Exchange service to help you move without the hassle of having to sell your own home.
  - Removal Services that can help you declutter and move you in to your new home.
  - Conveyancing specialists who are experienced with sales and purchases of McCarthy Stone retirement properties.
- For more information check our webpage additional services or speak with our property consultant

- Full Fibre Broadband available
- Mains water and electricity
- Electric room heating
- Mains drainage

