

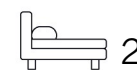

Living  
made  
better

New Providence Wharf  
Blackwall, E14 9PL



2



2



1



C

£2,850 PCM

# New Providence Wharf, Blackwall, E14 9PL

Madison Brook

## Property Summary

Situated on the sixth floor of the prestigious New Providence Wharf development, this beautifully presented two-bedroom apartment offers approximately 1,007 sq ft of well-proportioned living space. The property features an impressive reception and dining room, a private balcony overlooking London skyline, a contemporary kitchen, a principal bedroom benefits from a generous en-suite bathroom, while the second double bedroom is served by a separate family bathroom. Residents benefit from ample storage throughout, 24-hour concierge service, gym, swimming pool and security. Ideally located

Residents of New Providence Wharf benefit from outstanding on-site facilities including a 24-hour concierge service, gymnasium, swimming pool and security. Ideally located close to Canary Wharf.

## Floorplan

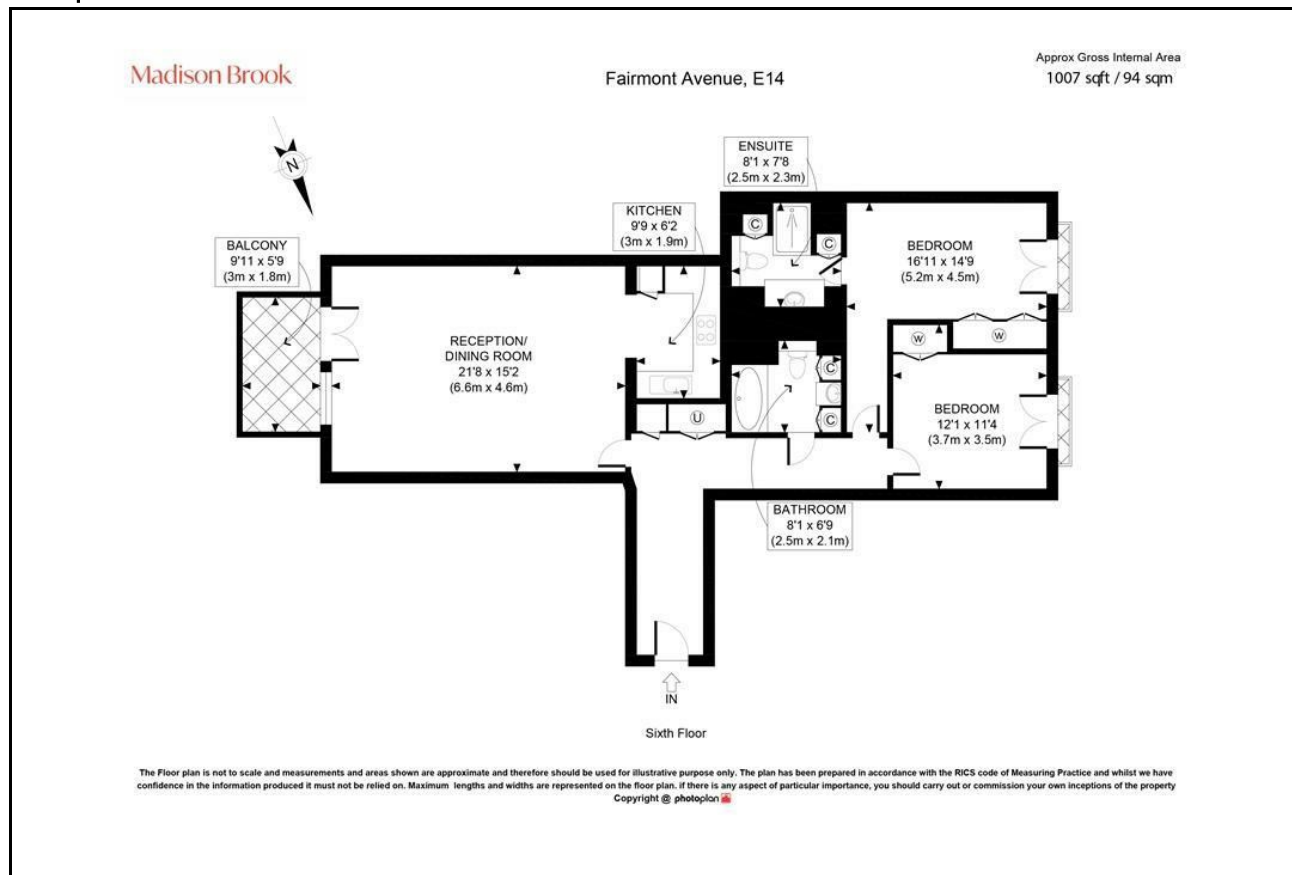

## Area Map

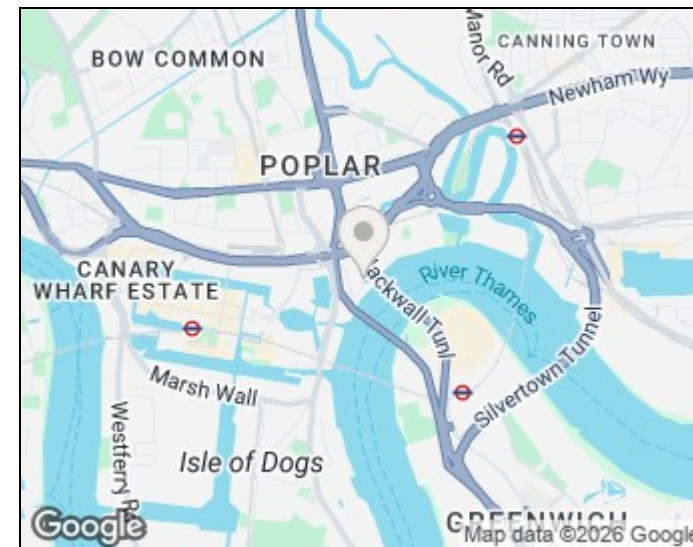

## Energy Efficiency Graph

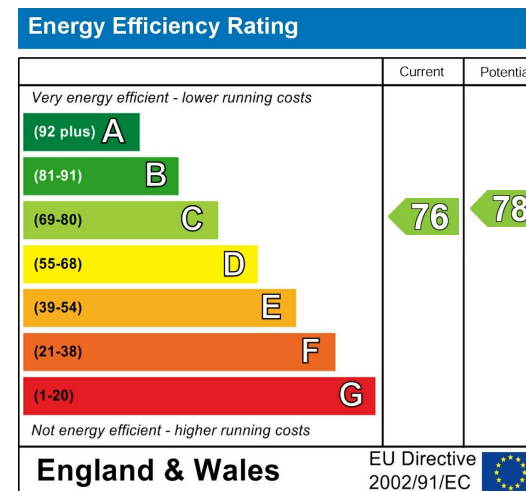

These particulars, whilst believed to be accurate are set out as a general outline only for guidance and do not constitute any part of an offer or contract. Intending purchasers should not rely on them as statements of representation of fact, but must satisfy themselves by inspection or otherwise as to their accuracy. No person in this firm's employment has the authority to make or give any representation or warranty in respect of the property.

Unit B 20 Western Gateway, Royal Victoria  
Dock, London, E16 1BS  
Tel: 020 3946 6000 Email:  
docklands@madisonbrook.com  
<https://madisonbrook.com/>