

PTN Estates

Residential Sales & Lettings



213 Waterfront West, , Brierley Hill, DY5 1LZ

£130,000

Attention landlords, available with current tenants in situ

- Stylish and modern Living set around the canal basin at Merry Hill, Dudley
- Impressive second floor apartment
- Two double bedrooms
- Superb combined Living and kitchen area
- Comprising of integral fridge/freezer/washing machine, electric oven and ceramic hob
- Splendid bathroom with shower over the bath
- Floor to ceiling UPVC double glazing
- Low tariff electric heating
- Delightful communal garden
- Lift and stairs available
- Intercom entrance
- allocated permit parking

All Uk agents are required by law to conduct anti-money laundering checks on all those buying a property. We use Landmark to conduct your checks once your offer has been accepted on a property you wish to buy. The cost of these checks is £25+VAT per buyer and this is a non-refundable fee. These charges cover the cost of obtaining relevant data, any manual checks and monitoring which might be required. This fee will need to be paid and the checks completed in advance of the office issuing a memorandum of sale on the property you would like to buy.

AI Disclaimer: Some images used in this listing may have been digitally enhanced or generated using AI-based tools for illustrative purposes. While every effort has been made to ensure accuracy, these images may not precisely reflect the current condition or appearance of the property. We recommend arranging a viewing to appreciate the property fully.

Important Information

All Uk agents are required by law to conduct anti-money laundering checks on all those buying a property. We use Landmark to conduct your checks once your offer has been accepted on a property you wish to buy. The cost of these checks is £25+VAT per buyer and this is a non-refundable fee. These charges cover the cost of obtaining relevant data, any manual checks and monitoring which might be required. This fee will need to be paid and the checks completed in advance of the office issuing a memorandum of sale on the property you would like to buy.

AI Disclaimer: Some images used in this listing may have been digitally enhanced or generated using AI-based tools for illustrative purposes. While every effort has been made to ensure accuracy, these images may not precisely reflect the current condition or appearance of the property. We recommend arranging a viewing to appreciate the property fully.

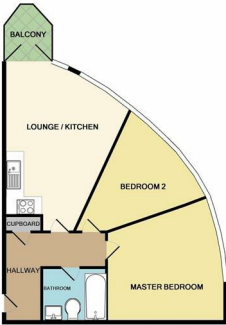
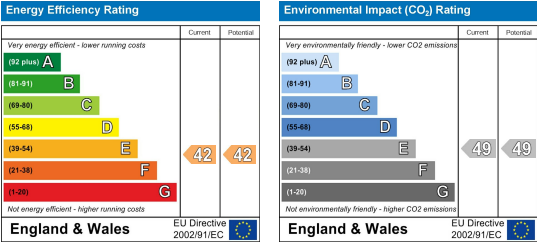

Made with Mapagis ©2018

Accuracy of Brochures

PTN Estates understands that these sales particulars have been prepared in accordance with the Property Misdescriptions Act 1991. However, please be advised we may not have obtained vendor approval and therefore any fixtures and fittings listed within these sales particulars may not be included in the sale. We would therefore advise any purchaser to refer to the fixtures and fittings form provided by their solicitor and would suggest any queries are raised with their solicitor prior to an exchange of contracts.

Services/Disclaimer

Please note that it is not company policy to test any services or appliances offered for sale and these should be verified by the purchasers. These details do not constitute any part of any offer or contract. All measurements and floorplans are approximate and for guidance purposes only. No responsibility is taken for any errors, omissions or misstatements. In addition, no statement in these details is to be relied upon as representations of fact and the purchaser should satisfy themselves by inspection or otherwise as to the accuracy of the statements contained in these details.

Transparency

We will always refer our purchasers and sellers to local reputable solicitors either Glover Priest, Barry Green, Stephenson's or Waldrons. It is your decision whether you choose to instruct them. Should you decide to use them, please be aware that we will receive a referral fee of between £60 & £75 for recommending you. We routinely instruct K Hadley to carry out the Energy Performance Certificate on your behalf. It is your decision whether you instruct us. In making that decision, you should be aware that we receive preferential rates allowing us to benefit by £35.25 per transaction.