



The Straight Mile, Hereford, HR2 6NR

Guide Price £155,000

🛏️ 2 🪑 1 🚗 1



- No Onward Chain
- Open Plan Living Space
- Convenient Location
- Designated Parking





FIRST FLOOR

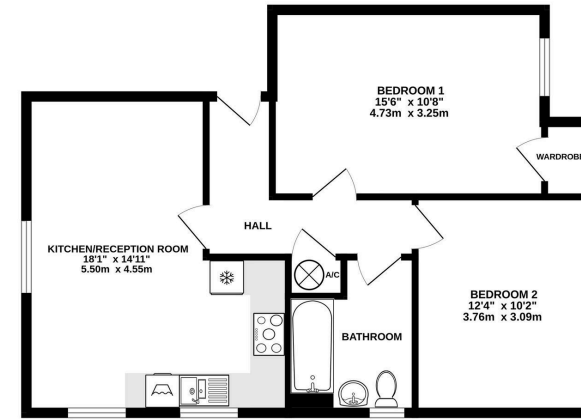

TOTAL FLOOR AREA: 663 sq ft (60.7 sq m) approx.
 While every effort has been made to ensure the accuracy of the European standard based measurements, all floor, wall, ceiling and area measurements are approximate and are not guaranteed to match any previous statement. The plans for this property are only for guidance and should not be used as a basis for any purchase or other transaction. The actual layout and dimensions may vary from those shown and are guaranteed as to their general accuracy only.

A Modern 2 Bedroom First Floor Apartment with Spacious Interiors, Designated Parking & Excellent Access to City Amenities, all offered with No Onward Chain.

