

# 18 Barley Hills

Bishop'S Stortford, Bishop's Stortford

Council Tax band: D

Tenure: Freehold

- Four bedroom home
- Private garden
- Driveway & Garage
- Side access
- Ground floor WC
- Close to Bishop's Stortford station & town centre



**Entrance porch**

**wc**

**Lounge / Diner**

12' 6" x 21' 4" (3.80m x 6.50m)

**Kitchen**

8' 8" x 9' 10" (2.64m x 2.99m)

**Bedroom**

10' 6" x 12' 9" (3.21m x 3.89m)

**Bedroom**

7' 11" x 8' 3" (2.41m x 2.51m)

**Bedroom**

7' 7" x 9' 9" (2.31m x 2.98m)

**Bedroom**

6' 9" x 8' 3" (2.05m x 2.51m)

**Bathroom**





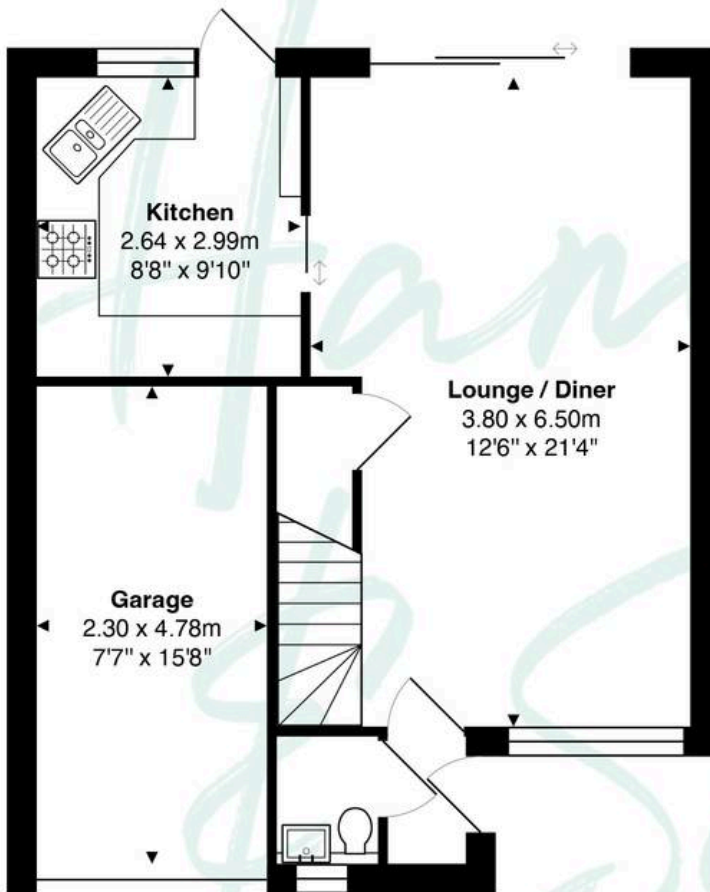

**Ground Floor**

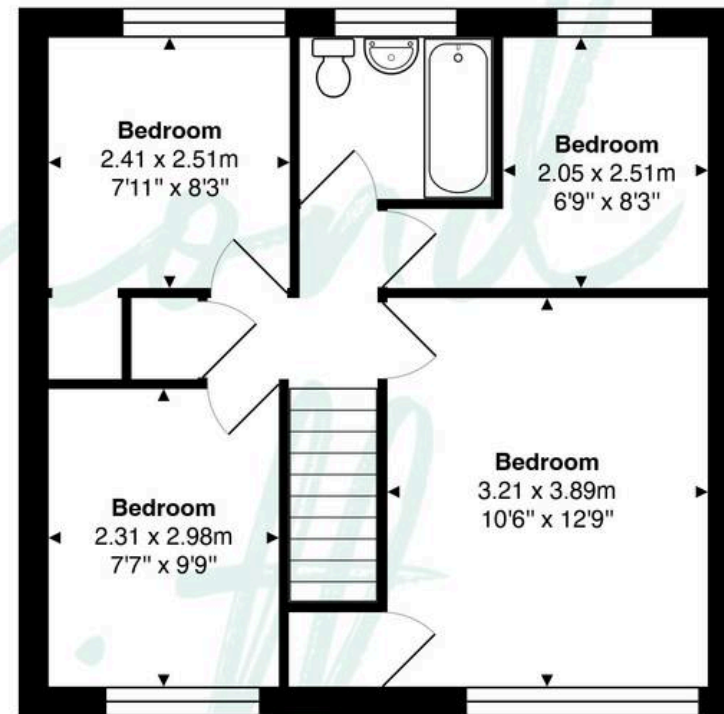

**First Floor**

Total Area: approx. 91.4 m<sup>2</sup> ... 983 ft<sup>2</sup>

THE FLOORPLAN IS FOR ILLUSTRATIVE PURPOSES ONLY AND IS NOT TO SCALE.  
 Measurements and features are approximate and may differ from the actual property. Verify all details independently; no liability is accepted for errors or omissions.

Property marketing provided by [www.fotomarketing.co.uk](http://www.fotomarketing.co.uk)