

The Old Workhouse

ST GEORGE

APPROXIMATE FLOOR AREA
46.6 SQM / 502 SQFT



FIRST FLOOR
502 sq.ft. (46.6 sq.m.) approx.

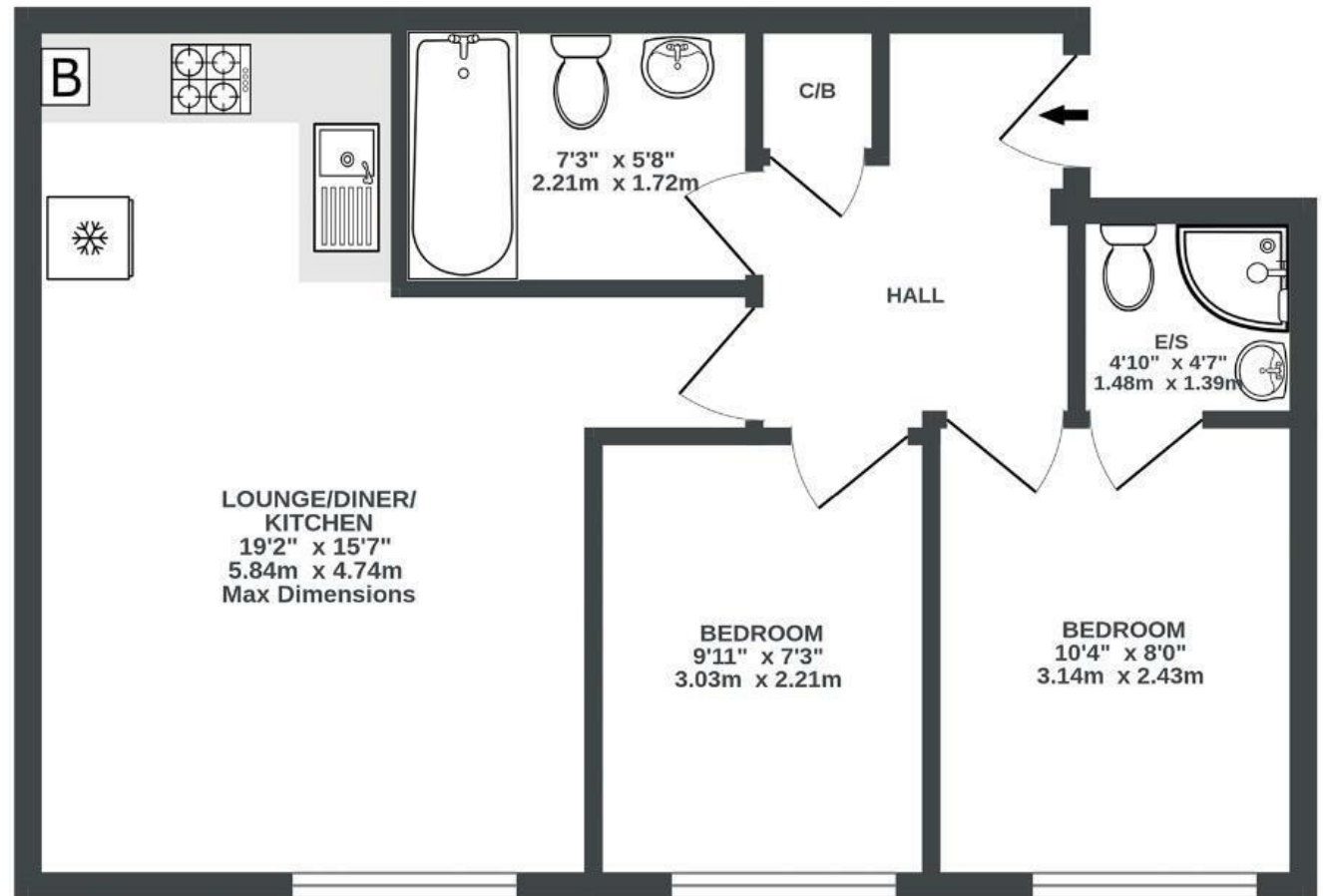

Illustrations are for reference purposes only, measurements are approximate, not to scale.

Boardwalk

Hudds Vale Road , BRISTOL

£

£240,000



BS5 7HE

zzz

2 Bedrooms



2 Bathrooms

"What sold the flat to me was its easy access to some of my favourite green spaces in Bristol. You can walk through St George's park, along Avonview Cemetery, past Strawberry Lane Community gardens, over Troopers Hill (with the best views of Bristol) into Conham River park and along the river Avon to Bath. A whole beautiful stretch of Green space right from the doorstep."

